

F.A.P. RTE.	SECTION	COUNTY	TOTAL SHEETS	SHEET NO
353	(12&13)WRS-3	WILL	1235	247
STA. 202+00	TO STA. 230+00			
FED. ROAD DIST. NO.	ILLINOIS	FED. AID PROJECT		

CONTRACT NO. 62479

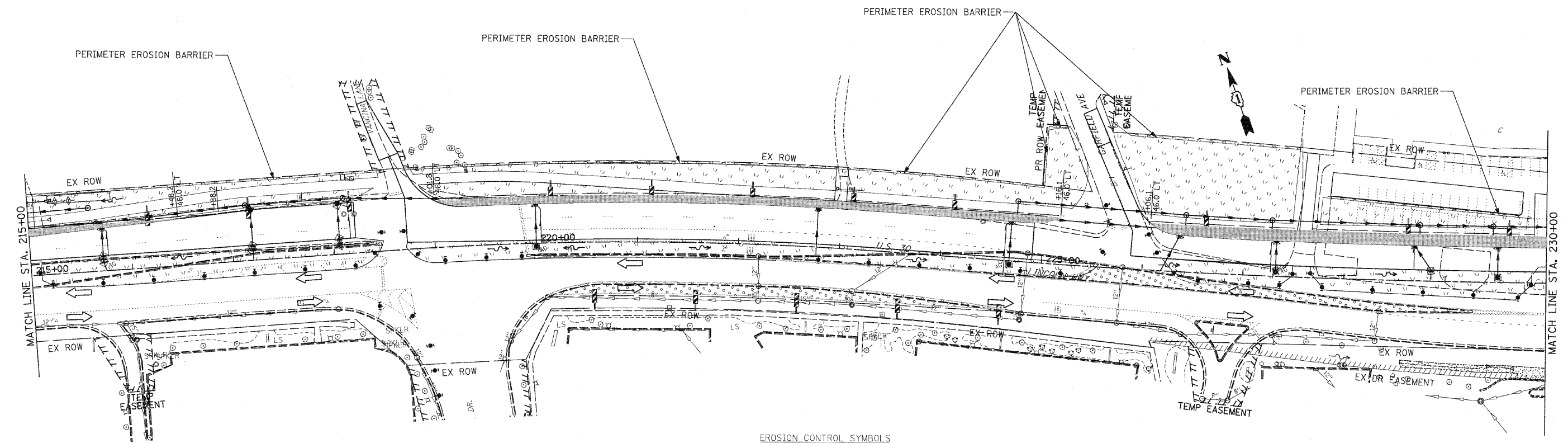
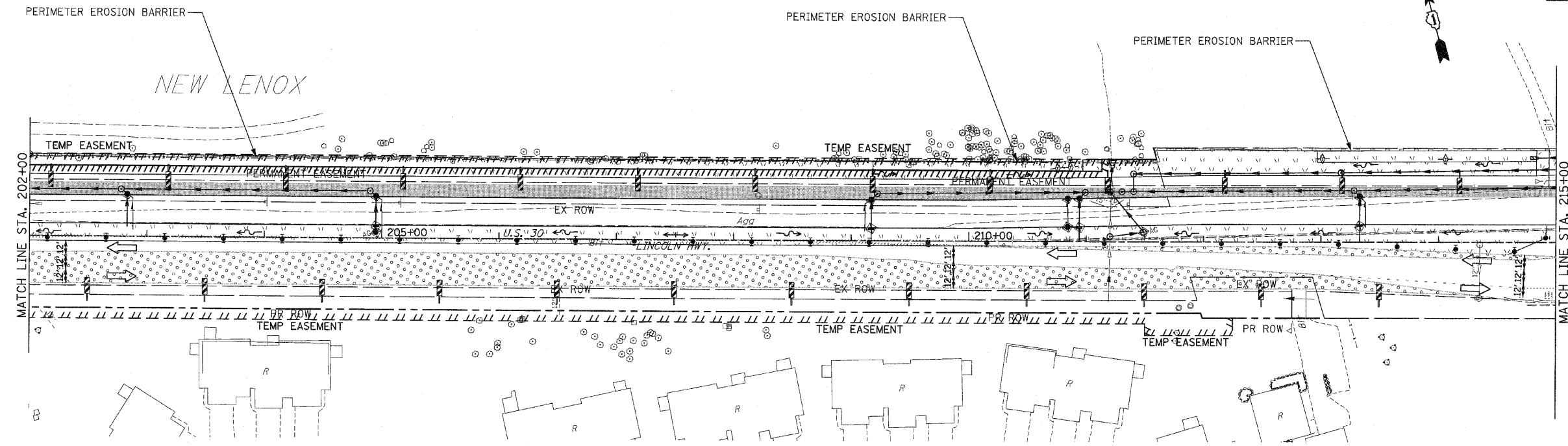

- EROSION CONTROL SYMBOLS**
- PERIMETER EROSION BARRIER
 - - - TEMPORARY FENCE
 - ◇ AG ABOVE GRADE INLET FILTER
 - ◇ INLET FILTER
 - ◇ TEMPORARY DITCH CHECK
 - ◇ RIPRAP
 - ▨ TEMPORARY SEEDING AND EROSION CONTROL BLANKET
 - ▨ CONSTRUCTION WORK ZONE
 - ▨ TEMPORARY PAVEMENT
 - ▨ TEMPORARY PAVEMENT CONSTRUCTED IN EARLIER STAGES

NOTES:

- DRAINAGE STRUCTURE INLET FILTERS ARE TO BE PROVIDED AND MAINTAINED FOR ALL INLETS, CATCH BASINS AND DRAINAGE STRUCTURES. PAY ITEMS AND SPECIAL PROVISIONS HAVE BEEN INCLUDED FOR THIS WORK.
- EROSION CONTROL BLANKET SHALL BE USED AT ALL LOCATIONS WHERE TEMPORARY SEEDING IS USED.

REVISIONS		ILLINOIS DEPARTMENT OF TRANSPORTATION
NAME	DATE	
		EROSION CONTROL PLANS STAGE 1 U.S. RTE. 30 (LINCOLN HIGHWAY) STA. 202+00 TO STA. 230+00 SCALE : 1" = 50' DATE : / /

DRAWN BY : BAE
CHECKED BY : GB