

TALL GRASS DR.

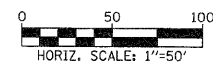

SEE FOLLOWING SHEET FOR ASSOCIATED DRAINAGE PROFILES.

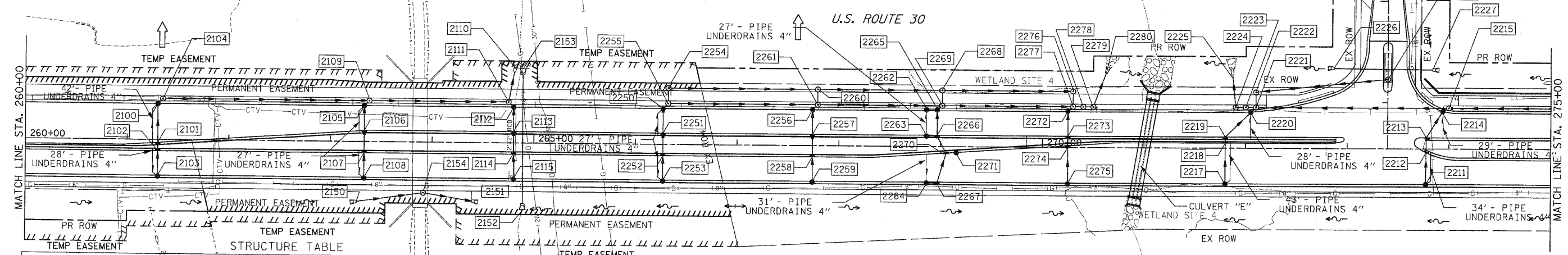

STR. #	STATION	OFFSET	STRUCTURE		RIM ELEV.	INVERT ELEVATION				UNDER DRAIN CONNECT.	STR TOP SLAB
			TYPE	FRAME		NORTH	EAST	SOUTH	WEST		
2100	261+30.00	-35.0	CB A4	24	703.77	696.85		696.85		YES	FLAT
2101	261+30.00	2.8	IN B	24	701.91	697.23		697.23			TAPERED
2102	261+30.00	11.0	IN B	24	702.19	697.31		697.31			TAPERED
2103	261+30.00	35.0	CB C	24	701.71	697.55				YES	FLAT
2104	261+35.00	-40.0	MH A4	1 CL	702.11		696.78	696.78			FLAT
2105	263+33.00	-35.0	CB A4	24	700.18	695.32		695.32		YES	FLAT
2106	263+33.00	-10.8	IN B	24	700.66	695.56		695.56			TAPERED
2107	263+33.00	11.0	IN B	24	700.66	695.78		695.78			TAPERED
2108	263+33.00	35.0	CB C	24	700.18	696.02				YES	FLAT
2109	263+38.00	-40.0	MH A4	1 CL	700.61		695.01	695.25	695.26		FLAT
2110	264+80.00	-67.4	FES 18		693.52			693.52			FLAT
2111	264+75.00	-40.0	MH A4	1 CL	699.98	693.73		694.57	693.98		TAPERED
2112	264+80.00	-35.0	CB A4	24	699.50	694.64		694.64			FLAT
2113	264+80.00	-11.0	IN B	24	699.98	694.88		694.88			TAPERED
2114	264+80.00	11.0	IN B	24	699.98	695.10		695.10			TAPERED
2115	264+80.00	35.0	CB C	24	699.50	695.34					TAPERED
2150	263+26.00	59.0	FES 24				696.80				
2151	264+39.00	57.3	FES 24						694.66		
2152	264+89.00	59.2	FES 30								
2153	264+89.00	-66.6	FES 30								
2154	263+91.00	50.0	MH A5	1 CL	699.80		694.90		696.14		FLAT
2250	266+27.00	-35.0	CB A4	24	698.82	694.35		694.35		YES	FLAT
2251	266+27.00	-11.0	IN B	24	699.30	694.45		694.45			TAPERED
2252	266+27.00	11.0	IN B	24	699.30	694.55		694.55			TAPERED
2253	266+27.00	35.0	CB C	24	698.82	694.66				YES	FLAT
2254	266+32.00	-55.0	MH A5	1 CL	698.88		693.57	695.41			FLAT
2255	266+32.00	-40.0	MH A4	1 CL	699.25	695.56		694.31	694.31		FLAT
2256	267+74.00	-35.0	CB A4	24	698.14	693.80		693.80			FLAT
2257	267+74.00	-11.0	IN B	24	698.62	693.90		693.90			TAPERED
2258	267+74.00	11.0	IN B	24	698.62	694.00		694.00			TAPERED
2259	267+74.00	35.0	CB C	24	698.14	694.11					TAPERED
2260	267+79.00	-55.0	MH A5	1 CL	698.19		693.35	695.11	693.35		FLAT
2261	267+79.00	-40.0	MH A4	1 CL	698.57	695.26		693.76	693.76		FLAT
2262	268+86.00	-35.0	CB C	24	697.74		693.58		693.84		FLAT
2263	268+86.00	-11.0	CB C	24	698.22		693.83				FLAT
2264	268+86.00	35.0	CB C	24	697.74		693.78			YES	FLAT
2265	268+96.50	-35.0	CB A4	24	697.73	693.40		693.40	693.53		FLAT
2266	268+96.50	-11.0	IN B	24	698.21	693.51		693.51	693.78		TAPERED
2267	268+96.50	35.0	IN B	24	697.73	693.73			693.73		TAPERED
2268	269+01.50	-55.0	MH A5	1 CL	697.77		693.17	694.72	693.17		FLAT
2269	269+01.50	-40.0	MH A4	1 CL	698.18	694.87		693.37	693.37		FLAT
2270	269+05.42	7.3	IN B	24	698.15	693.60		693.88	693.60		TAPERED
2271	269+15.40	6.6	CB C	24	698.13				693.93		
2272	270+25.00	-35.0	CB A4	24	698.31	693.25		693.25			FLAT
2273	270+25.00	-11.0	IN B	24	698.79	693.37		693.37			TAPERED
2274	270+25.00	-9.7	IN B	24	698.56	693.42		693.42			TAPERED
2275	270+25.00	35.0	CB C	24	698.31	693.60					
2276	270+30.00	-50.0	MH A5	1 OL	698.39		692.97	692.97			FLAT
2277	270+30.00	-40.0	MH A4	1 CL	698.80	692.96		692.96	692.96		FLAT
2278	270+40.00	-40.0	RMH	2-1 CL	698.90		692.93		692.93		FLAT
2279	270+50.00	-40.0	MH A4	1 CL	699.00	692.90					FLAT
2280	270+62.50	-73.2	FES 21								
2211	273+78.00	35.0	CB C	24	705.78	701.31			692.84		
2212	273+78.00	3.7	IN B	24	706.11	701.15					
2213	273+78.00	-11.0	IN B	24	706.26	701.08			701.15		YES
2214	274+10.00	-35.0	CB A4	24	706.84	700.88			701.08		TAPERED
2215	274+05.00	-40.0	MH A4	1 CL	707.06		702.52	700.84			TAPERED
2216	273+39.80	-68.2	MH A5	1 CL	704.18			700.84			TAPERED
2217	271+80.00	35.0	CB C	24	700.52	696.36			694.08		TAPERED
2218	271+80.00	-5.0	IN B	11V	700.68	696.16		696.16			TAPERED
2219	271+80.00	-11.0	IN B	24	701.00	696.13		696.13		YES	TAPERED
2220	272+05.00	-35.0	CB A4	24	701.04	695.96		695.96			TAPERED
2221	272+10.00	-40.0	MH A4	1 CL	701.60	693.93		696.94	693.94		TAPERED
2222	272+10.00	-55.0	MH A5	1 OL	701.14		693.95	693.95			TAPERED
2223	272+00.00	-40.0	RMH	2-1 CL	701.38		693.84		693.84		FLAT
2224	271+90.00	-40.0	MH A4	1 CL	701.17	693.74		693.74			FLAT
2225	271+87.10	-71.8	FES 21		693.00						TAPERED
2226	272+87.00	-79.0	FES 24								
2227	273+84.00	-77.8	FES 24								

STRUCTURE	INVERT	SLOPE	STORM SEWER		TRENCH
			LENGTH (1)	LENGTH (2)	
U. S. D. S.	U. S. D. S.	(FT/FT)			BACKFILL (CU YD)
2103	2102	697.55	697.31	0.0100	1 24 12 3.2
2102	2101	697.31	697.23	0.0100	1 8 12 1.3
2101	2100	697.23	696.85	0.0100	1 38 12 1.3
2100	2104	696.85	696.78	0.0100	1 7 12 1.5
2104	2109	696.78	695.26	0.0075	1 203 12 47.9
2108	2107	696.02	695.78	0.0100	1 24 12 3.6
2107	2106	695.78	695.56	0.0100	1 22 12 0.0
2106	2105	695.56	695.32	0.0100	1 24 12 5.2
2105	2109	695.32	695.25	0.0100	1 7 12 1.5
2109	2111	695.01	693.98	0.0075	1 137 15 41.8
2115	2114	695.34	695.10	0.0100	2 24 12 3.6
2114	2113	695.10	694.88	0.0100	2 22 12 3.2
2113	2112	694.88	694.64	0.0100	2 24 12 5.2
2112	2111	694.64	694.57	0.0100	1 7 12 1.5
2111	2110	693.73	693.52	0.0075	1 28 18 2.7
2150	2154	696.80	696.14	0.0100	1 66 24 0.0
2154	2151	694.90	694.66	0.0050	1 49 24 0.0
2250	2255	694.35	694.31	0.0045	2 7 12 1.2
2255	2261	694.31	693.84	0.0032	2 147 15 27.9
2259	2258	694.11	694.00	0.0045	2 24 12 3.2
2258	2257	694.00	693.90	0.0045	2 22 12 0.0
2257	2256	693.90	693.80	0.0045	2 24 12 3.6
2256	2261	693.80	693.76	0.0045	2 7 12 1.1
2261	2269	693.76	693.37	0.0032	2 123 18 50.0
2264	2267	693.73	693.73	0.0045	1 11 12 1.4
2267	2270	693.73	693.60	0.0045	1 29 12 3.8
2271	2270	693.93	693.88	0.0050	2 10 12 1.3
2270	2266	693.83	693.51	0.0045	2 20 12 0.0
2263	2266	693.83	693.78	0.0050	2 11 12 1.6
2266	2266	693.51	693.40	0.0045	2 24 12 3.6
2262	2265	693.58	693.53	0.0050	2 7 12 1.4
2265	2269	693.40	693.37	0.0045	2 7 12 1.1
2269	2277	693.37	692.96	0.0032	2 129 18 29.7
2275	2274	693.60	693.42	0.0050	2 36 12 6.9
2274	2273	693.42	693.37	0.0050	2 10 12 2.4
2273	2272	693.37	693.25	0.0050	2 7 12 5.7
2272	2277	693.25	693.21	0.0050	2 7 12 1.7
2277	2278	692.96	692.93	0.0032	2 10 18 3.1
2278	2279	692.93	692.90	0.0032	2 10 18 3.3
2279	2280	692.90	692.84	0.0017	1 32 21 0.0
2254	2260	693.57	693.35	0.0015	1 147 24 56.3
2260	2268	693.35	693.17	0.0015	1 123 24 43.2
2268	2276	693.17	692.97	0.0015	1 129 24 49.3
2276	2277	692.97	692.96	0.0015	2 10 24 6.8
2255	2254	695.56	695.41	0.0100	1 15 12 3.5
2261	2260	695.26	695.11	0.0100	1 15 12 2.6
2269	2268	694.87	694.72	0.0100	1 15 12 2.6
2210	2215	706.88	702.52	0.0200	2 218 15 177.2
2211	2212	701.31	701.15	0.0050	2 31 12 5.4
2212	2213	701.15	701.08	0.0050	2 15 12 0.0
2213	2214	701.08	700.88	0.0050	2 40 12 11.1
2214	2215	700.88	700.84	0.0050	2 7 12 2.3
2215	2221	700.84	696.94	0.0200	2 195 15 50.5
2217	2218	696.36	696.16	0.0050	2 40 12 5.3
2218	2219	696.16	696.13	0.0050	2 6 12 1.0
2219	2220	696.13	695.96	0.0050	2 35 12 7.5
2220	2221	695.96	695.92	0.0050	2 7 12 1.8
2221	2223	693.94	693.84	0.0100	2 10 18 7.6
2223	2224	693.84	693.74	0.0100	2 10 18 7.6
2224	2225	693.74	693.69	0.0017	2 32 21 0.0
2216	2222	694.08	693.95	0.0010	2 130 27 0.0
2222	2221	693.95	693.93	0.0010	2 15 27 17.2