

F.A.P. RTE.	SECTION	COUNTY	TOTAL SHEETS	SHEET NO
353	(12&13)WRS-3	WILL	1235	405
STA.	TO STA.			
FED. ROAD DIST. NO.	ILLINOIS	FED. AID PROJECT		
CONTRACT NO. 62479				

PROP. CURVE CLUS30-3  
 PI STA. = 233+09.46  
 $\Delta = 11^\circ 25' 52''$  (LT)  
 $D = 0^\circ 41' 55''$   
 $R = 8,200.00'$   
 $T = 820.72'$   
 $L = 1,635.98'$   
 $E = 40.97'$   
 P.C. STA = 224+88.74  
 P.T. STA = 241+24.73

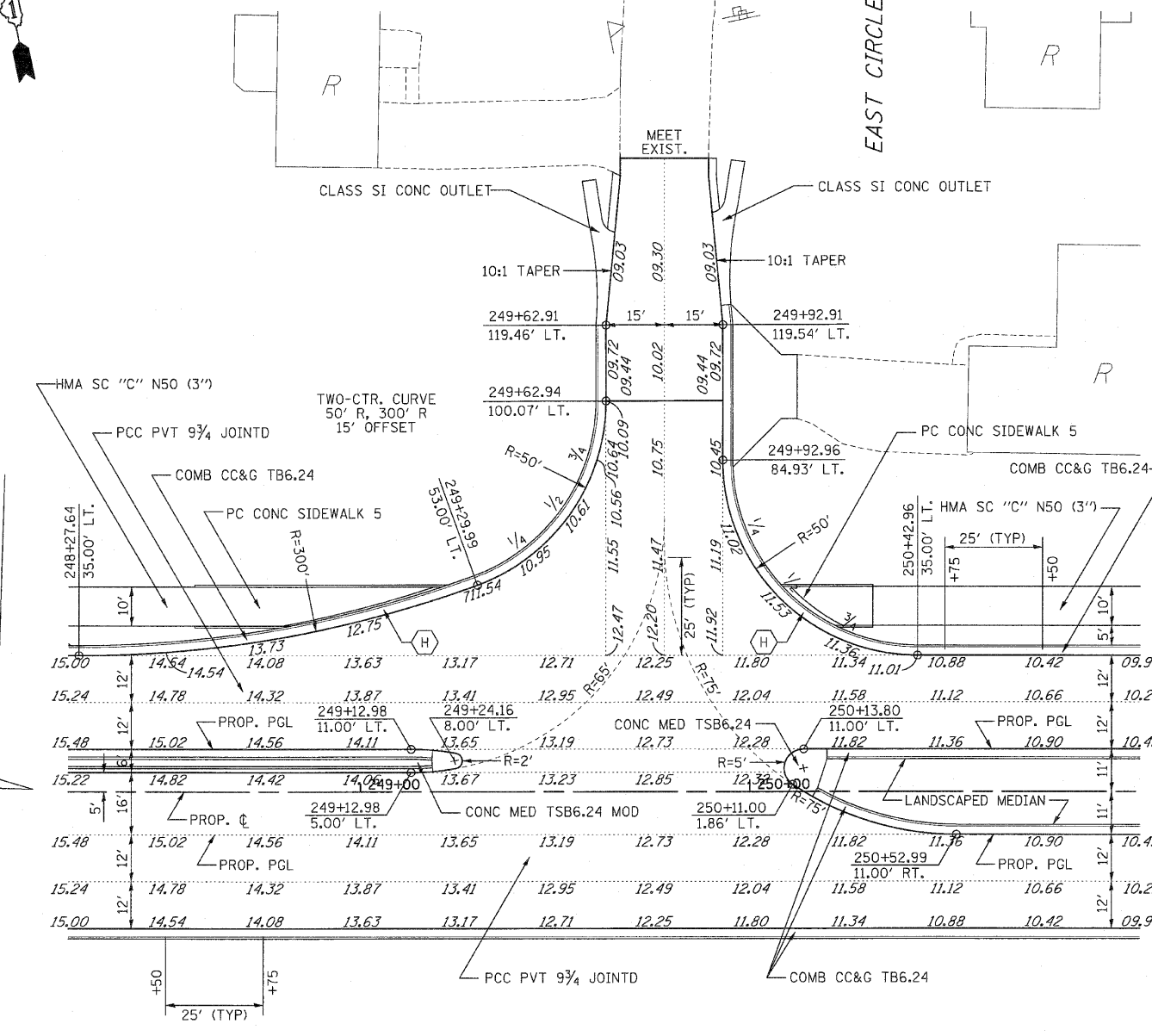
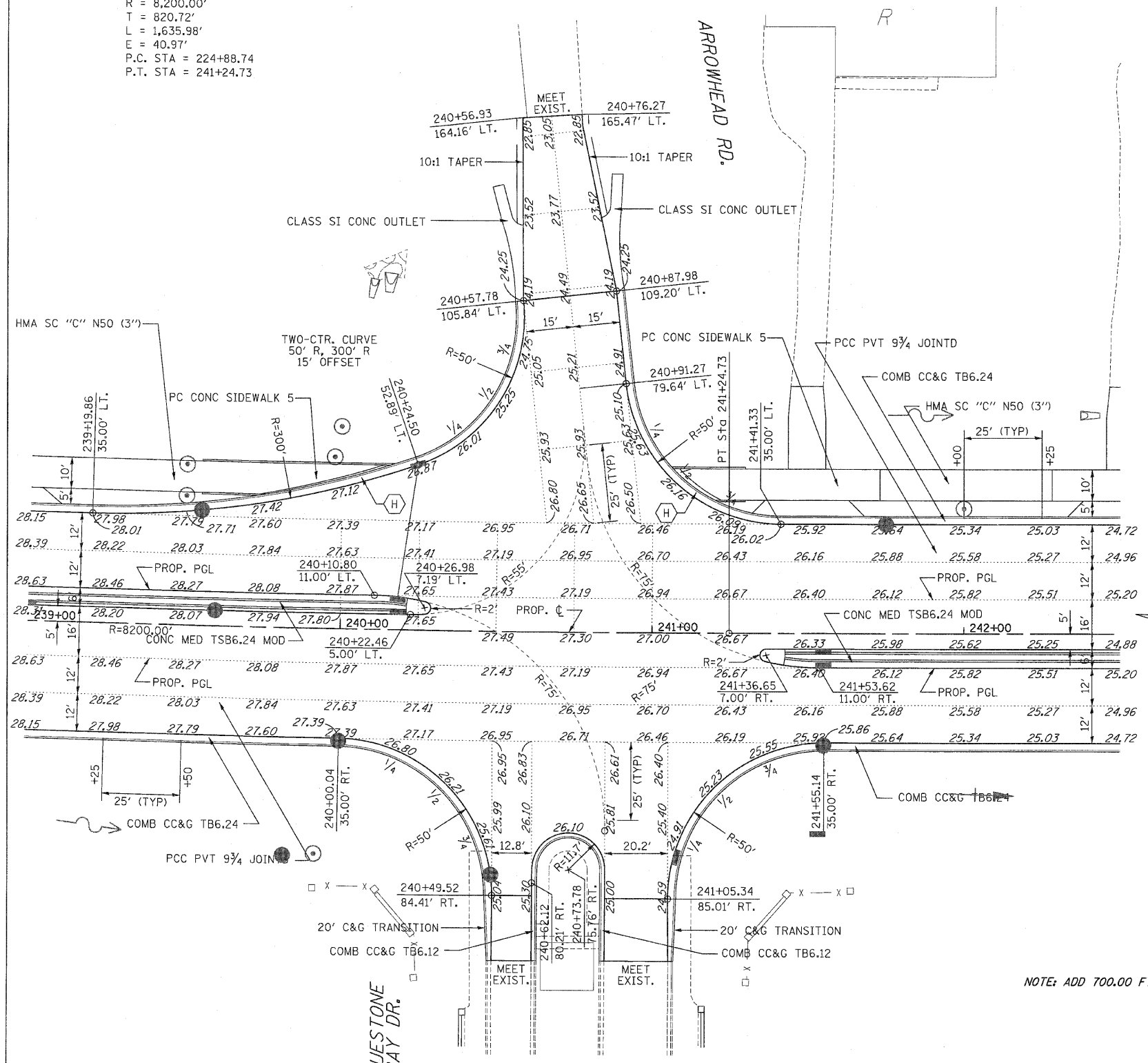

NOTE: ADD 700.00 FT. TO ELEVATIONS SHOWN.

- NOTES:
- SEE DISTRICT ONE STANDARD DETAILS (BD 01) AND (BD 02) FOR DRIVEWAY CONSTRUCTION DETAILS. SEE PLAN AND PROFILES FOR DRIVEWAY LOCATIONS AND DIMENSIONS.
  - SEE STATE STANDARD 424001-02 FOR SIDEWALK RAMPS ACCESSIBLE TO THE DISABLED, MARKED AS (H) ON THESE SHEETS. SEE PAVEMENT MARKING PLANS FOR LOCATION VERIFICATION.

REVISIONS		ILLINOIS DEPARTMENT OF TRANSPORTATION
NAME	DATE	
		<b>INTERSECTION DETAILS</b> U.S. RTE. 30 (LINCOLN HIGHWAY) & ARROWHEAD RD. / E. CRICLE DR.

SCALE: 1" = 20'  
 DATE: / /  
 DRAWN BY: \_\_\_\_\_  
 CHECKED BY: \_\_\_\_\_