

| | | | | |
|---------------------|--------------|------------------|--------------|-----------|
| F.A.P. RTE. | SECTION | COUNTY | TOTAL SHEETS | SHEET NO. |
| 353 | (12&13)WRS-3 | WILL | 1235 | 447 |
| STA. | TO STA. | | | |
| | | | | |
| FED. ROAD DIST. NO. | MILEAGE | FED. AID PROJECT | | |
| | | | | |

CONTRACT NO. 62479

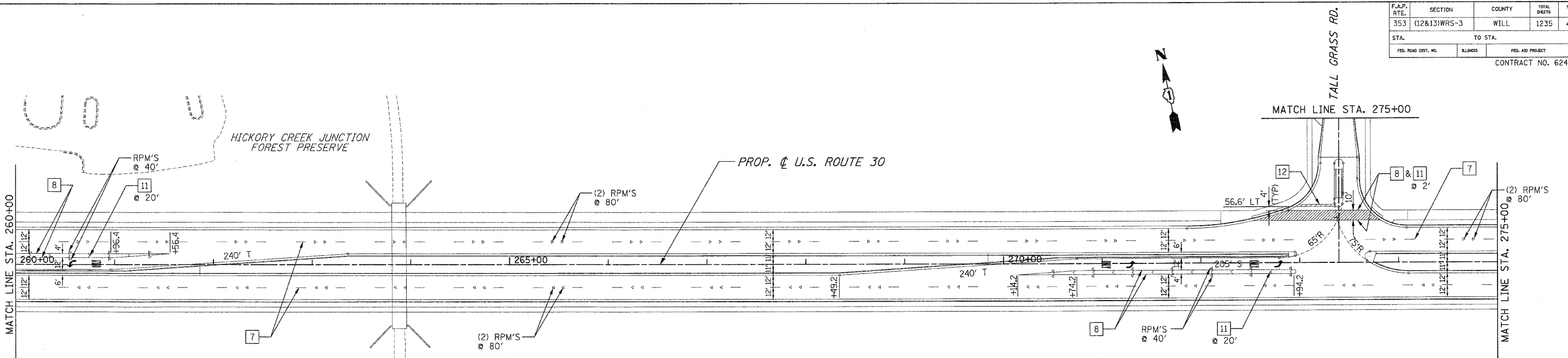

PAVEMENT MARKING KEY

| | | | | | |
|--------|---|-----------------------|-------|----|-----------------------|
| YELLOW | 1 | 4" DOUBLE @ 11" C-C | WHITE | 6 | 4" SOLID |
| | 3 | 4" SOLID | | 7 | 4"- 30' SKIP/10' DASH |
| | 4 | 4"- 30' SKIP/10' DASH | | 8 | 6" SOLID |
| | 5 | 12" DIAGONALS @ 45° | | 9 | 6"- 6' SKIP/2' DASH |
| | | | | 10 | 8" SOLID |
| | | | | 11 | 12" SOLID @ 45° |
| | | | | 12 | 24" STOP BAR |

PAVEMENT MARKING LEGEND

- ◀ LETTERS AND SYMBOLS
- STOP LINE, 24" WHITE
- ▶ RAISED PAVEMENT MARKER (RPM), ONE-WAY CRYSTAL
- ▶ RAISED PAVEMENT MARKER (RPM), ONE-WAY AMBER
- ◆ RAISED PAVEMENT MARKER (RPM), TWO-WAY AMBER
- 240' T LENGTH OF TAPER
- 205' S LENGTH OF STORAGE

PAVEMENT MARKING NOTES

1. THERMOPLASTIC PAVEMENT MARKINGS SHALL BE APPLIED ON BITUMINOUS PAVEMENT.
2. POLYUREA PAVEMENT MARKINGS SHALL BE APPLIED ON P.C. CONCRETE PAVEMENT.
3. PAVEMENT MARKINGS AND RAISED PAVEMENT MARKERS SHALL BE PER DISTRICT ONE PAVEMENT MARKING AND RAISED PAVEMENT MARKERS DETAIL.
4. TWO WEEKS PRIOR TO PLACING PERMANENT PAVEMENT MARKINGS CONTACT LAWRENCE HILL, IDOT'S AREA TRAFFIC FIELD ENGINEER AT (815)485-6475.

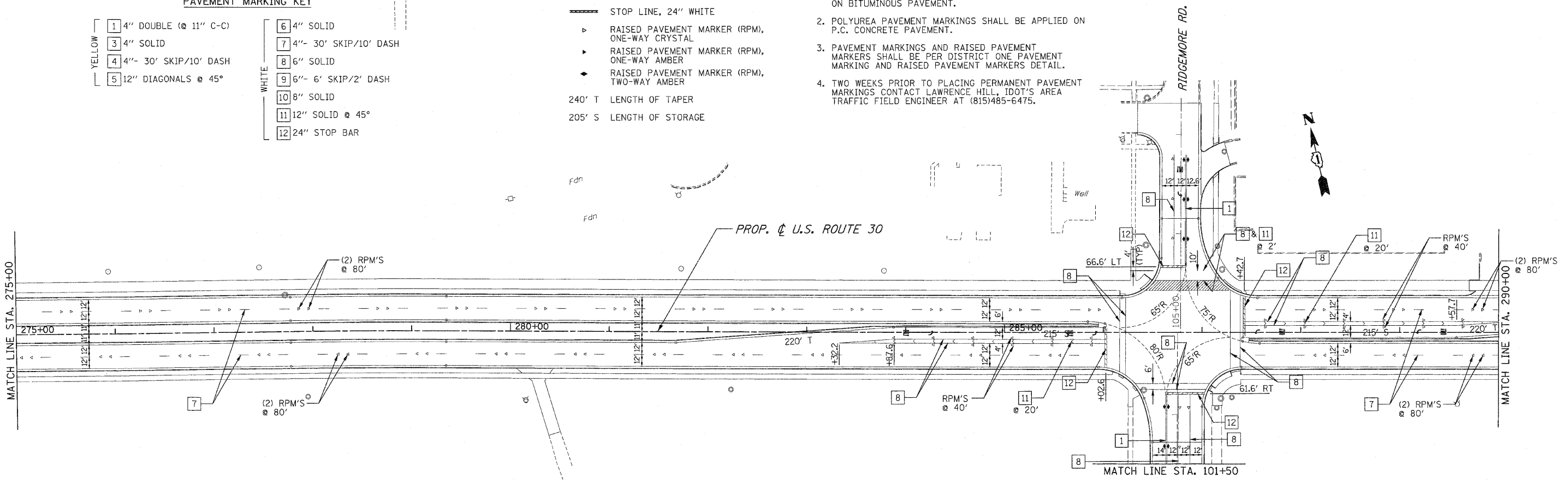

| REVISIONS | |
|-----------|------|
| NAME | DATE |
| | |
| | |
| | |
| | |
| | |

ILLINOIS DEPARTMENT OF TRANSPORTATION
PAVEMENT MARKING PLANS
 U.S. RTE. 30 (LINCOLN HIGHWAY)
 STA. 260+00 TO STA. 290+00
 SCALE : 1" = 50'
 DATE : 10/12/2010
 DRAWN BY : BAE
 CHECKED BY : GB