

F.A.P. RTE.	SECTION	COUNTY	TOTAL SHEETS	SHEET NO.
353	(12&13)WRS-3	WILL	1235	495
STA.	TO STA.			
FED. ROAD DIST. NO.	ILLINOIS	FED. AID PROJECT		

CONTRACT NO. 62479

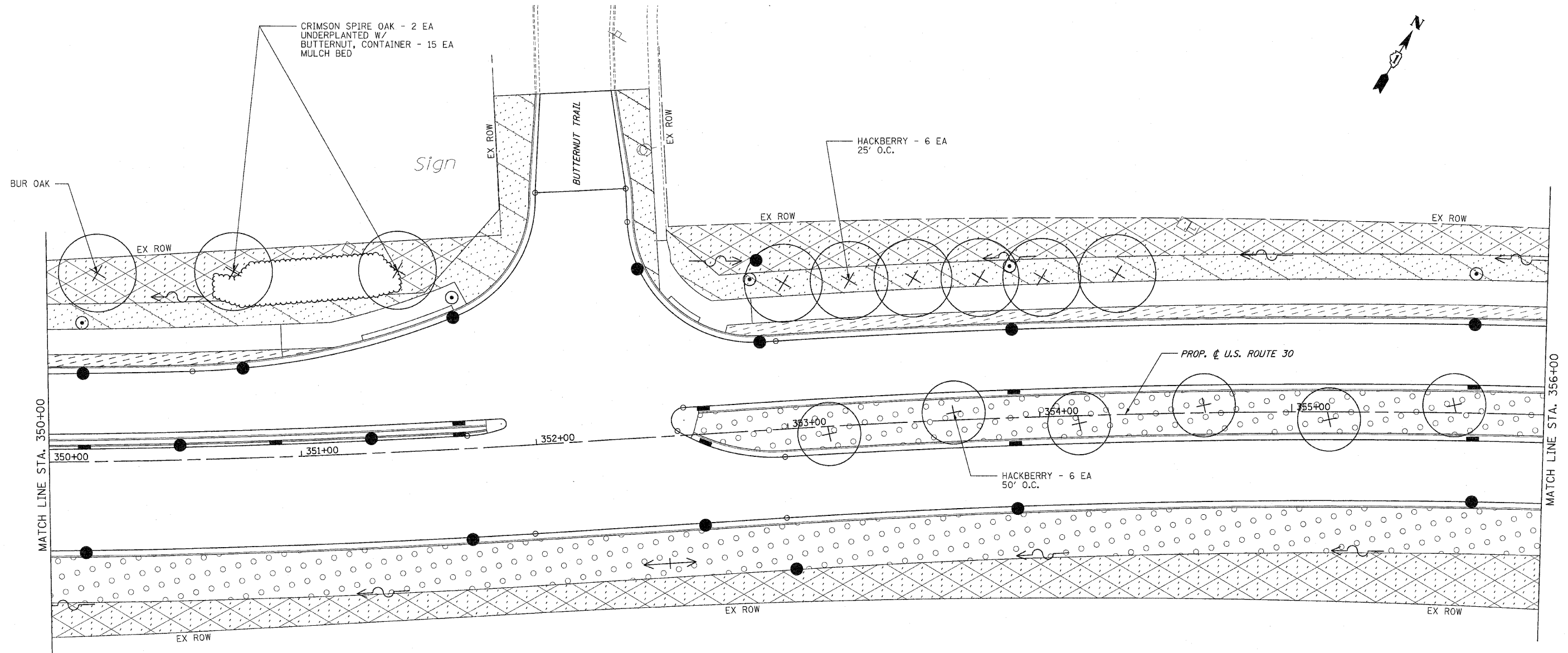

LEGEND	
	SODDING, SALT TOLERANT
	SEEDING, CLASS 2A
	SEEDING, CLASS 4 & 5A COMBINED
	SEEDING, CLASS 4
	SEEDING, CLASS 1
	PERENNIAL PLANTS
	STONE RIPRAP, CLASS AS SPECIFIED
	SEEDING, CLASS 4B (MODIFIED) WETLAND MIX
	EXISTING SODDING
	EXISTING SEEDING, CLASS 4

- LANDSCAPING GENERAL NOTES**
1. TOPSOIL FURNISH AND PLACE, 8" SHALL BE USED IN PARKWAYS (WITH AND WITHOUT SIDEWALKS) ALONG U.S. 30 TO FACILITATE PROPOSED STREET TREE PLANTING. THIS AREA IS BETWEEN THE BACK OF CURB AND THE SIDEWALK (OR CENTERLINE OF THE DITCH) OR GENERALLY WITHIN 20' OF THE CURB.
 2. TOPSOIL FURNISH AND PLACE, 24" SHALL BE USED IN ALL LANDSCAPED MEDIANS GREATER THAN 6' IN WIDTH.
 3. COMPOST FURNISH AND PLACE, 4" SHALL BE USED WITH SEEDING CLASS 4 AND CLASS 5A.
 4. TOPSOIL FURNISH AND PLACE, 4" SHALL BE USED AT ALL OTHER LOCATIONS NOT COVERED BY NOTES 1, 2, & 3.
 5. SEE SHEET 509A FOR SCHEDULE OF PERENNIAL PLANTS WHEN PLANTS ARE NOT LISTED WITH THE CALLOUT.

REVISIONS		ILLINOIS DEPARTMENT OF TRANSPORTATION
NAME	DATE	
		LANDSCAPING PLANS U.S. RTE. 30 (LINCOLN HIGHWAY) STA. 350+00 TO STA. 356+00 SCALE : 1" = 20' DRAWN BY : BAE DATE : 10/12/2010 CHECKED BY : GB