

F.A.P. RTE.	SECTION	COUNTY	TOTAL SHEETS	SHEET NO.
353	(12&13)WRS-3	WILL	1235	590
STA.	TO STA.			
FED. ROAD DIST. NO.	ILLINOIS	FED. AID PROJECT		

CONTRACT NO. 62479

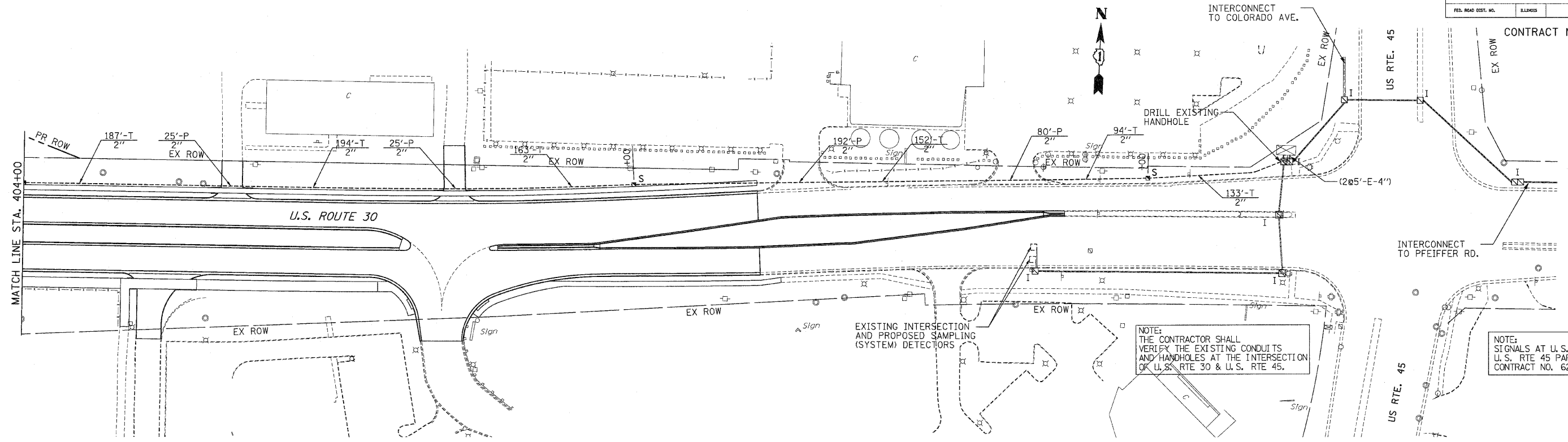

NOTE:
THE CONTRACTOR SHALL
VERIFY THE EXISTING CONDUITS
AND HANDHOLES AT THE INTERSECTION
OF U.S. RTE 30 & U.S. RTE 45.

NOTE:
SIGNALS AT U.S. RTE 30 &
U.S. RTE 45 PART OF IDOT
CONTRACT NO. 62478

NOTE:
THE TRAFFIC SIGNAL CONTROLLER
EQUIPMENT FOR THIS PROJECT SHALL
BE "ECONOLITE" TO MATCH THE
EXISTING ADJACENT SYSTEM.

REVISIONS	
NAME	DATE

ILLINOIS DEPARTMENT OF TRANSPORTATION
TRAFFIC SIGNAL INTERCONNECT
U.S. RTE. 30 (LINCOLN HIGHWAY)

STA. 404+00 TO STA. 419+00
DRAWN BY : RG
SCALE : 1" = 50'
DATE : 10/12/2010
DESIGNED BY : ZH
CHECKED BY : ZH