

BENCH MARK: BM 219  
 STA. 237+09.69, 41.96' RT, ELEV. 732.20  
 FOUND RAILROAD SPIKE IN SOUTH FACE OF  
 FIRST POWER POLE WEST OF BLUESTONE  
 BAY DRIVE, SOUTH SIDE OF ROUTE 30.

STATE OF ILLINOIS  
 DEPARTMENT OF TRANSPORTATION

ROUTE NO.	SECTION	COUNTY	TOTAL SHEETS	SHEET NO.
FAP 353	12	WILL.	1235	738
FED. ROAD DIST.		ILLINOIS	FED. AID PROJECT	

SHEET NO. 1  
 8 SHEETS

EXISTING STRUCTURE: NONE

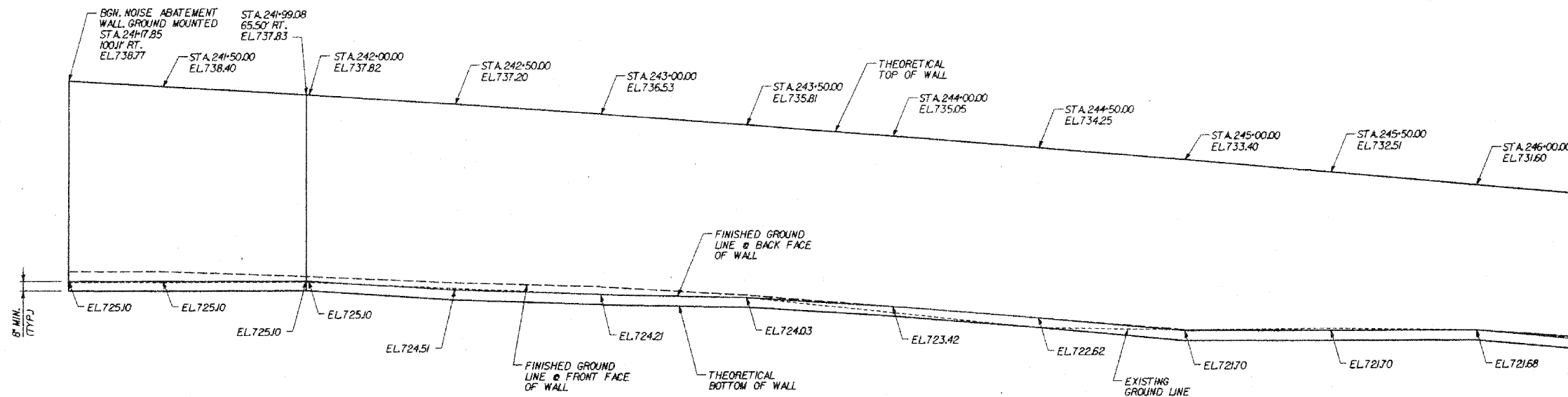

MATCH LINE STA. 246+34

**DESIGN SPECIFICATIONS**  
 AASHTO 2002 SPECIFICATIONS

**TOTAL BILL OF MATERIALS**

ITEM	UNIT	QUANTITY
NOISE ABATEMENT WALL, GROUND MOUNTED	SO. FT.	1,972

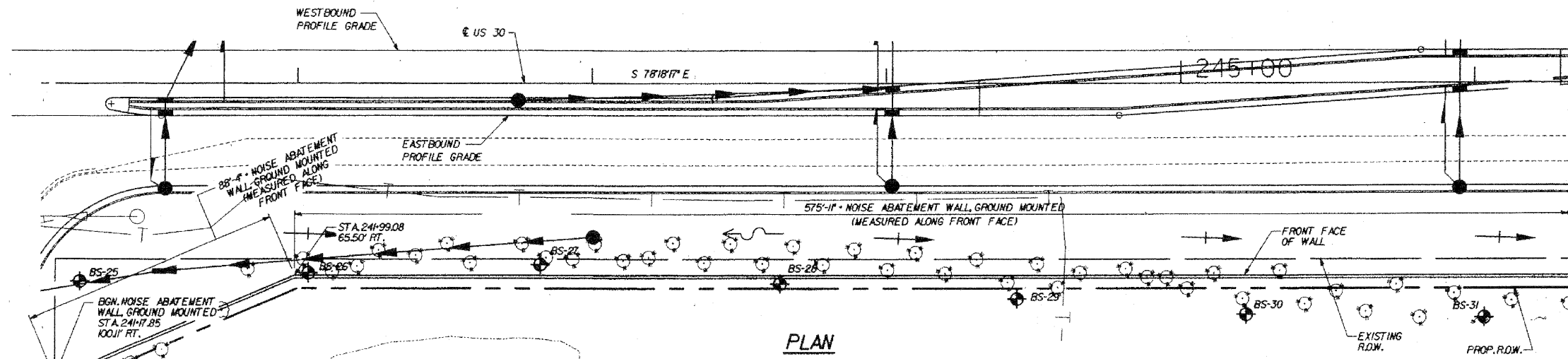

Wayne A. Triel  
 Affian 11-30-10

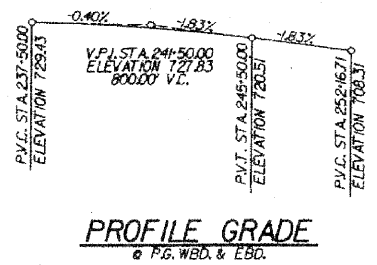
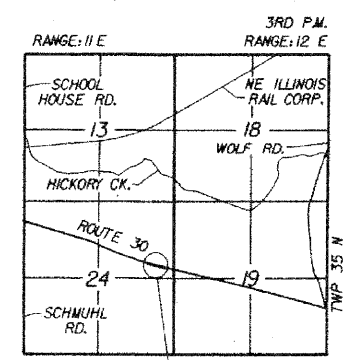

NOTE:  
 STATIONS & OFFSETS ARE FROM E US 30 TO FRONT FACE OF WALL.

**DLZ** 85 W. Algonquin Rd. Ste. 220  
 Arlington Heights IL 60005  
 DLZ Group, Inc.

**NOISE WALL B  
 PLAN & ELEVATION**  
 U.S. ROUTE 30 (LINCOLN HIGHWAY)  
 F.A.P. 353 (U.S. 30)  
 SECTION (12 & 13) WRS-3  
 STATION 241+7.85 TO 250+69.08  
 WILL COUNTY

REVISIONS	
NAME	DATE

DESIGNED	ASP
CHECKED	WSP
DRAWN	BGC
CHECKED	WSP