

BENCH MARK: BM 226
 STA. 287+87.64, 25.4' RT., ELEV. 710.68
 SET 3/4" DIAMETER IRON ROD AT THE EDGE
 OF SOUTHERLY STONE SHOULDER OF ROUTE
 30, +/- 100' EAST OF CENTERLINE OF 116TH AVENUE.

STATE OF ILLINOIS
 DEPARTMENT OF TRANSPORTATION

ROUTE NO.	SECTION	COUNTY	TOTAL SHEETS	SHEET NO.
FAP 353	*	WILL	1235	747
FED. ROAD DIST.		ILLINOIS	FED. AID PROJECT	

* SECT. 12 & 13) WRS-3
 * CONTRACT NO. 62479

SHEET NO. 2
 10 SHEETS

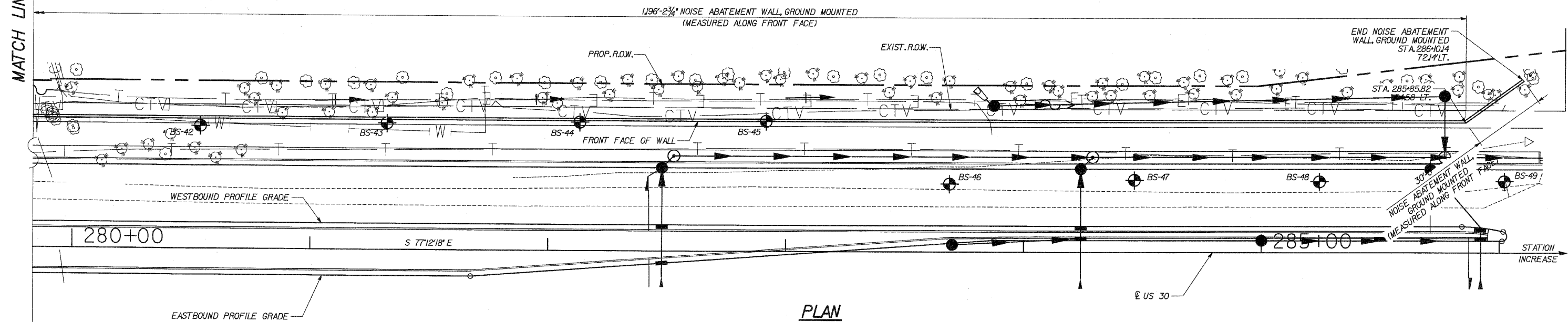
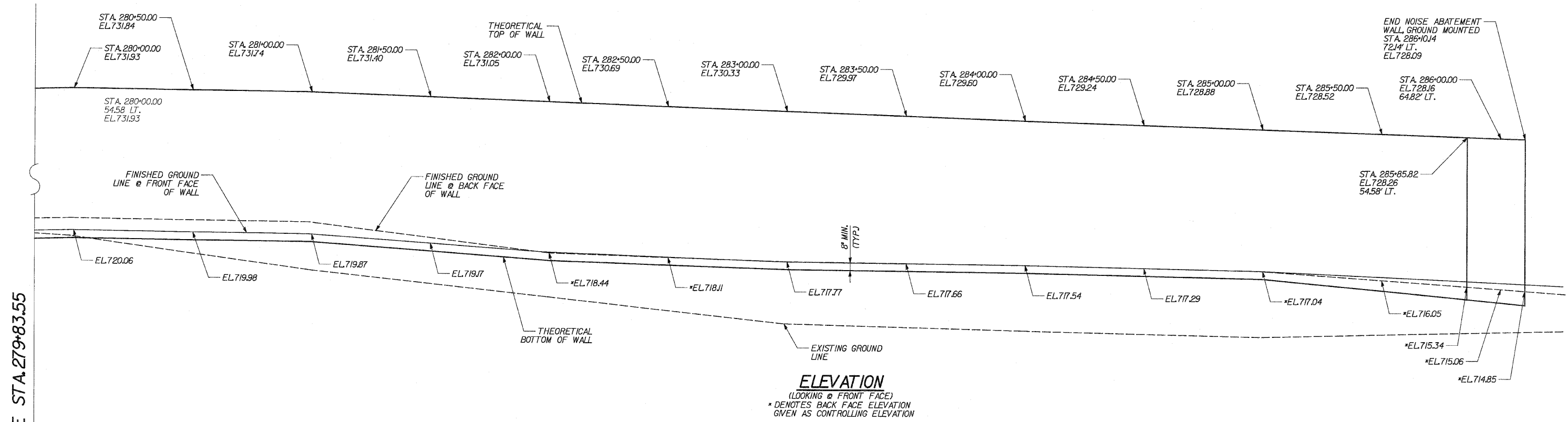

DESIGNED	WSP
CHECKED	ASP
DRAWN	BGC
CHECKED	WSP

REVISIONS	
NAME	DATE

DLZ DLZ Illinois, Inc.
 85 W. Algonquin Rd. Ste. 220
 Arlington Heights IL 60005

**NOISE WALL C
 GENERAL PLAN II**
 U.S. ROUTE 30 (LINCOLN HIGHWAY)
 F.A.P. 353 (U.S. 30)
 SECTION (12 & 13) WRS-3
 STATION 273+75.74 TO 286+10.14
 WILL COUNTY