

F.A.P. RTE.	SECTION	COUNTY	TOTAL SHEETS	SHEET NO.
353	(12&13)WRS-3	WILL	1235	802
STA.		TO STA.		
FED. ROAD DIST. NO.		ILLINOIS FED. AID PROJECT		

**ROUTE MARKERS**

FOR U.S. ROUTES MI-40-2424

FOR ILLINOIS ROUTES MI-50-2424

R.R. UNMARKED ROUTES SPECIAL 24" x 18" VARIABLE 4" BLACK LETTERS ON WHITE REFLECTIVE BACKGROUND

**ARROWS SIGNS**

M5-1L-2115

M5-1R-2115

M6-1-2115

M6-1-2115

M6-3-2115

**CARDINAL DIRECTION & DETOUR SIGNS**

NORTH M3-1-2412

EAST M3-2-2412

SOUTH M3-3-2412

WEST M3-4-2412

DETOUR M4-8-2412

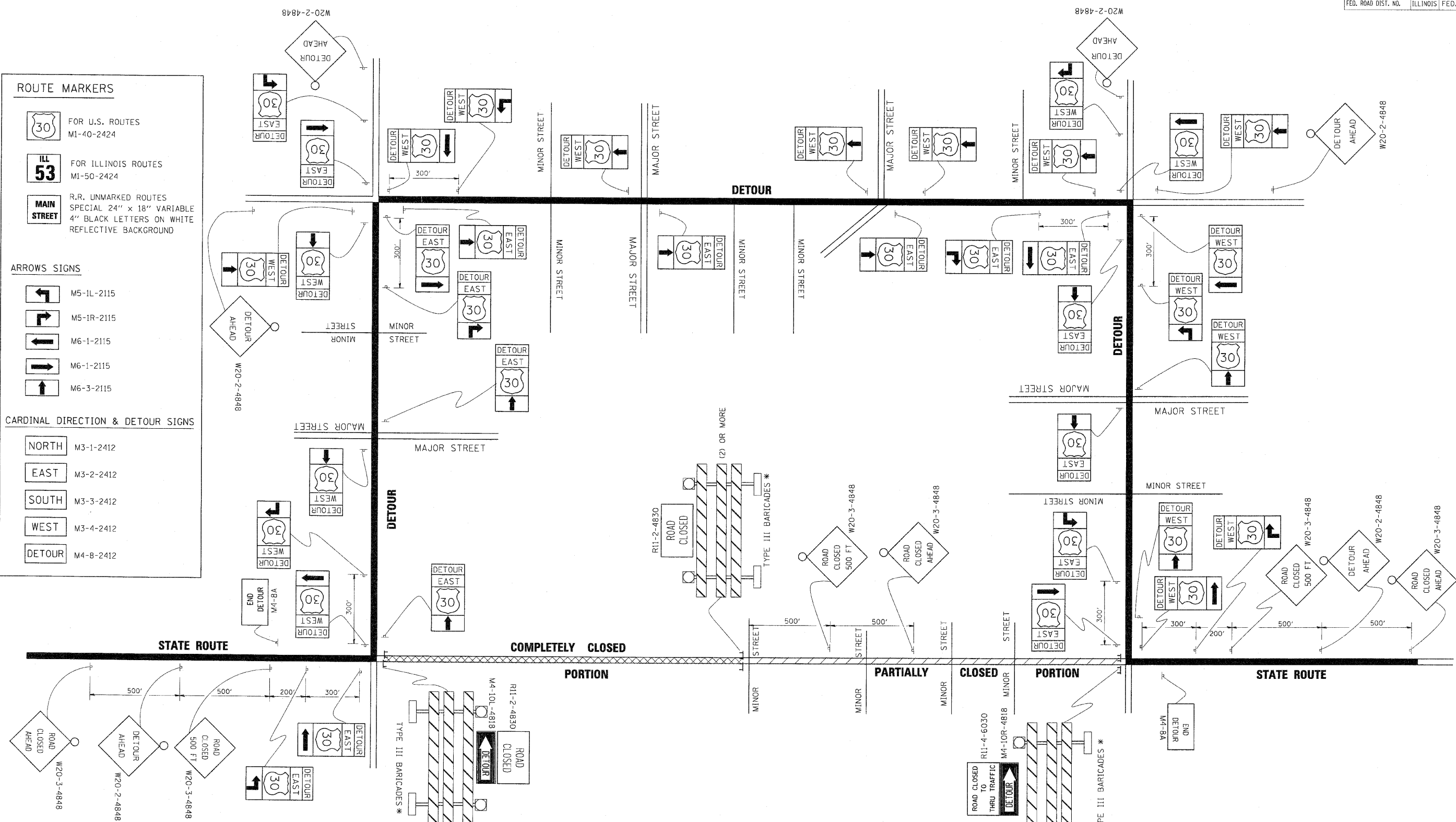

\* IF A TYPE III BARRICADE WITH AN ATTACHED SIGN PANEL WHICH MEETS NCHRP 350 REQUIREMENTS IS NOT AVAILABLE, THE SIGNS SHALL BE MOUNTED, ABOVE THE BARRICADES, ON SEPARATE SIGNS SUPPORTS THAT MEET NCHRP 350 REQUIREMENTS.

REVISIONS	
NAME	DATE
R. BORO	09/14/09

ILLINOIS DEPARTMENT OF TRANSPORTATION

**DETOUR SIGNING FOR CLOSING STATE HIGHWAYS**

SCALE: NONE

DRAWN BY  
CHECKED BY  
TC-21

PLOT DATE = 9/14/2009  
FILE NAME = c:\pwworkspace\pwworkspace\1021.dgn  
PLOT SCALE = 48,9999 / IN.  
USER NAME = drivokeng