

FINAL SURVEY	DATE
SURVEYED	BY
NOTE BOOK	
AREAS CHECKED	
NO.	

ORIGINAL SURVEY	DATE
EXPLODED PLOTTED	BY
NOTE BOOK	
AREAS CHECKED	
NO.	

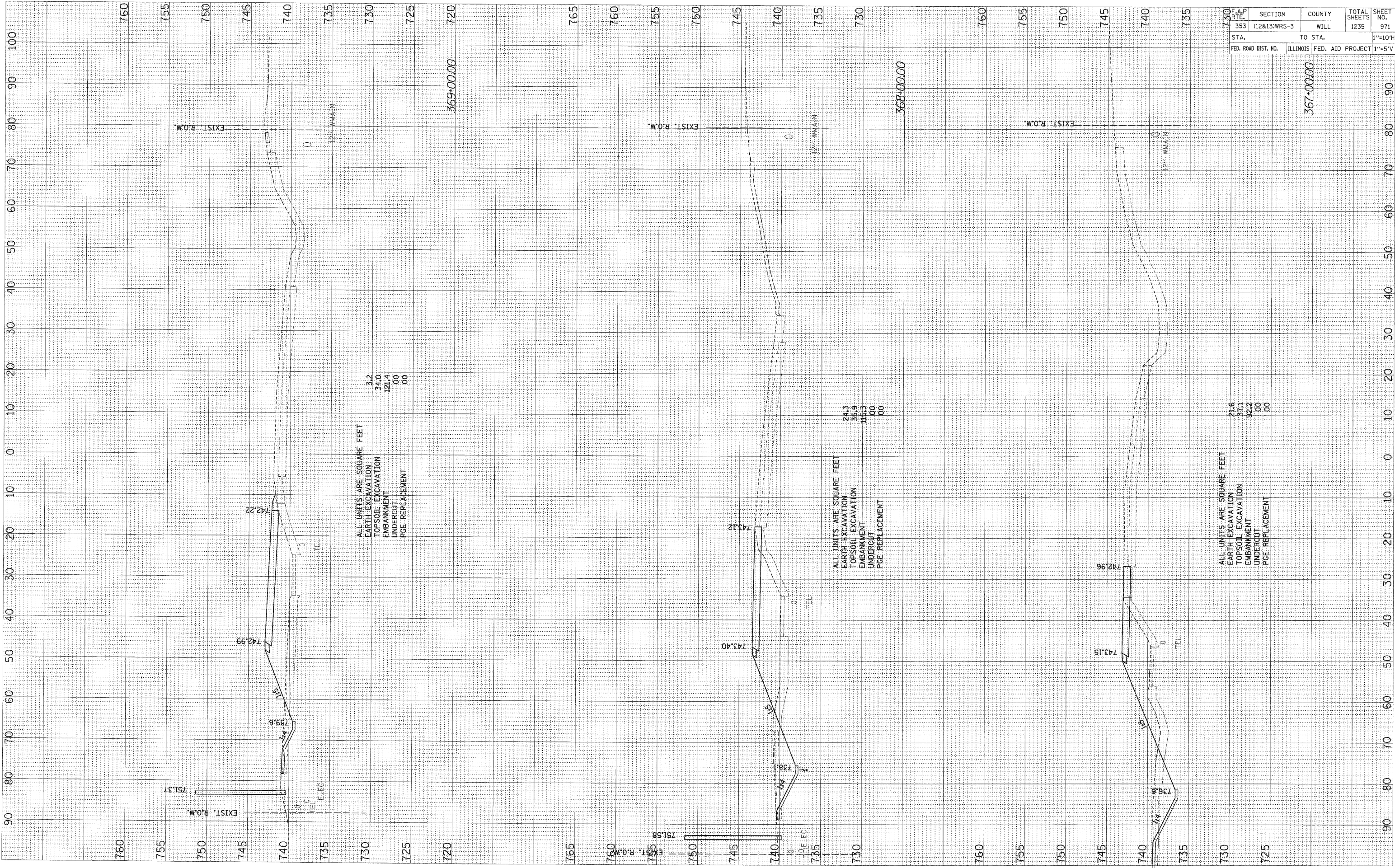

F.A.P. PORT.	SECTION	COUNTY	TOTAL SHEETS	SHEET NO.
353	(12&13)WRS-3	WILL	1235	971
STA.	TO STA.			1"=10'H
FED. ROAD DIST. NO.	ILLINOIS	FED. AID PROJECT	1"=5'V	