

DATE	
BY	
REVISIONS	
NO.	
DATE	
BY	
REVISIONS	
NO.	
DATE	
BY	
REVISIONS	
NO.	
DATE	
BY	
REVISIONS	
NO.	
DATE	
BY	
REVISIONS	
NO.	

DATE	
BY	
REVISIONS	
NO.	
DATE	
BY	
REVISIONS	
NO.	
DATE	
BY	
REVISIONS	
NO.	
DATE	
BY	
REVISIONS	
NO.	

FILE NAME = P:\2009\ME0906\_Ver-Var-Plan\CADD\W05\_US20\_Shts\112529-1.dwg  
 PLOT SCALE = 1"=50'  
 USER NAME = Millennium Professional Services

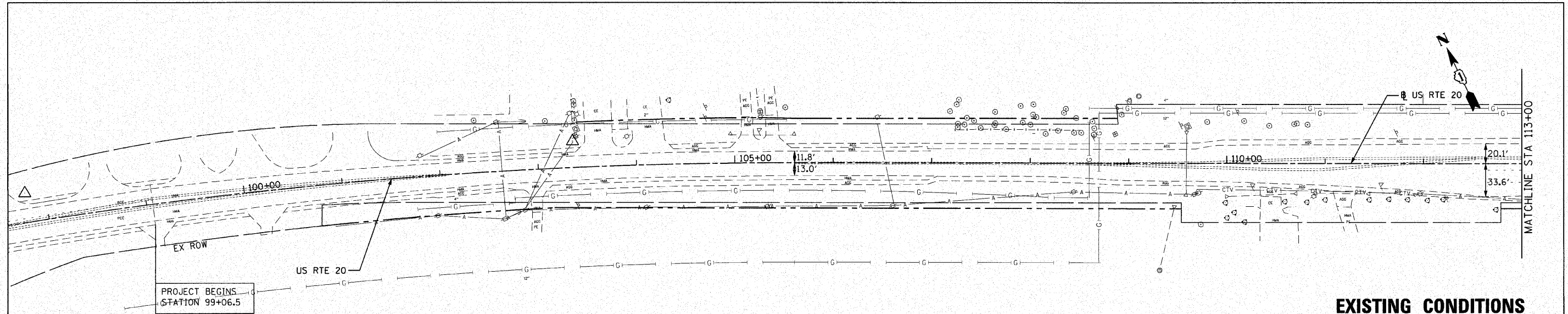

**EXISTING CONDITIONS**

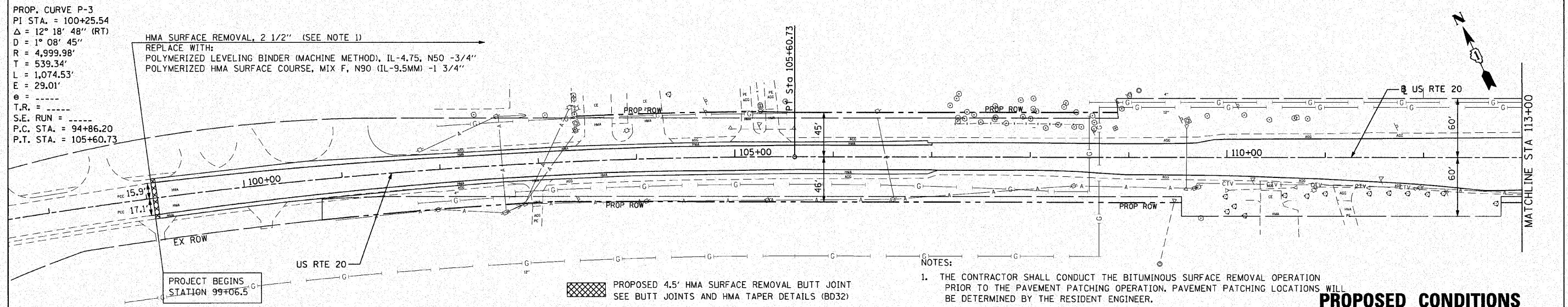

**PROPOSED CONDITIONS**

PROP. CURVE P-3  
 PI STA. = 100+25.54  
 $\Delta = 12^\circ 18' 48''$  (RT)  
 $D = 1^\circ 08' 45''$   
 $R = 4,999.98'$   
 $T = 539.34'$   
 $L = 1,074.53'$   
 $E = 29.01'$   
 $e = \dots$   
 T.R. = \dots  
 S.E. RUN = \dots  
 P.C. STA. = 94+86.20  
 P.T. STA. = 105+60.73

HMA SURFACE REMOVAL, 2 1/2" (SEE NOTE 1)  
 REPLACE WITH:  
 POLYMERIZED LEVELING BINDER (MACHINE METHOD), IL-4.75, N50 -3/4"  
 POLYMERIZED HMA SURFACE COURSE, MIX F, N90 (IL-9.5MM) -1 3/4"

PROPOSED 4.5' HMA SURFACE REMOVAL BUTT JOINT  
 SEE BUTT JOINTS AND HMA TAPER DETAILS (BD32)

NOTES:  
 1. THE CONTRACTOR SHALL CONDUCT THE BITUMINOUS SURFACE REMOVAL OPERATION PRIOR TO THE PAVEMENT PATCHING OPERATION. PAVEMENT PATCHING LOCATIONS WILL BE DETERMINED BY THE RESIDENT ENGINEER.

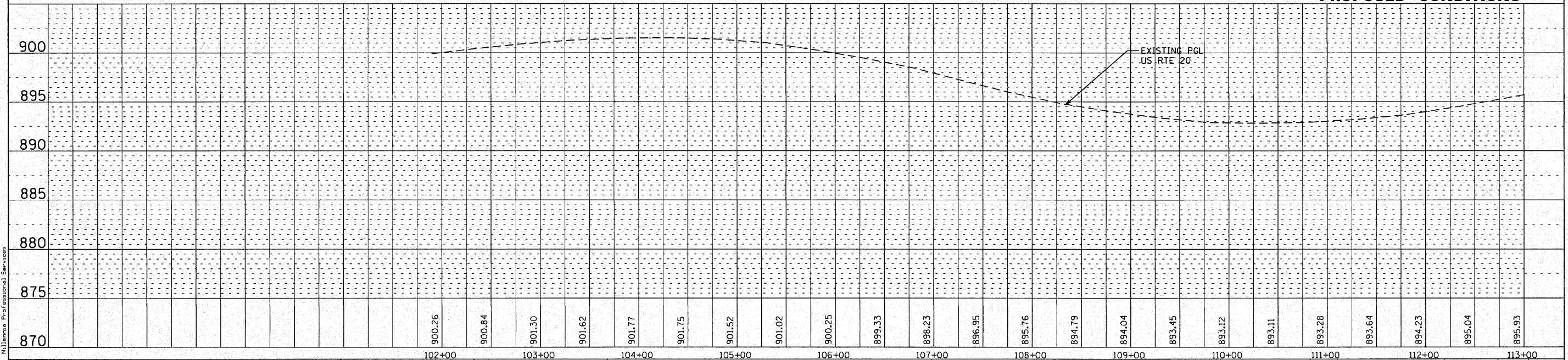

DESIGNED	TVN	REVISED	
DRAWN	TVN	REVISED	
CHECKED	RPD	REVISED	
DATE	10/25/2010	REVISED	

<b>STATE OF ILLINOIS</b>		<b>U.S. ROUTE 20</b>		<b>PLAN AND PROFILE</b>	
<b>DEPARTMENT OF TRANSPORTATION</b>		<b>EAST OF PLANK ROAD TO WELD ROAD</b>		<b>PLAN AND PROFILE</b>	
SCALE:	1"=50'	SHEET NO. OF	SHEETS	STA. 105+60 TO STA.	114+00

F.A.P. RTE.	SECTION	COUNTY	TOTAL SHEETS	SHEET NO.
345	8WRS-2	KANE	72	12
FED. ROAD DIST. NO. 1 ILLINOIS FED. AID PROJECT			CONTRACT NO. 62529	



200 22ND Street, Suite 216, Lombard, IL 60148  
 630.745.8110 voice, 630.829.2566 fax  
 WWW.MPS-IL.COM  
**MILLENNIA PROFESSIONAL SERVICES**

P:\2009\ME0906\_Ver-Var-Plan\CADD\W05\_US20\_Shts\112529-1.dwg