

THE TRAFFIC SIGNAL CONTROL EQUIPMENT FOR THIS SYSTEM SHALL BE "EAGLE" TO MATCH THE EXISTING ADJACENT SYSTEM.

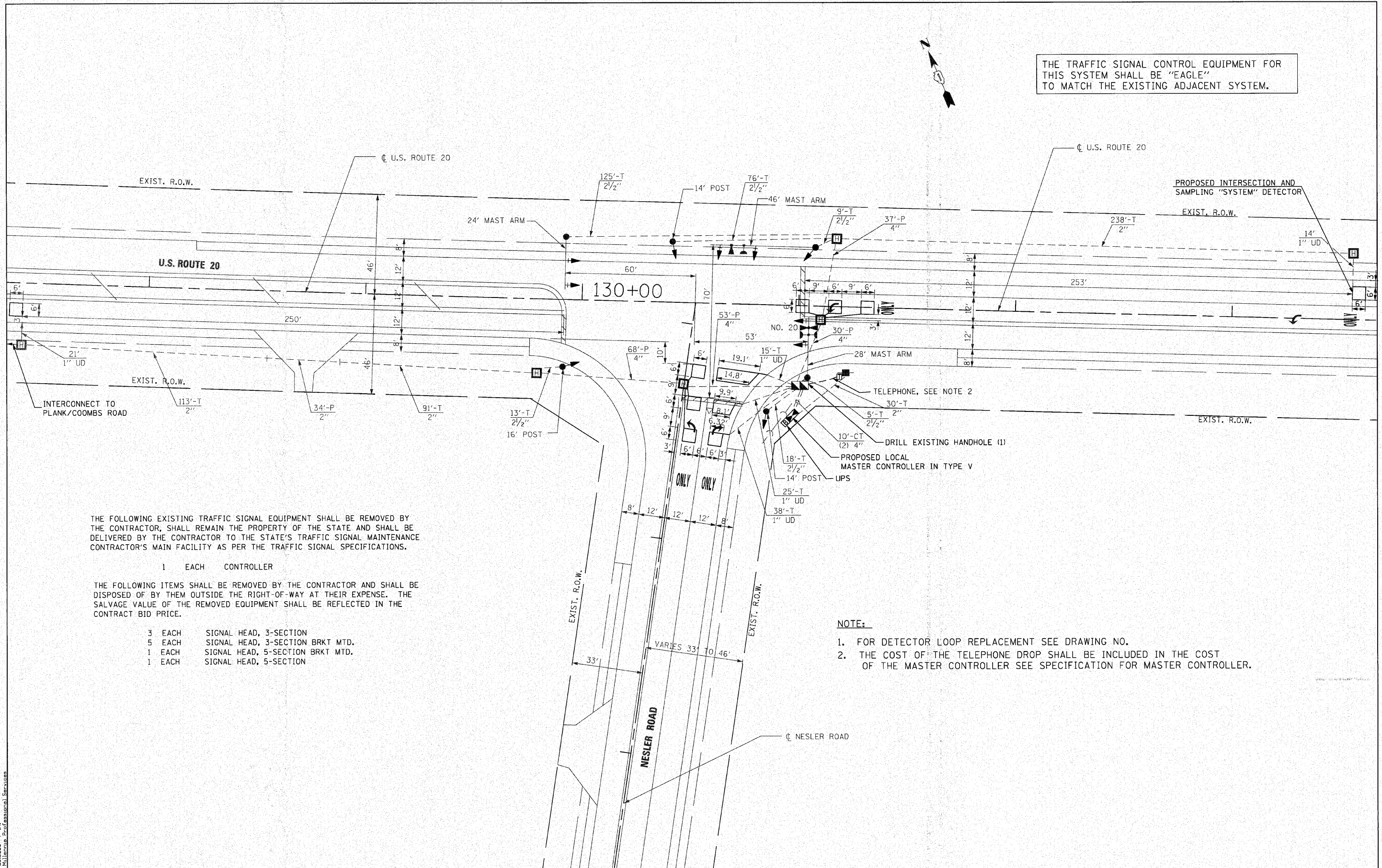

THE FOLLOWING EXISTING TRAFFIC SIGNAL EQUIPMENT SHALL BE REMOVED BY THE CONTRACTOR, SHALL REMAIN THE PROPERTY OF THE STATE AND SHALL BE DELIVERED BY THE CONTRACTOR TO THE STATE'S TRAFFIC SIGNAL MAINTENANCE CONTRACTOR'S MAIN FACILITY AS PER THE TRAFFIC SIGNAL SPECIFICATIONS.

1 EACH CONTROLLER

THE FOLLOWING ITEMS SHALL BE REMOVED BY THE CONTRACTOR AND SHALL BE DISPOSED OF BY THEM OUTSIDE THE RIGHT-OF-WAY AT THEIR EXPENSE. THE SALVAGE VALUE OF THE REMOVED EQUIPMENT SHALL BE REFLECTED IN THE CONTRACT BID PRICE.

- 3 EACH SIGNAL HEAD, 3-SECTION
- 5 EACH SIGNAL HEAD, 3-SECTION BRKT MTD.
- 1 EACH SIGNAL HEAD, 5-SECTION BRKT MTD.
- 1 EACH SIGNAL HEAD, 5-SECTION

NOTE:
 1. FOR DETECTOR LOOP REPLACEMENT SEE DRAWING NO.
 2. THE COST OF THE TELEPHONE DROP SHALL BE INCLUDED IN THE COST OF THE MASTER CONTROLLER SEE SPECIFICATION FOR MASTER CONTROLLER.

FILE NAME: P:\2009\ME\09086_Ver\PH11\CADD\W05_US20\Shots\162529-sh1-T502-Nesler-Signal.dgn
 PLOT SCALE: 24/0000 / IN
 USER NAME: Millennium Professional Services

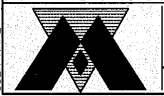

200 22ND Street, Suite 216, Lombard, IL 60148
 630.705.0110 voice, 630.839.2566 fax
 WWW.MPS-IL.COM
MILLENNIUM PROFESSIONAL SERVICES

DESIGNED - TVN	REVISED -
DRAWN - TVN	REVISED -
CHECKED - RPD	REVISED -
DATE - 4/9/2010	REVISED -

**STATE OF ILLINOIS
 DEPARTMENT OF TRANSPORTATION**

TRAFFIC SIGNAL INSTALLATION PLAN				
US 20 AT NESLER ROAD				
SCALE:	SHEET NO.	OF SHEETS	STA.	TO STA.

F.A.P. RTE.	SECTION	COUNTY	TOTAL SHEETS	SHEET NO.
345	8WRS-2	KANE	72	40
FED. ROAD DIST. NO. 1 ILLINOIS FED. AID PROJECT			CONTRACT NO. 62529	

P:\2009\ME\09086_Ver\PH11\CADD\W05_US20\Shots\162529-sh1-T502-Nesler-Signal.dgn