

**CONSTRUCTION NOTES:**

- ① THE CONTRACTOR SHALL REMOVE THE EXISTING TRAFFIC SIGNAL CABINET, CONTROLLER, AND ADPRO VIDEO COMMUNICATION EQUIPMENT.
- ② THE CONTRACTOR SHALL INSTALL NEW FULL-ACTUATED CONTROLLER AND TYPE IV CABINET, SPECIAL AND UNINTERRUPTIBLE POWER SUPPLY ON EXISTING FOUNDATION
- ③ THE CONTRACTOR SHALL RELOCATE THE EXISTING EMERGENCY VEHICLE PRIORITY SYSTEM, PHASING UNIT, THE EXISTING VIDEO DETECTION SYSTEM, AND THE EXISTING REMOTE CONTROLLED VIDEO SYSTEM TO THE NEW CABINET
- ④ THE CONTRACTOR SHALL INSTALL NEW LAYER II (DATALINK) SWITCH, NEW VIDEO ENCODER AND NEW QUAD ENCODER IN NEW CABINET
- ⑤ ALL CONFIRMATION BEACONS SHALL BE RETROFITTED WITH L.E.D. INDICATIONS. THIS WORK SHALL BE INCLUDED IN THE COST FOR THE PAY ITEM UNINTERRUPTIBLE POWER SUPPLY.

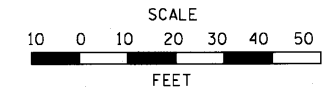

PROPOSED INTERCONNECT TO ROLLINS RD & GRAND AVE.  
(SEE SHEET NO. 47 FOR DETAILS)

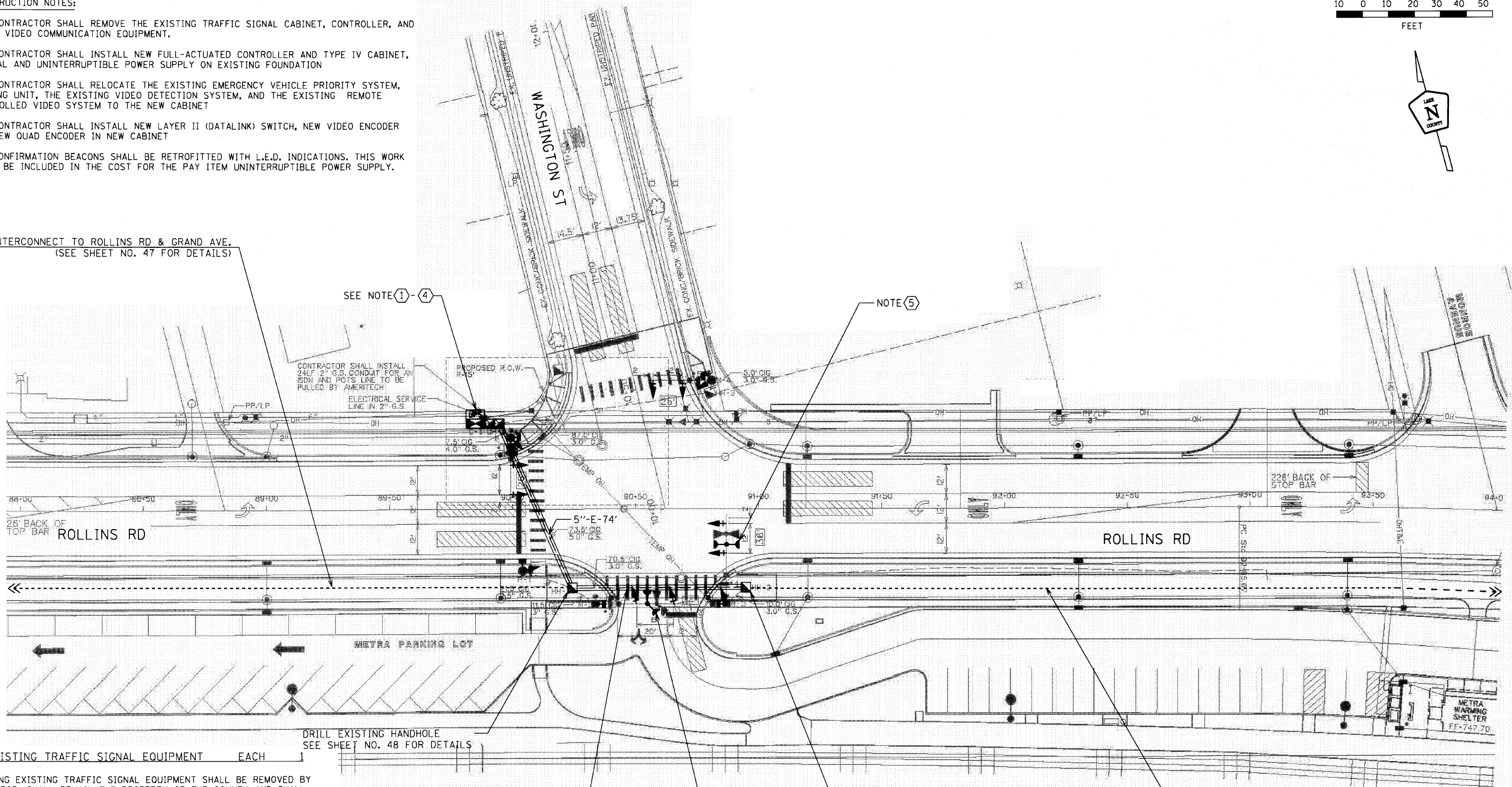

REMOVE EXISTING TRAFFIC SIGNAL EQUIPMENT EACH 1

THE FOLLOWING EXISTING TRAFFIC SIGNAL EQUIPMENT SHALL BE REMOVED BY THE CONTRACTOR, SHALL REMAIN THE PROPERTY OF THE COUNTY AND SHALL BE DELIVERED BY THE CONTRACTOR TO THE COUNTY YARD AS PER THE TRAFFIC SIGNAL SPECIFICATIONS OR AS DIRECTED BY THE COUNTY TRAFFIC ENGINEER.

- AGENCY: LAKE COUNTY DEPARTMENT OF TRANSPORTATION
- 1 EACH CABINET AND CONTROLLER (COMPLETE)
  - 1 EACH ADPRO VIDEO COMMUNICATION EQUIPMENT

THE FOLLOWING ITEMS SHALL BE REMOVED BY THE CONTRACTOR AND SHALL BE DISPOSED OF BY THEM OUTSIDE THE RIGHT-OF-WAY AT THEIR EXPENSE. THE SALVAGE VALUE OF THE REMOVED EQUIPMENT SHALL BE REFLECTED IN THE CONTRACT BID PRICE.

- 6 EACH PEDESTRIAN SIGNAL HEADS

	USER NAME = JM	DESIGNED - DG	REVISED -	<b>STATE OF ILLINOIS</b> <b>DEPARTMENT OF TRANSPORTATION</b>	<b>CONTROLLER UPGRADE INTERSECTION LOCATION</b> <b>ROLLINS RD. @ WASHINGTON ST.</b>	ROUTE	SECTION	SECTION NUMBER	SHEET	SHEETS
	PLOT SCALE = 1 INCH = 20 FEET PLOT DATE = 10-05-2010	DRAWN - JM CHECKED - DG DATE - 10-05-2010	REVISED - REVISED - REVISED -			SCALE: 1"=20' FAU 181	09-00999-07-TL CUGRO-1	27 72	CONTRACT NO. 09472	