

SCHEDULE OF QUANTITIES

ITEM	UNIT	QTY
MAINTENANCE OF EXISTING TRAFFIC SIGNAL INSTALLATION	EACH	1
FULL-ACTUATED CONTROLLER AND TYPE IV CABINET, SPECIAL	EACH	1
PEDESTRIAN SIGNAL HEAD, LED, 1-FACE, BRACKET MOUNTED WITH COUNTDOWN TIMER	EACH	4
PEDESTRIAN SIGNAL HEAD, LED, 2-FACE, BRACKET MOUNTED WITH COUNTDOWN TIMER	EACH	1
RELOCATE EXISTING EMERGENCY VEHICLE PRIORITY SYSTEM, PHASING UNIT	EACH	1
REMOVE EXISTING TRAFFIC SIGNAL EQUIPMENT	EACH	1
UNINTERRUPTIBLE POWER SUPPLY	EACH	1
SIGNAL HEAD ,LED, 1-FACE, 3-SECTION, BRACKET MOUNTED, RETROFIT	EACH	2
SIGNAL HEAD ,LED, 1-FACE, 3-SECTION, MAST-ARM MOUNTED, RETROFIT	EACH	6
SIGNAL HEAD ,LED, 1-FACE, 5-SECTION, BRACKET MOUNTED, RETROFIT	EACH	2
SIGNAL HEAD ,LED, 1-FACE, 5-SECTION, MAST-ARM MOUNTED, RETROFIT	EACH	2
LAYER II (DATALINK) SWITCH	EACH	1
RELOCATE EXISTING VIDEO DETECTION SYSTEM (COMPLETE INTERSECTION)	EACH	1
TERMINAL SERVER	EACH	1
QUAD ENCODER	EACH	1
VIDEO ENCODER	EACH	1

PROPOSED 24 S.M. F.O. CABLE TO
ROLLINS RD & GRAND AVE.

PROPOSED TRACER CABLE 1/C #14 TO
ROLLINS RD & GRAND AVE.

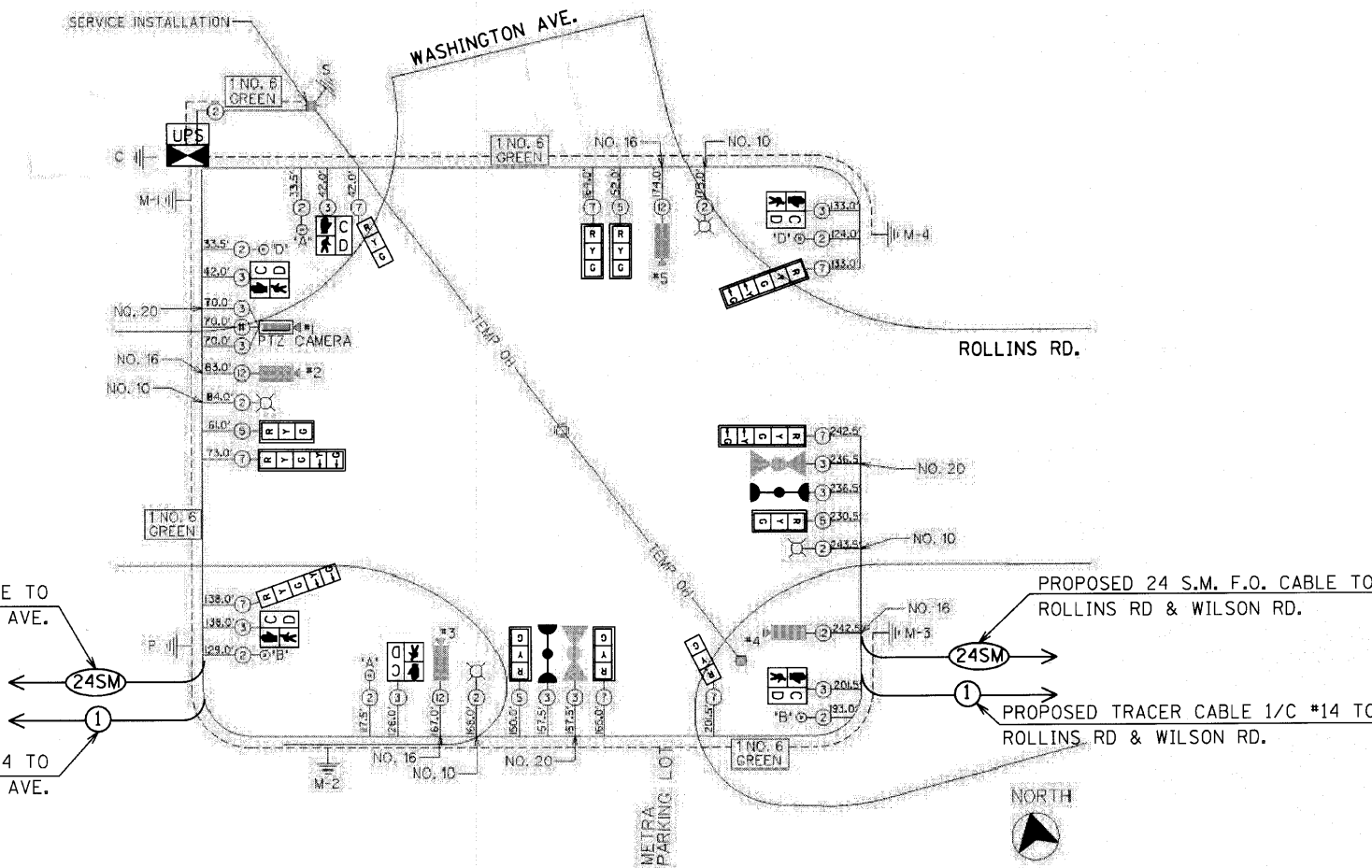

CABLE PLAN

No Scale

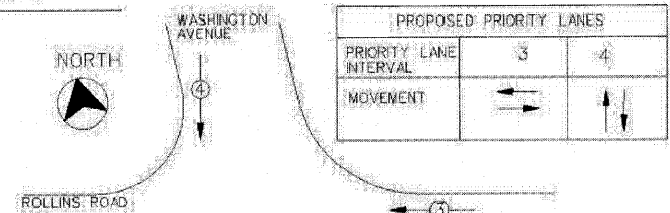

- NOTES:
- ONCE PREEMPTION HAS BEEN CALLED, TERMINATION OF A PHASE(S) SHALL BE IDENTICAL TO THE NORMAL SEQUENCE OF OPERATION'S TERMINATION OF A PHASE(S).
 - TERMINATION OF ALL PEDESTRIAN PHASES SHALL INCLUDE A FULL FLASHING "DON'T WALK" INTERVAL.
 - IF ALL RED CLEARANCE IS USED IN THE NORMAL SEQUENCE OF OPERATION, IT MUST BE DISPLAYED AFTER THE YELLOW CLEARANCE INTERVAL WHEN ENTERING OR LEAVING THE PREEMPTION SEQUENCE.

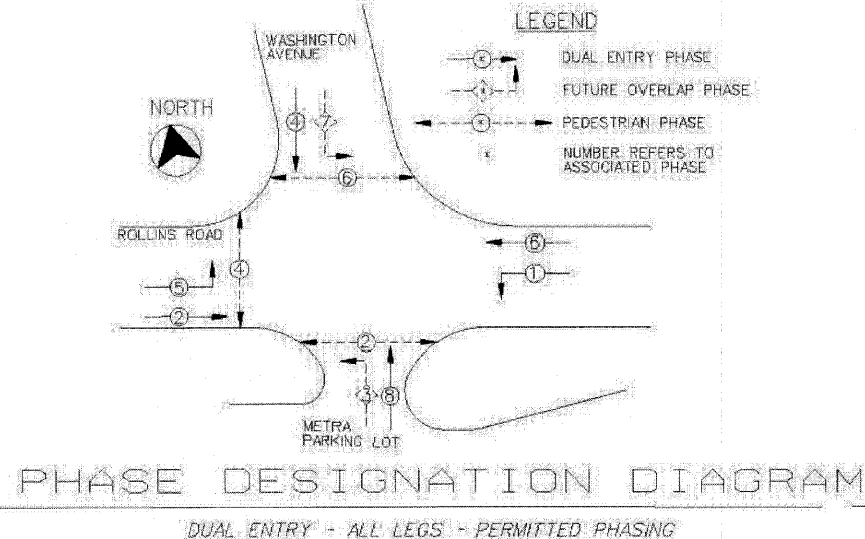

EMERGENCY VEHICLE PREEMPTION SEQUENCE

EMERGENCY VEHICLE PREEMPTION SEQUENCE NOTES FOR DUAL ENTRY OPERATION - ALL LEGS

TYPE	NO. OF LAMPS	WATTAGE		% OPERATION	TOTAL WATTAGE (INCAND.)
		INCAND.	LED		
SIGNAL	(RED)	12	10	0.50	60
	(YELLOW)	12	19	0.10	22.8
	(GREEN)	12	11	0.40	52.8
ARROW	8		9	0.10	7.2
PED SIGNAL	6		9	1.00	54
CONTROLLER	1		100	1.00	100
LUMINAIRE	4		250	0.50	500
L.E.D. ST. NAME SIGN			64	0.50	
VIDEO SYSTEM	1		150	1.00	150
BATTERY BACKUP	1		25	1.00	25
TOTAL					971.80

ENERGY COSTS - BILLED TO: VILLAGE OF FOX LAKE
(ADDRESS) 66 THILLEN DR.
(ADDRESS) FOX LAKE, IL

ENERGY SUPPLY - CONTACT: MR. FRANK ZACCARI
PHONE: (847) 816-5489
COMPANY: COMED