

CONSTRUCTION NOTES:

- ① THE CONTRACTOR SHALL INSTALL NEW MAST ARM 8' FROM EXISTING MAST ARM. THE EXISTING MAST ARM SHALL NOT BE REMOVED OR DISCONNECTED UNTIL THE PROPOSED MAST ARM IS INSTALLED AND WITH ALL SIGNAL EQUIPMENT OPERATIONAL.
- ② THE CONTRACTOR SHALL RELOCATE ALL SIGNAGE TO NEW COMBINATION MAST ARM. COST FOR RELOCATION OF SIGNAGE SHALL BE INCLUDED IN COST FOR "REMOVE EXISTING TRAFFIC SIGNAL EQUIPMENT". REMOVE EXISTING MAST ARM.
- ③ THE CONTRACTOR SHALL ABANDON THE EXISTING CONDUIT (2 1/2" - 6"). THE EXISTING CABLES SHALL BE PULLED FROM THE NEAREST HANDHOLE BACK TO THE CONTROLLER AND REMOVED. COST FOR CABLE REMOVAL SHALL BE PAID PER FOOT BY "REMOVE ELECTRIC CABLE FROM CONDUIT".
- ④ THE CONTRACTOR SHALL INSTALL NEW WIRELESS SYSTEM NODE ON NEW COMBINATION M.A. DIRECTIONAL ANTENNA TO POINT TOWARDS ROLLINS RD. @ GRAND AVE.
- ⑤ THE CONTRACTOR SHALL UPGRADE THE EXISTING CONTROLLER SOFTWARE TO NTCIP.
- ⑥ THE CONTRACTOR SHALL INSTALL NEW VIDEO ENCODER, NEW LAYER II (DATALINK) SWITCH, AND NEW TERMINAL SERVER IN THE EXISTING TRAFFIC SIGNAL CABINET.

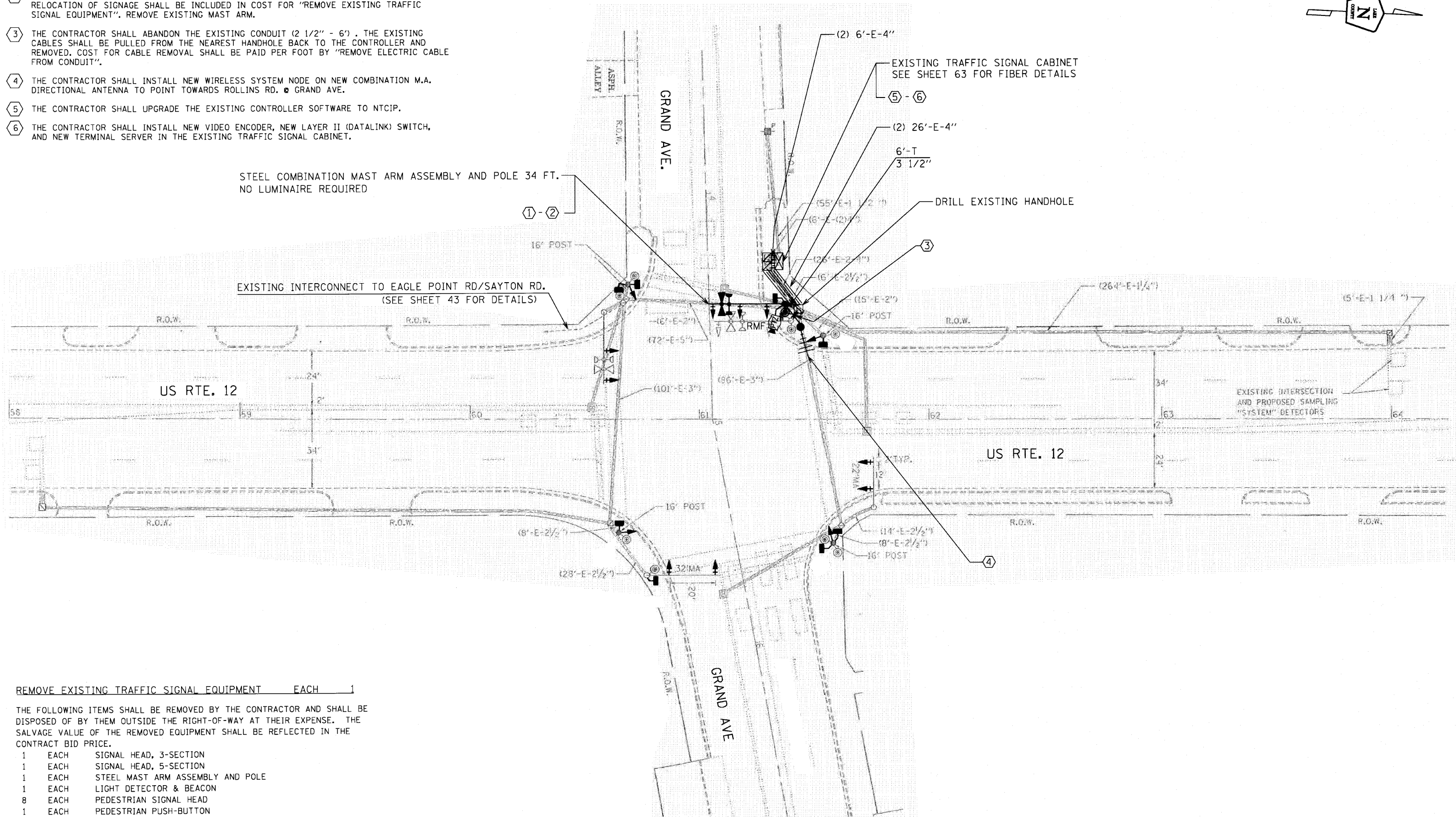
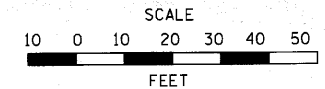

THE FOLLOWING ITEMS SHALL BE REMOVED BY THE CONTRACTOR AND SHALL BE DISPOSED OF BY THEM OUTSIDE THE RIGHT-OF-WAY AT THEIR EXPENSE. THE SALVAGE VALUE OF THE REMOVED EQUIPMENT SHALL BE REFLECTED IN THE CONTRACT BID PRICE.

- 1 EACH SIGNAL HEAD, 3-SECTION
- 1 EACH SIGNAL HEAD, 5-SECTION
- 1 EACH STEEL MAST ARM ASSEMBLY AND POLE
- 1 EACH LIGHT DETECTOR & BEACON
- 8 EACH PEDESTRIAN SIGNAL HEAD
- 1 EACH PEDESTRIAN PUSH-BUTTON



USER NAME = JM	DESIGNED - DG	REVISED -
	DRAWN - JM	REVISED -
PLOT SCALE = 1 INCH = 20 FEET	CHECKED - DG	REVISED -
PLOT DATE = 10-05-2010	DATE - 10-05-2010	REVISED -

**STATE OF ILLINOIS
DEPARTMENT OF TRANSPORTATION**

**VIDEO CAMERA LOCATION
US 12 (RAND RD.) @ GRAND AVE.**

SCALE: 1"=20'

ROUTE	SECTION	SECTION NUMBER	SHEET	SHEETS
FAU 181		09-00999-07-TL	31	72
VCL-2			CONTRACT NO. 09472	