

CONSTRUCTION NOTES:

- ① THE CONTRACTOR SHALL INSTALL NEW MAST ARM 10' FROM EXISTING MAST ARM. THE EXISTING MAST ARM SHALL NOT BE REMOVED OR DISCONNECTED UNTIL THE PROPOSED MAST ARM IS INSTALLED AND WITH ALL SIGNAL EQUIPMENT OPERATIONAL.
- ② THE CONTRACTOR SHALL RELOCATE ALL SIGNAGE TO THE NEW COMBINATION MAST ARM BEFORE REMOVING EXISTING MAST ARM. COST FOR RELOCATION OF SIGNAGE SHALL BE INCLUDED IN COST FOR "REMOVE EXISTING TRAFFIC SIGNAL EQUIPMENT".
- ③ THE CONTRACTOR SHALL ABANDON THE EXISTING CONDUIT (2 1/2" - 82"). THE EXISTING CABLES SHALL BE PULLED FROM THE NEAREST HANDHOLE BACK TO THE CONTROLLER AND REMOVED. COST FOR CABLE REMOVAL SHALL BE PAID PER FOOT BY "REMOVE ELECTRIC CABLE FROM CONDUIT".

ITEM	STATION	OFFSET	POSSIBLE UTILITY CONFLICT
MA-1	281+21.4	49.8' N	

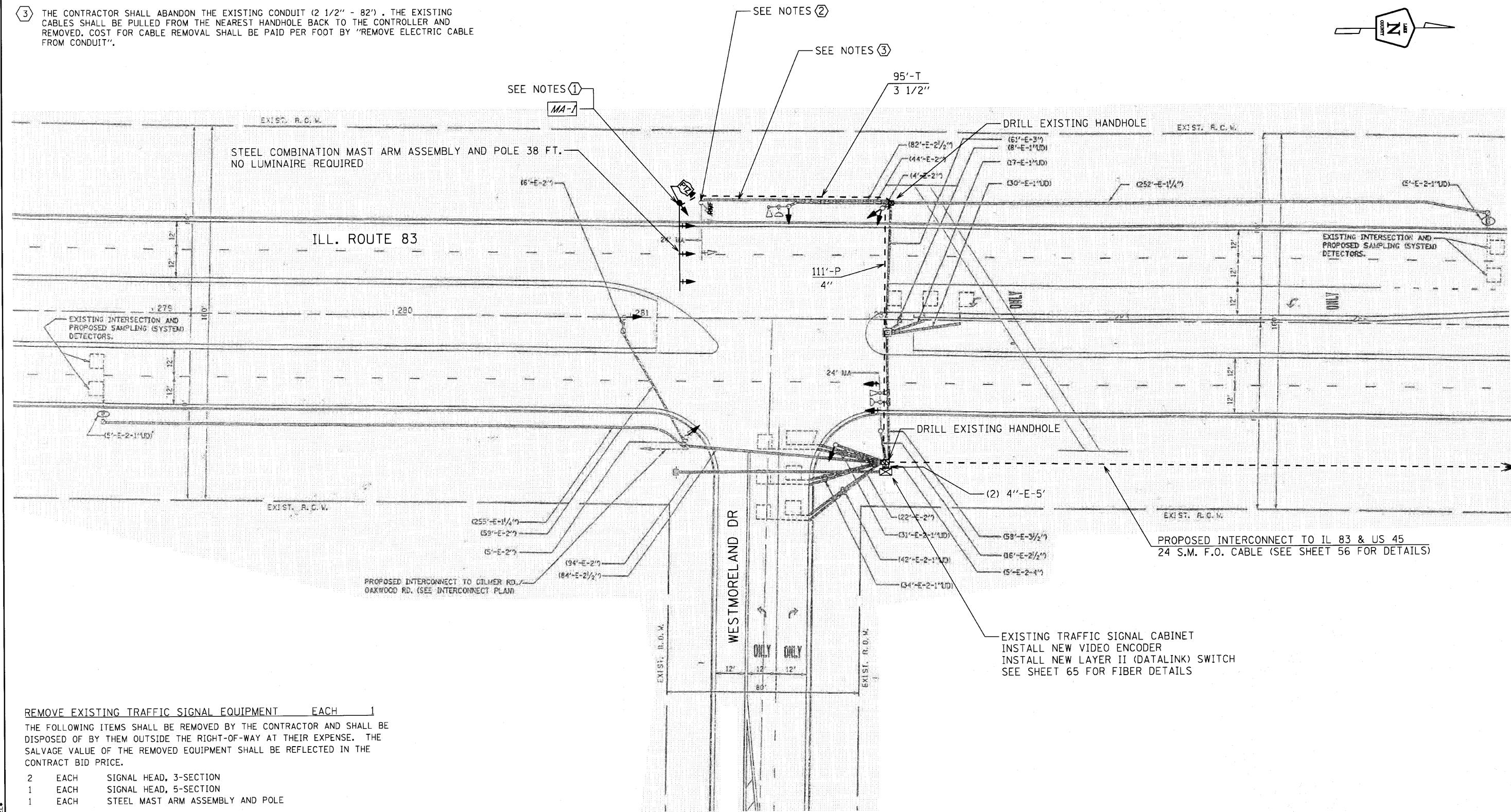
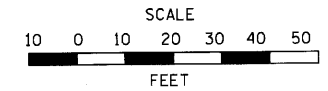

REMOVE EXISTING TRAFFIC SIGNAL EQUIPMENT EACH 1  
 THE FOLLOWING ITEMS SHALL BE REMOVED BY THE CONTRACTOR AND SHALL BE DISPOSED OF BY THEM OUTSIDE THE RIGHT-OF-WAY AT THEIR EXPENSE. THE SALVAGE VALUE OF THE REMOVED EQUIPMENT SHALL BE REFLECTED IN THE CONTRACT BID PRICE.

- 2 EACH SIGNAL HEAD, 3-SECTION
- 1 EACH SIGNAL HEAD, 5-SECTION
- 1 EACH STEEL MAST ARM ASSEMBLY AND POLE



USER NAME = JM	DESIGNED - DG	REVISED -
DRAWN - JM	REVISIONS -	
PLOT SCALE = 1 INCH = 20 FEET	CHECKED - DG	REVISED -
PLOT DATE = 10-05-2010	DATE - 10-05-2010	REVISED -

STATE OF ILLINOIS  
 DEPARTMENT OF TRANSPORTATION

VIDEO CAMERA LOCATION  
 IL 83 @ WESTMORELAND DR.  
 SCALE: 1"=20'

ROUTE	SECTION	SECTION NUMBER	SHEET	SHEETS
FAU 181		09-00999-07-TL	39	72
VCL-5			CONTRACT NO. 69472	