

**NOTE:**

1. TREES IN CONSTRUCTION AREA NOT MARKED FOR REMOVAL SHALL BE PROTECTED IN ACCORDANCE WITH THE STANDARD SPECIFICATIONS.
2. MAIL BOXES IN CONSTRUCTION LIMITS SHALL BE REPLACED WITH NEW MAIL BOXES. EXISTING MAIL BOXES REMOVED SHALL BE RETURNED TO THE PROPERTY OWNERS.
3. SEE SIGNING & STRIPING SHEETS FOR STREET SIGN REMOVAL/RELOCATION.

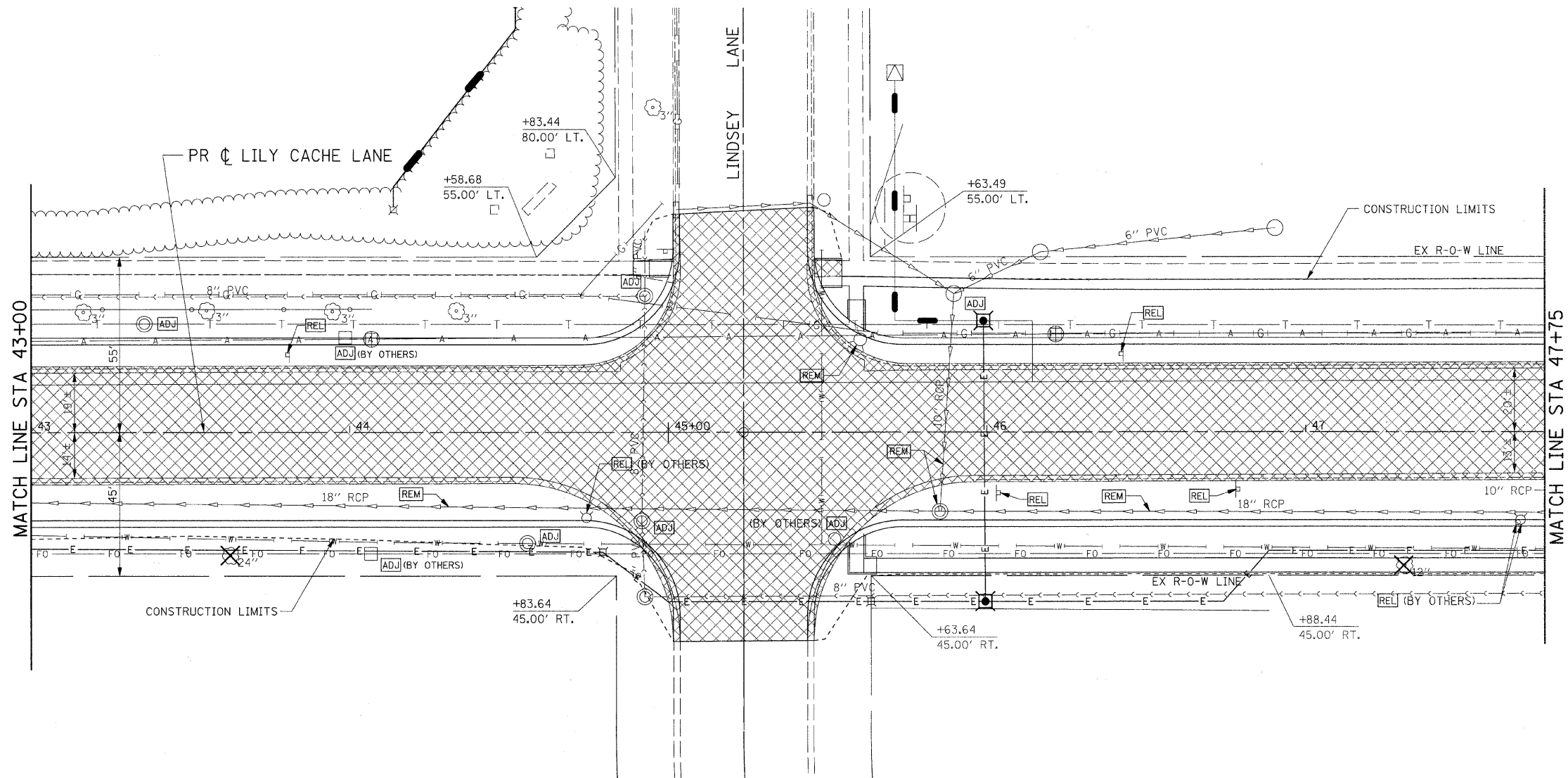
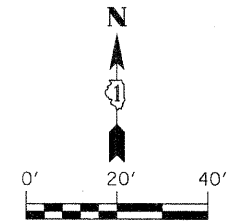

**LEGEND**

- ASPHALT / CONCRETE REMOVAL
- INDICATES ITEM TO BE REMOVED

FILE NAME = G:\S09021\CA00_Sheets\9021REM05.dgn	USER NAME = IE Consultants	DESIGNED -	REVISED -	<b>STATE OF ILLINOIS DEPARTMENT OF TRANSPORTATION</b>	<b>LILY CACHE LANE REMOVAL AND ADJUSTMENT PLAN</b>				F.A.U. 1578	SECTION 06-00046-01-PV	COUNTY WILL	TOTAL SHEETS 244	SHEET NO. 60
PLOT SCALE = 28.0000' / IN.		CHECKED -	REVISED -		SCALE: SHEET NO. OF SHEETS STA. 43+00 TO STA. 47+75				CONTRACT NO. 63503				
PLOT DATE = 10/22/2010		DATE -	REVISED -		ILLINOIS FED. AID PROJECT								