

NOTES:

1. SEE "REMOVAL AND ADJUSTMENT PLANS" FOR REMOVAL OF EXISTING ITEMS.
2. CONTRACTOR SHALL MAINTAIN ACCESS TO ENTRANCES AT ALL TIMES AND PROVIDE TEMPORARY ENTRANCES WHERE REQUIRED DURING CONSTRUCTION.

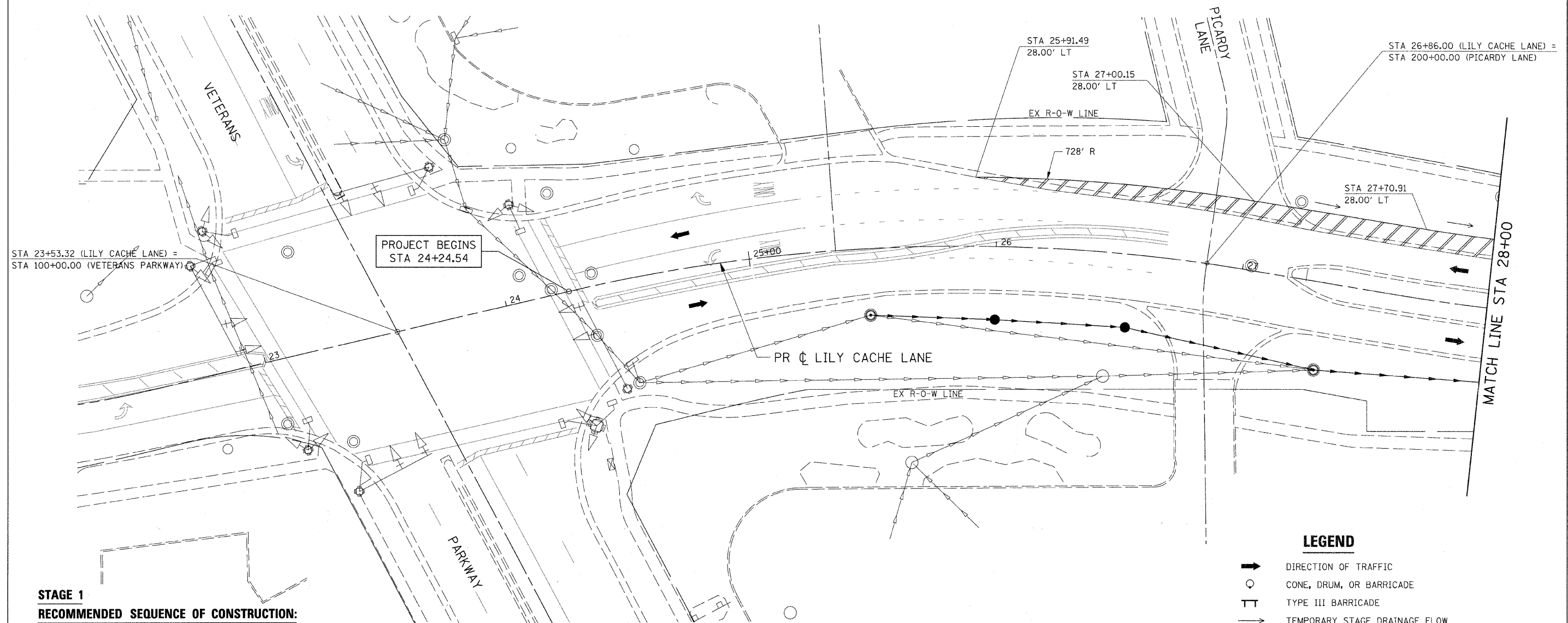
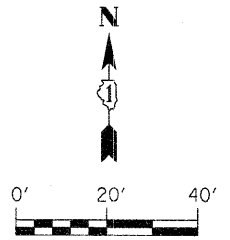

**STAGE 1
RECOMMENDED SEQUENCE OF CONSTRUCTION:**

1. PRIOR TO STAGE 1 CONSTRUCTION, THE CONTRACTOR SHALL INSTALL ALL PROPOSED STORM SEWER ITEMS SHOWN IN STAGE 1 PLANS. EXISTING STORM SEWER SHALL BE COORDINATED WITH PROPOSED STORM SEWER PLACEMENT SUCH THAT DRAINAGE IS ADEQUATELY MAINTAINED.
2. MAINTAIN ALL TRAFFIC IN EXISTING LOCATIONS.
3. CONTRACTOR SHALL PLACE ALL ADVANCED WARNING SIGNAGE PRIOR TO BEGINNING ANY CONSTRUCTION IN ACCORDANCE WITH STANDARD 701501.
4. REMOVE EXISTING CURB AND GUTTER AND CONSTRUCT THE PROPOSED TEMPORARY WIDENING AS SHOWN ON THE PLANS.

LEGEND

- ➔ DIRECTION OF TRAFFIC
- CONE, DRUM, OR BARRICADE
- TT TYPE III BARRICADE
- ➔ TEMPORARY STAGE DRAINAGE FLOW
- ▨ STAGE CONSTRUCTION LIMITS
- ▨ TEMPORARY PAVEMENT
- ▨ TEMPORARY PAVEMENT REMOVAL
- ① TEMP. PAVEMENT MARKING - LINE 4" (WHITE)
- ② TEMP. PAVEMENT MARKING - LINE 4" (YELLOW)
- ③ TEMP. PAVEMENT MARKING - LINE 4" (DOUBLE YELLOW)
- ④ TEMP. PAVEMENT MARKING - LINE 6" (WHITE)
- ⑤ TEMP. PAVEMENT MARKING - LINE 12" (YELLOW)
- ⑥ TEMP. PAVEMENT MARKING - LINE 24" (WHITE)
- ⑦ TEMP. PAVEMENT MARKING - LETTERS & SYMBOLS

FILE NAME = G:\S09021\CADD_Sheets\9021M071-01.dgn	USER NAME = IE Consultants	DESIGNED -	REVISED -
		DRAWN -	REVISED -
		CHECKED -	REVISED -
		DATE - 10/22/2010	REVISED -

**STATE OF ILLINOIS
DEPARTMENT OF TRANSPORTATION**

**SUGGESTED STAGING PLAN
STAGE 1 - LILY CACHE LANE**

SCALE: SHEET NO. OF SHEETS STA. 24+24.54 TO STA. 28+00

F.A.U.	SECTION	COUNTY	TOTAL SHEETS	SHEET NO.
1578	06-00046-01-PV	WILL	244	83
ILLINOIS FED. AID PROJECT			CONTRACT NO. 63503	