

PLAN	SUBMITTED	DATE
NOTE BOOK	PLOTTED	BY
NO.	CHECKED	
	AT 10:00 AM	
	FILE NAME	

PROFILE	SUBMITTED	DATE
NOTE BOOK	PLOTTED	BY
NO.	CHECKED	
	AT 10:00 AM	
	FILE NAME	

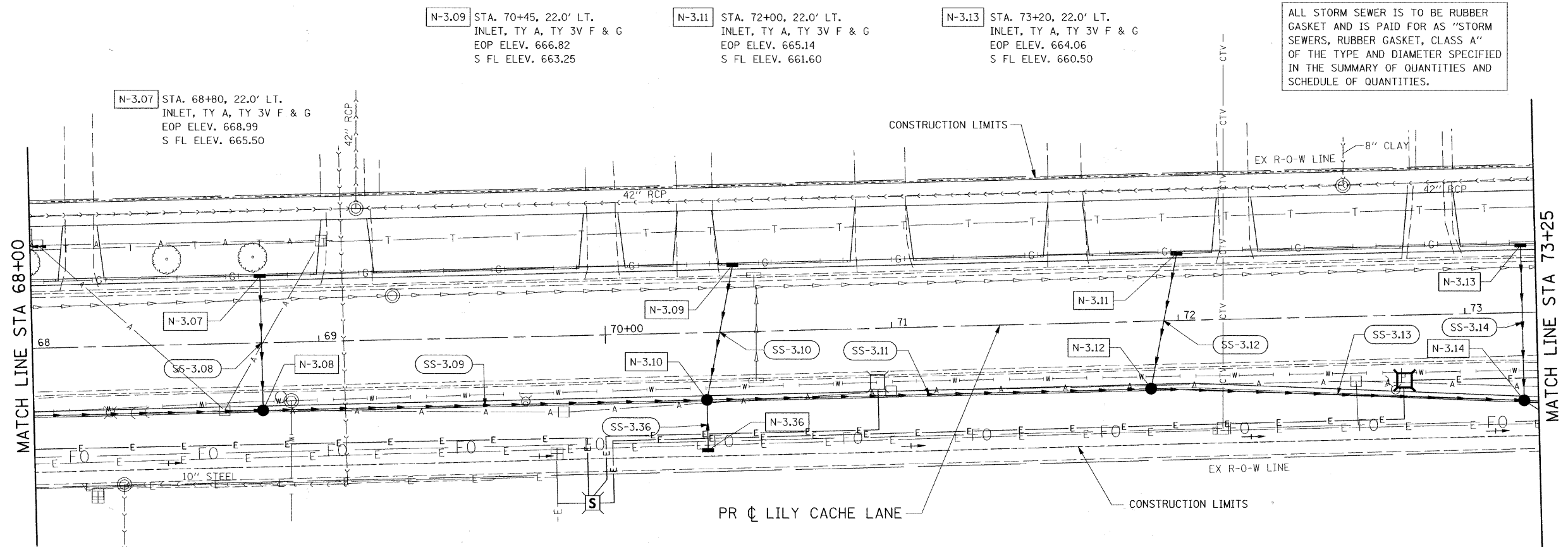

ALL STORM SEWER IS TO BE RUBBER GASKET AND IS PAID FOR AS "STORM SEWERS, RUBBER GASKET, CLASS A" OF THE TYPE AND DIAMETER SPECIFIED IN THE SUMMARY OF QUANTITIES AND SCHEDULE OF QUANTITIES.

- N-3.07 STA. 68+80, 22.0' LT. INLET, TY A, TY 3V F & G EOP ELEV. 668.99 S FL ELEV. 665.50
- N-3.08 STA. 68+80, 22.0' RT. CATCH BASIN, TY D (5' DIA) TY 15 FRAME & LID EOP ELEV. 668.99 N FL ELEV. 664.90 E FL ELEV. 661.05 W FL ELEV. 661.15
- N-3.09 STA. 70+45, 22.0' LT. INLET, TY A, TY 3V F & G EOP ELEV. 666.82 S FL ELEV. 663.25
- N-3.10 STA. 70+35, 22.0' RT. CATCH BASIN, TY D (5' DIA) TY 15 FRAME & LID EOP ELEV. 666.92 N FL ELEV. 662.75 E FL ELEV. 660.10 W FL ELEV. 660.20 S FL ELEV. 663.00
- N-3.11 STA. 72+00, 22.0' LT. INLET, TY A, TY 3V F & G EOP ELEV. 665.14 S FL ELEV. 661.60
- N-3.12 STA. 71+90, 22.0' RT. CATCH BASIN, TY D (5' DIA) TY 15 FRAME & LID EOP ELEV. 665.24 N FL ELEV. 661.10 E FL ELEV. 659.15 W FL ELEV. 659.25
- N-3.13 STA. 73+20, 22.0' LT. INLET, TY A, TY 3V F & G EOP ELEV. 664.06 S FL ELEV. 660.50
- N-3.14 STA. 73+20, 29.25' RT. CATCH BASIN, TY D (5' DIA) TY 15 FRAME & LID EOP ELEV. 663.92 N FL ELEV. 659.90 E FL ELEV. 658.55 W FL ELEV. 658.65 SE FL ELEV. 660.50
- SS-3.08 12" RCCP TY 1, CLASS A 47' @ 1.28%
- SS-3.09 36" RCCP TY 2, CLASS A 155' @ 0.55%
- SS-3.10 12" RCCP TY 1, CLASS A 48' @ 1.04%
- SS-3.11 36" RCCP TY 2, CLASS A 155' @ 0.55%
- SS-3.12 12" RCCP TY 1, CLASS A 48' @ 1.04%
- SS-3.13 36" RCCP TY 2, CLASS A 155' @ 0.55%
- SS-3.14 12" RCCP TY 1, CLASS A 54' @ 1.11%
- SS-3.15 12" RCCP TY 1, CLASS A 18' @ 1.43%

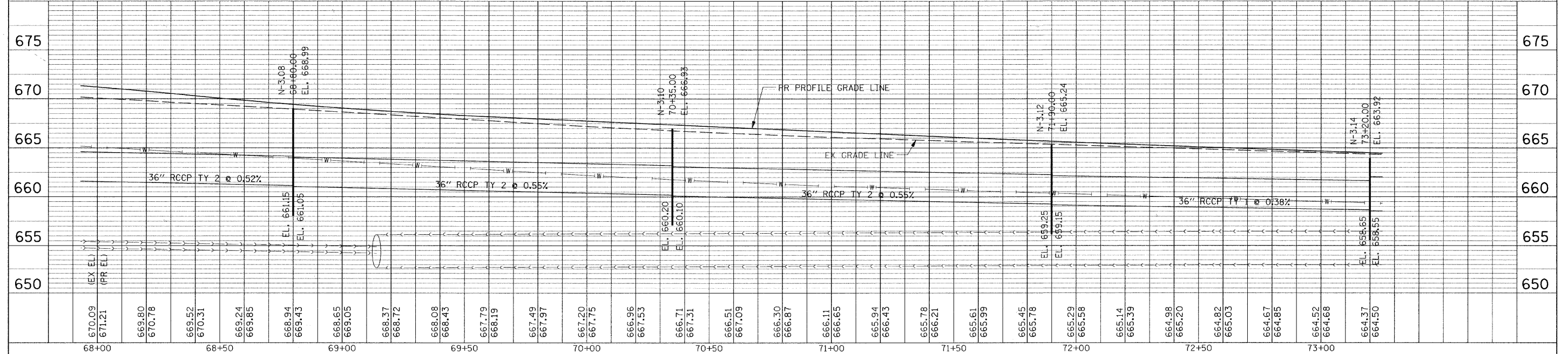

FILE NAME = G:\S09021\CADD_Sheets\9021D\P18.dgn	USER NAME = JE Consultants	DESIGNED -	REVISED -	<b>STATE OF ILLINOIS DEPARTMENT OF TRANSPORTATION</b>	<b>LILY CACHE LANE DRAINAGE AND UTILITY PLAN</b>			F.A.U. RTE. 1578	SECTION 06-00046-01-PV	COUNTY WILL	TOTAL SHEETS 244	SHEET NO. 153
PLLOT SCALE = 20.0000' / IN.	PLLOT DATE = 11/16/2010	DRAWN -	REVISED -		SCALE:	SHEET NO. OF SHEETS	STA. 68+00 TO STA. 73+25	CONTRACT NO. 63503				
		CHECKED -	REVISED -		ILLINOIS FED. AID PROJECT							
		DATE -	REVISED -									