

**EXISTING EQUIPMENT LEGEND**

- ▷ EXISTING SIGNAL HEAD
- EXISTING SERVICE INSTALLATION
- EXISTING SIGNAL POST AND FOUNDATION
- EXISTING STEEL MAST ARM POLE AND FOUNDATION
- ⊠ "E" EXISTING CONTROLLER AND FOUNDATION
- ⊠ EXISTING HANDHOLE
- EXISTING PEDESTRIAN SIGNAL HEAD
- ⊙ EXISTING PEDESTRIAN PUSHBUTTON
- ▷ EXISTING EMERGENCY VEHICLE LIGHT DETECTOR
- ▷ EXISTING CONFIRMATION BEACON
- ⊠ "E" EXISTING HEAVY-DUTY HANDHOLE
- EXISTING STEEL COMBINATION MAST ARM ASSEMBLY AND POLE AND FOUNDATION
- ⊠ "E" EXISTING VIDEO DETECTOR

**RESTORATION OF WORK AREA**

RESTORATION OF TRAFFIC SIGNAL WORK AREA SHALL BE INCIDENTAL TO THE RELATED PAY ITEM SUCH AS FOUNDATION, CONDUIT, HANDHOLE, TRENCH AND BACKFILL, ETC., AND NO EXTRA COMPENSATION SHALL BE ALLOWED. ALL ROADWAY SURFACES SUCH AS SHOULDERS, MEDIANS, SIDEWALKS, PAVEMENT, ETC. SHALL BE REPLACED IN KIND. ALL DAMAGE TO MOWED LAWNS SHALL BE REPLACED WITH AN APPROVED SOD, AND ALL DAMAGE TO UNMOWED FIELDS SHALL BE SEED IN ACCORDANCE WITH STANDARD SPECIFICATIONS 252 AND 250 RESPECTIVELY.

**STAGE 2 TEMPORARY SIGNAL NOTES**

1. USE THE EXISTING CONTROLLER AND DISCONNECT THE SIGNAL FEEDS TO THE COVERED SIGNAL HEAD OR SECTIONS.
2. USE THE EXISTING CONTROLLER PHASING EXCEPT TURN OFF THE WESTBOUND LEFT TURN PHASE AND THE WESTBOUND RIGHT TURN OVERLAP.
3. INSTALL A NEW 3 SECTION SIGNAL HEAD ON THE NORTHWEST MAST ARM AND CONNECT IT TO THE ADJACENT SIGNAL HEAD WITH #14 7C CABLE.
4. INSTALL THE TEMPORARY SIGNALS AND VIDEO DETECTION AS SHOWN IN THE PLANS AND ATTACH THE TEMPORARY CABLES TO THE EXISTING POWER POLE NEXT TO THE CONTROLLER. RUN THE TEMPORARY CABLE IN 2" CONDUIT DOWN THE POWER POLE AND INTO THE SIDE OF THE CONTROLLER CABINET. CONNECT THE WIRING TO THE APPROPRIATE TERMINALS. SEAL THE TOP OF THE CONDUIT ON THE POWER POLE. ESTABLISH DIRECTION ZONES AS DIRECTED BY THE ENGINEER.
5. COVER THE EXISTING SIGNAL HEADS OR SECTIONS OF SIGNAL HEADS AS SHOWN.
6. INSTALL R3-2 24"x24" NO LEFT TURN SIGNS ON THE NORTHWEST MAST ARM BETWEEN THE TWO FIVE SECTION HEADS AND UNDER THE COVERED LEFT TURN SIGNAL ON THE SOUTHWEST SIGNAL POLE.

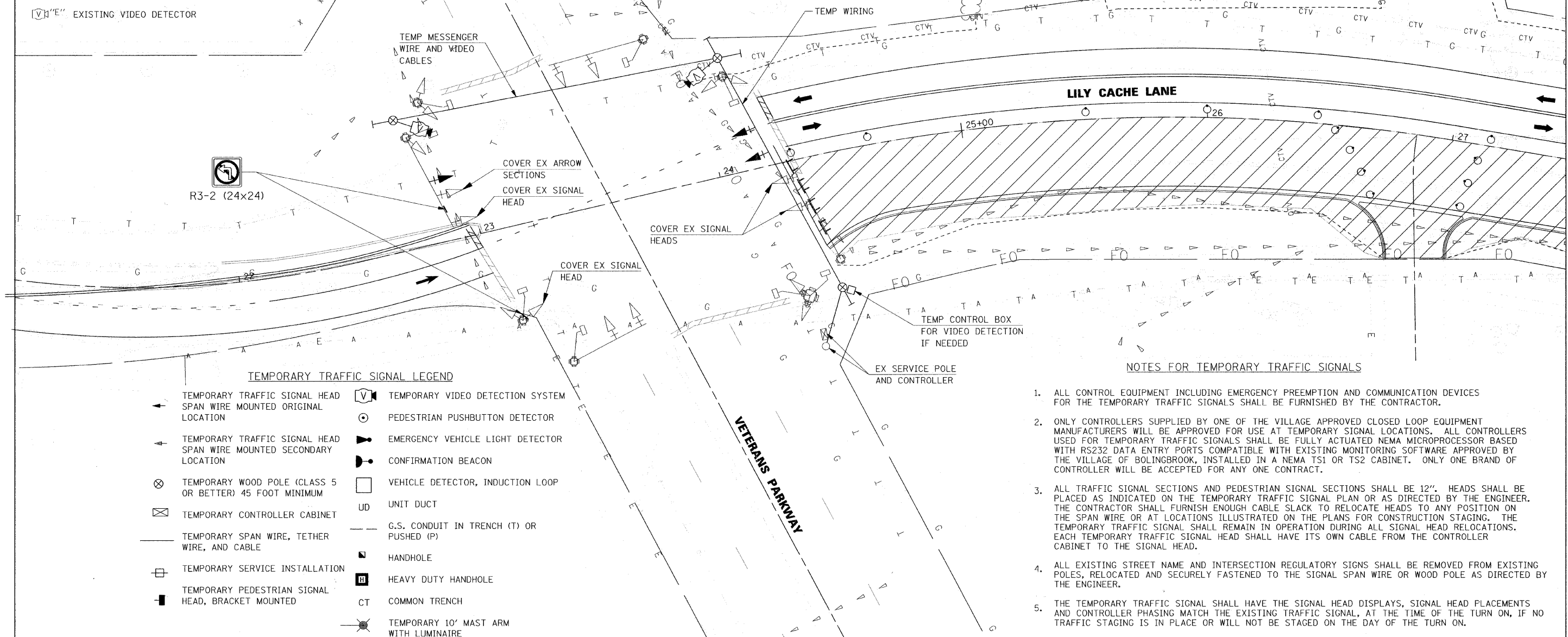

**TEMPORARY TRAFFIC SIGNAL LEGEND**

- ▷ TEMPORARY TRAFFIC SIGNAL HEAD SPAN WIRE MOUNTED ORIGINAL LOCATION
- ▷ TEMPORARY TRAFFIC SIGNAL HEAD SPAN WIRE MOUNTED SECONDARY LOCATION
- ⊗ TEMPORARY WOOD POLE (CLASS 5 OR BETTER) 45 FOOT MINIMUM
- ⊠ TEMPORARY CONTROLLER CABINET
- TEMPORARY SPAN WIRE, TETHER WIRE, AND CABLE
- TEMPORARY SERVICE INSTALLATION
- ▬ TEMPORARY PEDESTRIAN SIGNAL HEAD, BRACKET MOUNTED
- ⊠ TEMPORARY VIDEO DETECTION SYSTEM
- ⊙ PEDESTRIAN PUSHBUTTON DETECTOR
- ▷ EMERGENCY VEHICLE LIGHT DETECTOR
- ▷ CONFIRMATION BEACON
- VEHICLE DETECTOR, INDUCTION LOOP
- UD UNIT DUCT
- G.S. CONDUIT IN TRENCH (T) OR PUSHED (P)
- ⊠ HANDHOLE
- ⊠ HEAVY DUTY HANDHOLE
- CT COMMON TRENCH
- ⊗ TEMPORARY 10' MAST ARM WITH LUMINAIRE

**NOTES FOR TEMPORARY TRAFFIC SIGNALS**

1. ALL CONTROL EQUIPMENT INCLUDING EMERGENCY PREEMPTION AND COMMUNICATION DEVICES FOR THE TEMPORARY TRAFFIC SIGNALS SHALL BE FURNISHED BY THE CONTRACTOR.
2. ONLY CONTROLLERS SUPPLIED BY ONE OF THE VILLAGE APPROVED CLOSED LOOP EQUIPMENT MANUFACTURERS WILL BE APPROVED FOR USE AT TEMPORARY SIGNAL LOCATIONS. ALL CONTROLLERS USED FOR TEMPORARY TRAFFIC SIGNALS SHALL BE FULLY ACTUATED NEMA MICROPROCESSOR BASED WITH RS232 DATA ENTRY PORTS COMPATIBLE WITH EXISTING MONITORING SOFTWARE APPROVED BY THE VILLAGE OF BOLINGBROOK, INSTALLED IN A NEMA TS1 OR TS2 CABINET. ONLY ONE BRAND OF CONTROLLER WILL BE ACCEPTED FOR ANY ONE CONTRACT.
3. ALL TRAFFIC SIGNAL SECTIONS AND PEDESTRIAN SIGNAL SECTIONS SHALL BE 12". HEADS SHALL BE PLACED AS INDICATED ON THE TEMPORARY TRAFFIC SIGNAL PLAN OR AS DIRECTED BY THE ENGINEER. THE CONTRACTOR SHALL FURNISH ENOUGH CABLE SLACK TO RELOCATE HEADS TO ANY POSITION ON THE SPAN WIRE OR AT LOCATIONS ILLUSTRATED ON THE PLANS FOR CONSTRUCTION STAGING. THE TEMPORARY TRAFFIC SIGNAL SHALL REMAIN IN OPERATION DURING ALL SIGNAL HEAD RELOCATIONS. EACH TEMPORARY TRAFFIC SIGNAL HEAD SHALL HAVE ITS OWN CABLE FROM THE CONTROLLER CABINET TO THE SIGNAL HEAD.
4. ALL EXISTING STREET NAME AND INTERSECTION REGULATORY SIGNS SHALL BE REMOVED FROM EXISTING POLES, RELOCATED AND SECURELY FASTENED TO THE SIGNAL SPAN WIRE OR WOOD POLE AS DIRECTED BY THE ENGINEER.
5. THE TEMPORARY TRAFFIC SIGNAL SHALL HAVE THE SIGNAL HEAD DISPLAYS, SIGNAL HEAD PLACEMENTS AND CONTROLLER PHASING MATCH THE EXISTING TRAFFIC SIGNAL, AT THE TIME OF THE TURN ON, IF NO TRAFFIC STAGING IS IN PLACE OR WILL NOT BE STAGED ON THE DAY OF THE TURN ON.

FILE NAME =	USER NAME = JE Consultants	DESIGNED -	REVISED -
G:\S\9821\CADD_Sheets\TS & LIGHTING\dl01_Veterans_TF_01.dgn		DRAWN -	REVISED -
PLOT SCALE = 20,0000' / IN.		CHECKED -	REVISED -
PLOT DATE = 11/16/2010		DATE -	REVISED -

**STATE OF ILLINOIS  
DEPARTMENT OF TRANSPORTATION**

**LILY CACHE LANE AT VETERANS PARKWAY  
TEMPORARY TRAFFIC SIGNAL PLAN - STAGE 2**

SCALE: SHEET NO. OF SHEETS STA. TO STA.

F.A.U.	SECTION	COUNTY	TOTAL SHEETS	SHEET NO.
1578	06-00046-01-PV	WILL	244	193A
CONTRACT NO. 63503				
ILLINOIS FED. AID PROJECT				