

DATE	
BY	
PLAN	
NO.	
NO. OF SHEETS	
NO. OF PAGES	
NO. OF FIGS.	
NO. OF CADD FILES	

DATE	
BY	
PROFILE	
NO.	
NO. OF SHEETS	
NO. OF PAGES	
NO. OF FIGS.	
NO. OF CADD FILES	

COMPANY NAME: SEC GROUP, INC.
 PROJECT CONTACT: A. JAIN
 ADDRESS: VILLAGE OF CARPENTERSVILLE
 400 N. POPE AVENUE
 CARPENTERSVILLE, IL 61813
 PHONE: 618-241-1100
 FAX: 618-241-1101
 EMAIL: a.jain@secgroup.com

396 MH TA 4' DIA TI F&CL
 STA = 317+48, 10' RT
 RIM = 912.16
 INV = 904.60 S
 INV = 905.00 N
 INV = 908.04 W
 INV = 909.55 E

397 24 LIN FT STORM SEW WM
 REO 12" @ 1.1%

398 INLET TA TIIV F&G
 STA = 317+48, 15' LT
 RIM = 912.01
 INV = 908.30

399 4 LIN FT SS CL A 1 12" @ 3.3%

400 CB TA 4' DIA TIIV F&G
 STA = 317+48, 15' RT
 RIM = 912.11
 INV = 909.63 SE

401 OMITTED

402 OMITTED

403 OMITTED

404 OMITTED

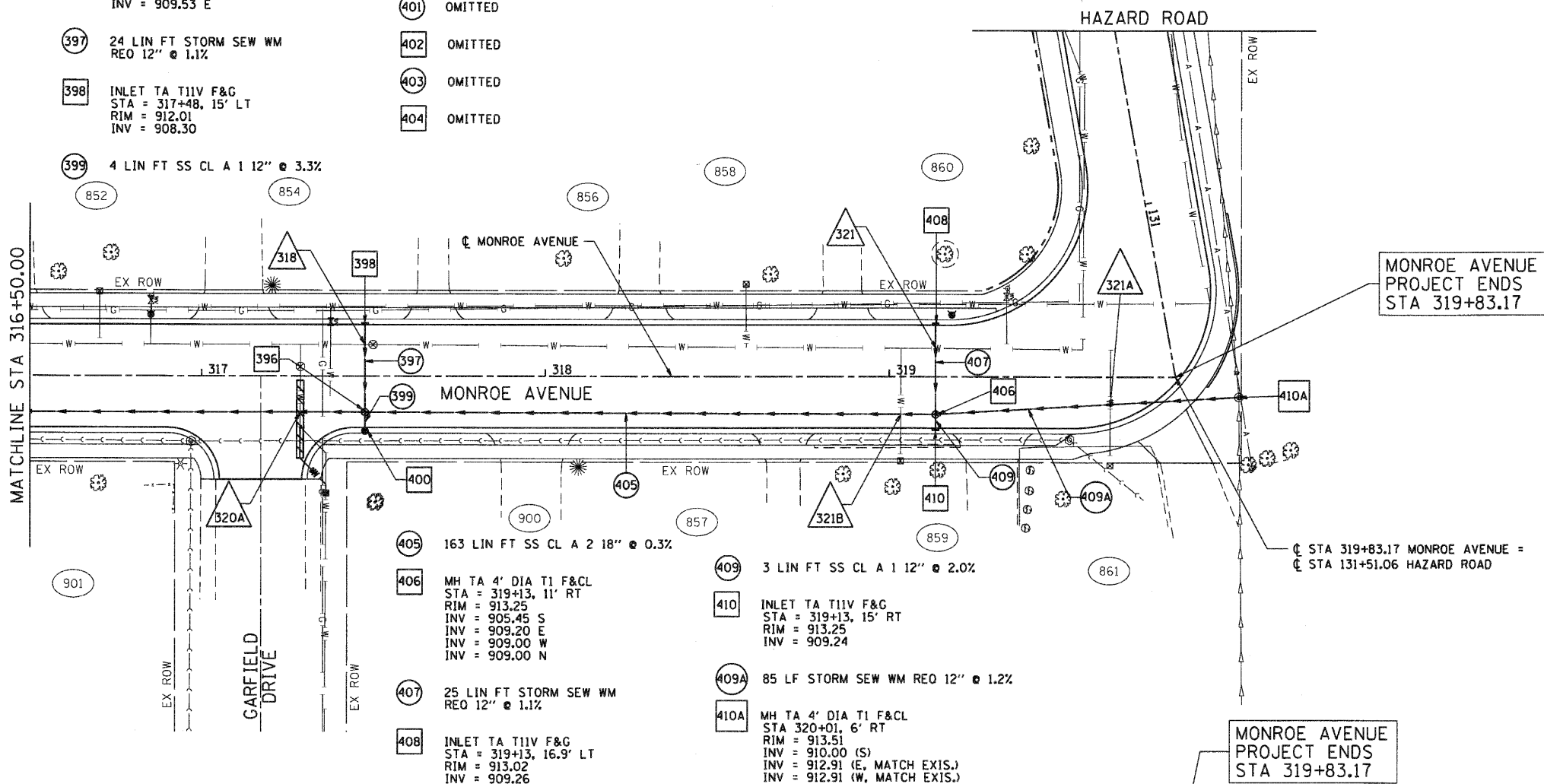

- 318 TOP OF WM PIPE = 906.50
BOTTOM OF SS PIPE = 908.24
CLEARANCE = 1.74'
- 319 OMITTED
- 320 OMITTED
- 320A TOP OF EX WM PIPE = 902.78
BOTTOM OF SS PIPE = 904.28
CLEARANCE = 1.5'
(ADJUSTING WATER MAIN 8")
- 321 TOP OF EX WM PIPE = 906.95
BOTTOM OF SS PIPE = 909.19
CLEARANCE = 2.24'
- 321A TOP OF EX WM PIPE = 907.97
BOTTOM OF SS PIPE = 909.60
CLEARANCE = 1.63'
- 321B TOP OF EX WM PIPE = 908.00
BOTTOM OF SS PIPE = 908.97
CLEARANCE = 0.97'

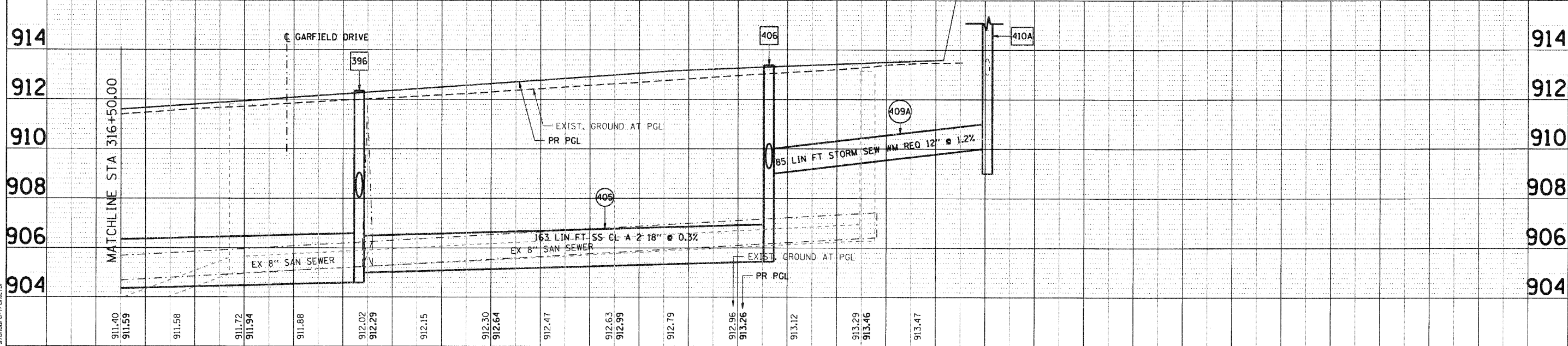
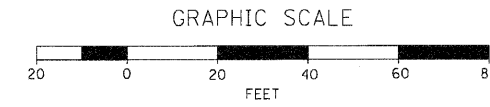

316+50	911.40	911.59	911.58	911.72	911.94	911.88	912.02	912.29	912.15	912.30	912.64	912.47	912.63	912.99	912.79	912.96	913.26	913.12	913.29	913.46	913.47	914
317+00																						914
318+00																						910
319+00																						908
																						906
																						904