

FINAL	SURVEYED	BY	DATE
SIGNATURE	PLOTTED		
NOTE BOOK	TEMPLATE		
NO.	AREAS CHECKED		

ORIGINAL	SURVEYED	BY	DATE
SIGNATURE	PLOTTED		
NOTE BOOK	TEMPLATE		
NO.	AREAS CHECKED		

COMPANY NAME: SEC GROUP, INC.
 PROJECT CONTACT: A. JAIN
 CLIENT: VILLAGE OF CARPENTERSVILLE
 DATE PLOTTED: 11/22/2010 12:05:15 PM
 PLOT DRIVER: 890256-1SEC-GOLF.dgn
 PEN TABLE: 616order.ctb-trans.tbl

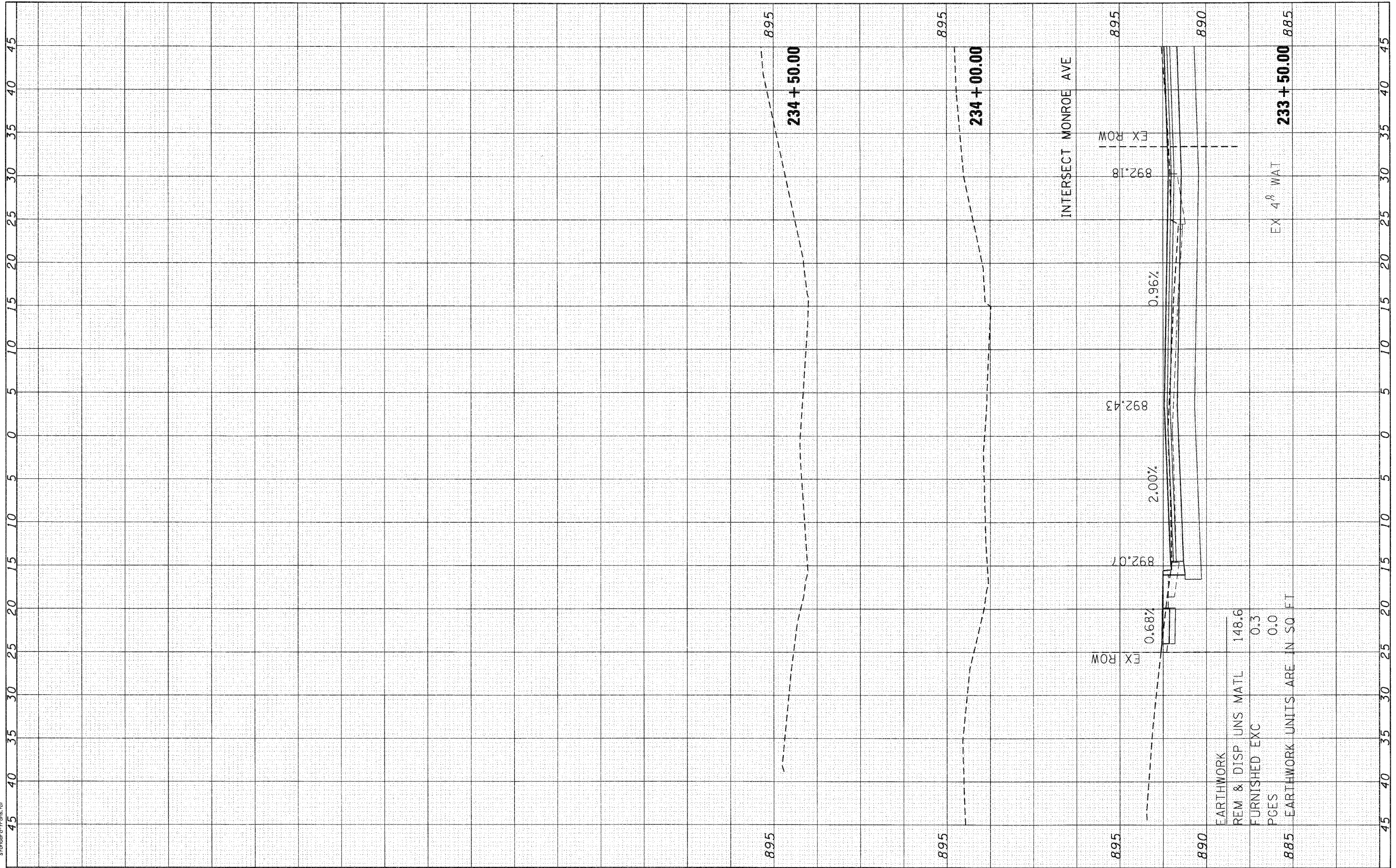

SEC Group, Inc.
 A 100% Group Company
 420 N. First Street
 Milwaukee, WI 53202-4128
 T 414.363.1778 F 414.363.1781
 www.secgroupinc.com
 *Member of the SEC Group, Inc. - New London, CT - Chicago, IL

USER NAME = CHARTKE	DESIGNED - C. HARTKE	REVISED -
PLOT SCALE = 1" = 5'	DRAWN - R. BEST	REVISED -
PLOT DATE = 11/2/2010	CHECKED - T. HAMILTON	REVISED -
	DATE - 10/25/10	REVISED -

VILLAGE OF CARPENTERSVILLE

**CROSS SECTIONS
 GOLFVIEW LANE**

SCALE: 1" = 5' SHEET NO. 34 OF 34 SHEETS STA. 233+50.00 TO STA. 234+50.00

F.A. RTE.	SECTION	COUNTY	TOTAL SHEETS	SHEET NO.
*	06-00074-00-FP	KANE	211	160
* FAU 2414, FAU 1280, FAP 343			CONTRACT NO. 63504	
FED. ROAD DIST. NO. [ILLINOIS] FED. AID PROJECT			63504	