

CONCRETE MEDIAN, TYPE SB-9.12

AT MEDIAN NOSES

NOTE: CONCRETE MEDIAN, TYPE SB-9.12 SHALL BE CONSTRUCTED IN ACCORDANCE WITH APPLICABLE PORTIONS OF STANDARD 606301

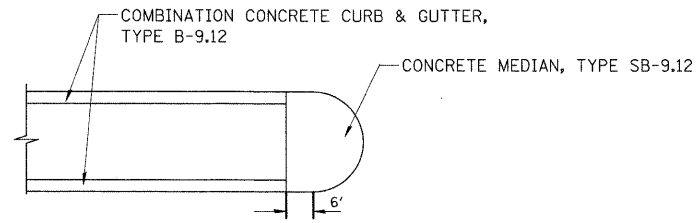

CONCRETE MEDIAN, TYPE SB-9.12 (POURED MONOLITHICALLY WITH WIDENING)

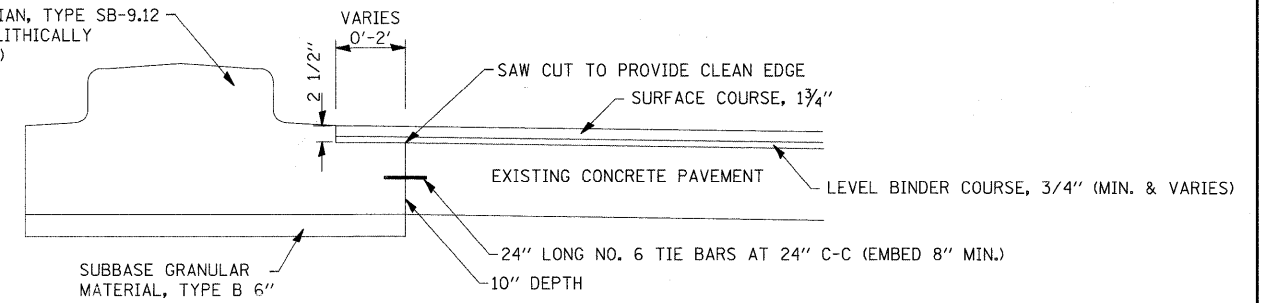

CONCRETE MEDIAN, TYPE SB-9.12

AT LOCATIONS WHERE WIDENING IS 2' OR LESS

CONCRETE MEDIAN, TYPE SB-6.12 (SPECIAL)

AT MEDIAN NOSES

NOTE: CONCRETE MEDIAN, TYPE SB-6.12 SHALL BE CONSTRUCTED IN ACCORDANCE WITH APPLICABLE PORTIONS OF STANDARD 606301

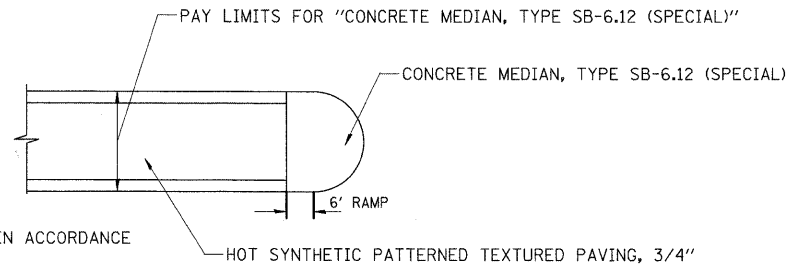

COMB. CONC. CURB AND GUTTER, TYPE B-9.12 (POURED MONOLITHICALLY WITH WIDENING)

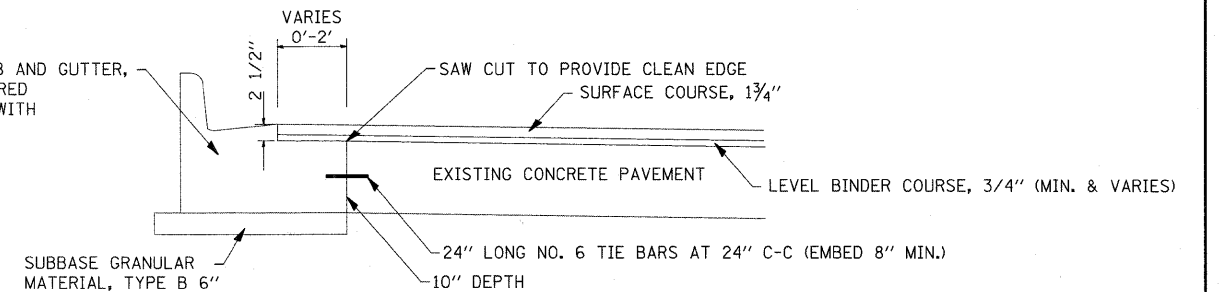

COMBINATION CONCRETE CURB AND GUTTER, TYPE B-9.12

AT LOCATIONS WHERE WIDENING IS 2' OR LESS

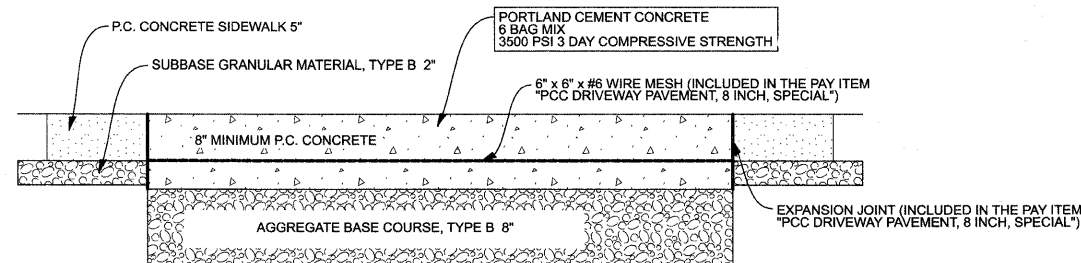
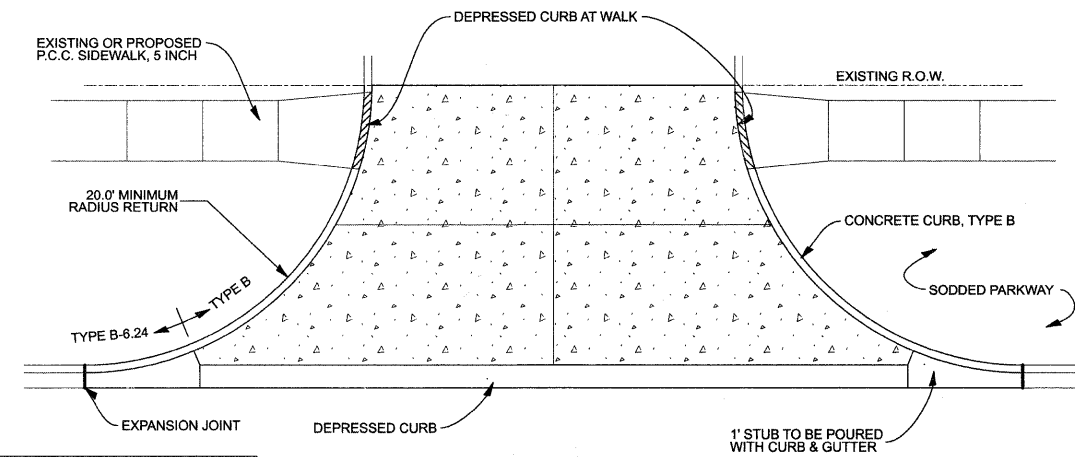
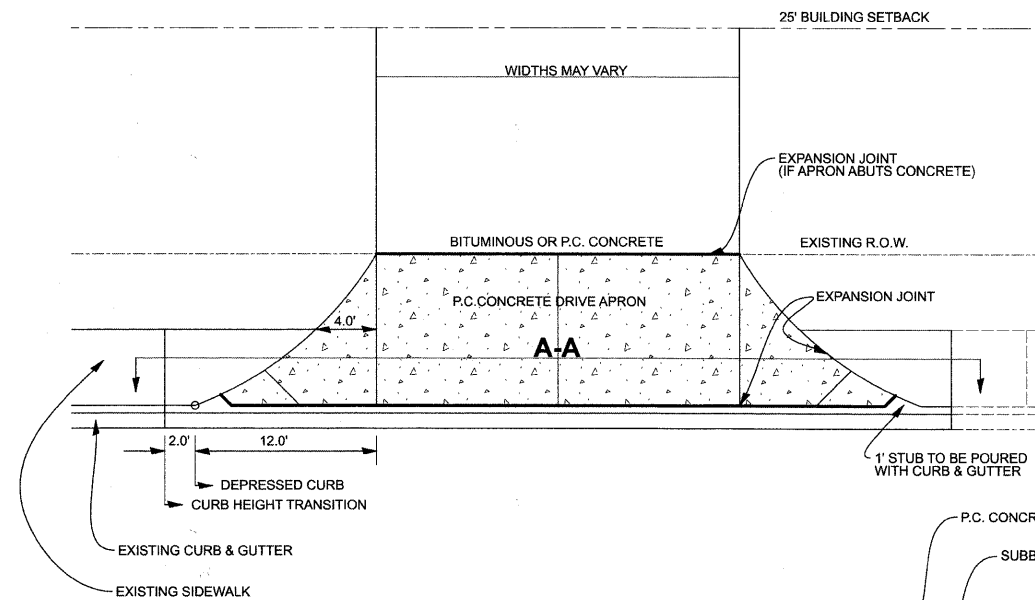

SECTION A-A

DRIVEWAY DETAIL

NOT TO SCALE

FILE NAME = .../sheet/2363_detail.01.dgn	USER NAME = djk	DESIGNED - BLG	REVISED -
		DRAWN - BLG	REVISED -
		CHECKED - DJK	REVISED -
		DATE - 10-22-10	REVISED -

**STATE OF ILLINOIS
DEPARTMENT OF TRANSPORTATION**

ROADWAY DETAILS

SHEET NO. 1 OF 4 SHEETS

F.A.P. RTE.	SECTION	COUNTY	TOTAL SHEETS	SHEET NO.
334	09-00057-00-CH	COOK	103	70
CONTRACT NO. 63523				
FED. ROAD DIST. NO. 1 ILLINOIS FED. AID PROJECT M-9003(660)				