

DATE: _____ BY: _____
 SURVEYED: _____ GRADES CHECKED: _____
 ALIGNED: _____ PLANT CHECKED: _____
 P.T. OF WAY CHECKED: _____
 CADD FILE NAME: _____

DATE: _____ BY: _____
 SURVEYED: _____ GRADES CHECKED: _____
 ALIGNED: _____ PLANT CHECKED: _____
 P.T. OF WAY CHECKED: _____
 CADD FILE NAME: _____

PLAN
 NOTE BOOK NO. _____
 NO. _____

PROFILE
 NOTE BOOK NO. _____
 NO. _____

DATE: _____ BY: _____
 SURVEYED: _____ GRADES CHECKED: _____
 ALIGNED: _____ PLANT CHECKED: _____
 P.T. OF WAY CHECKED: _____
 CADD FILE NAME: _____

DATE: _____ BY: _____
 SURVEYED: _____ GRADES CHECKED: _____
 ALIGNED: _____ PLANT CHECKED: _____
 P.T. OF WAY CHECKED: _____
 CADD FILE NAME: _____

DATE: _____ BY: _____
 SURVEYED: _____ GRADES CHECKED: _____
 ALIGNED: _____ PLANT CHECKED: _____
 P.T. OF WAY CHECKED: _____
 CADD FILE NAME: _____

DATE: _____ BY: _____
 SURVEYED: _____ GRADES CHECKED: _____
 ALIGNED: _____ PLANT CHECKED: _____
 P.T. OF WAY CHECKED: _____
 CADD FILE NAME: _____

DATE: _____ BY: _____
 SURVEYED: _____ GRADES CHECKED: _____
 ALIGNED: _____ PLANT CHECKED: _____
 P.T. OF WAY CHECKED: _____
 CADD FILE NAME: _____

DATE: _____ BY: _____
 SURVEYED: _____ GRADES CHECKED: _____
 ALIGNED: _____ PLANT CHECKED: _____
 P.T. OF WAY CHECKED: _____
 CADD FILE NAME: _____

DATE: _____ BY: _____
 SURVEYED: _____ GRADES CHECKED: _____
 ALIGNED: _____ PLANT CHECKED: _____
 P.T. OF WAY CHECKED: _____
 CADD FILE NAME: _____

DATE: _____ BY: _____
 SURVEYED: _____ GRADES CHECKED: _____
 ALIGNED: _____ PLANT CHECKED: _____
 P.T. OF WAY CHECKED: _____
 CADD FILE NAME: _____

THE FOLLOWING ITEMS SHALL BE REMOVED BY THE CONTRACTOR AND SHALL BE DISPOSED OF BY THEM OUTSIDE THE RIGHT-OF-WAY AT THEIR EXPENSE. THE SALVAGE VALUE OF THE REMOVED EQUIPMENT SHALL BE REFLECTED IN THE CONTRACT BID PRICE.

- 1 EACH CONTROLLER AND CONFLICT MONITOR

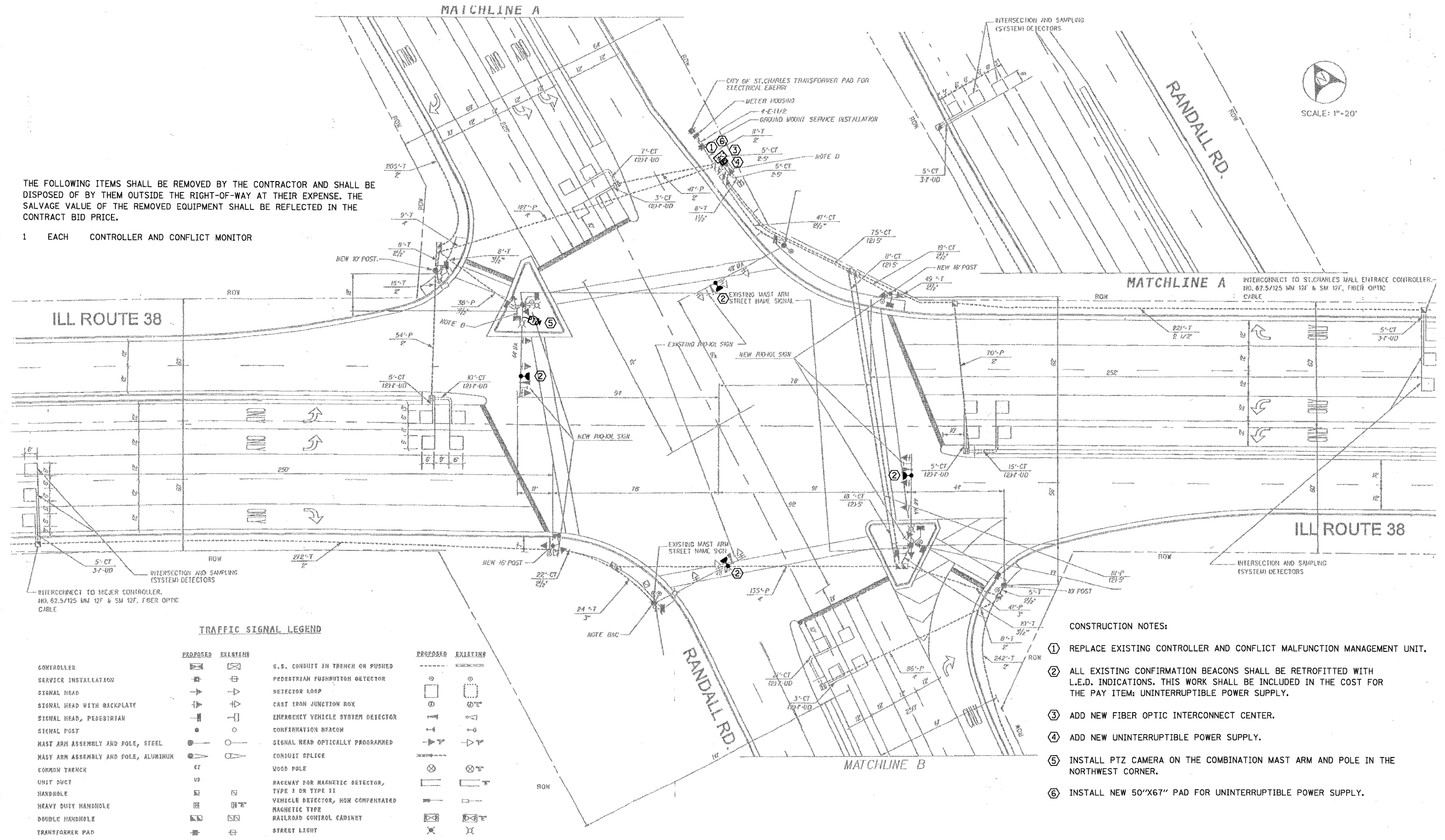

SCALE: 1"=20'

TRAFFIC SIGNAL LEGEND

	PROPOSED	EXISTING		PROPOSED	EXISTING
CONTROLLER	[Symbol]	[Symbol]	G.S. CONDUIT IN TRENCH OR PUSHED	[Symbol]	[Symbol]
SERVICE INSTALLATION	[Symbol]	[Symbol]	PEDESTRIAN PUSHBUTTON DETECTOR	[Symbol]	[Symbol]
SIGNAL HEAD	[Symbol]	[Symbol]	DETECTOR LOOP	[Symbol]	[Symbol]
SIGNAL HEAD WITH BACKPLATE	[Symbol]	[Symbol]	CAST IRON JUNCTION BOX	[Symbol]	[Symbol]
SIGNAL HEAD, PEDESTRIAN	[Symbol]	[Symbol]	EMERGENCY VEHICLE SYSTEM DETECTOR	[Symbol]	[Symbol]
SIGNAL POST	[Symbol]	[Symbol]	CONFIRMATION BEACON	[Symbol]	[Symbol]
MAST ARM ASSEMBLY AND POLE, STEEL	[Symbol]	[Symbol]	SIGNAL HEAD OPTICALLY PROGRAMMED	[Symbol]	[Symbol]
MAST ARM ASSEMBLY AND POLE, ALUMINUM	[Symbol]	[Symbol]	CONDUIT SPLICE	[Symbol]	[Symbol]
CORNER TRENCH	[Symbol]	[Symbol]	WOOD POLE	[Symbol]	[Symbol]
UNIT DUCT	[Symbol]	[Symbol]	RACEWAY FOR MAGNETIC DETECTOR, TYPE I OR TYPE II	[Symbol]	[Symbol]
HANDHOLE	[Symbol]	[Symbol]	VEHICLE DETECTOR, NON COMPENSATED	[Symbol]	[Symbol]
HEAVY DUTY HANDHOLE	[Symbol]	[Symbol]	MAGNETIC TYPE	[Symbol]	[Symbol]
DOUBLE HANDHOLE	[Symbol]	[Symbol]	RAILROAD CONTROL CABINET	[Symbol]	[Symbol]
TRANSFORMER PAD	[Symbol]	[Symbol]	STREET LIGHT	[Symbol]	[Symbol]
METER HOUSE	[Symbol]	[Symbol]			

- CONSTRUCTION NOTES:**
- ① REPLACE EXISTING CONTROLLER AND CONFLICT MALFUNCTION MANAGEMENT UNIT.
 - ② ALL EXISTING CONFIRMATION BEACONS SHALL BE RETROFITTED WITH L.E.D. INDICATIONS. THIS WORK SHALL BE INCLUDED IN THE COST FOR THE PAY ITEM: UNINTERRUPTIBLE POWER SUPPLY.
 - ③ ADD NEW FIBER OPTIC INTERCONNECT CENTER.
 - ④ ADD NEW UNINTERRUPTIBLE POWER SUPPLY.
 - ⑤ INSTALL PTZ CAMERA ON THE COMBINATION MAST ARM AND POLE IN THE NORTHWEST CORNER.
 - ⑥ INSTALL NEW 50"X67" PAD FOR UNINTERRUPTIBLE POWER SUPPLY.

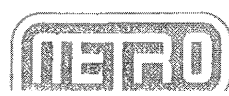

METRO TRANSPORTATION GROUP, INC.
 TRANSPORTATION PLANNING, ENGINEERING AND DESIGN

REVISIONS		
NO.	DATE	DESCRIPTION

GEOMETRIC PLAN AND SIGNAL INSTALLATION PLAN
 Illinois Route 38 @ Randall Road

FILE NAME: ra.sp.dgn	SHEET NO.: 12
DATE: MARCH 6, 2000	
PROJECT NO.: 09-00237-02-TL	

FILE NAME: N:\cancounty\080673\Traffic\015_TSD1_Randall\l38.dgn	USER NAME: FPACONE	DESIGNED: ABR	REVISED: -	STATE OF ILLINOIS DEPARTMENT OF TRANSPORTATION	TRAFFIC SIGNAL MODERNIZATION PLAN RANDALL ROAD AND IL ROUTE 38	F.A.P. RTE.: 336	SECTION: 09-00237-02-TL	COUNTY: KANE	TOTAL SHEETS: 100	SHEET NO.: 15
PLOT SCALE: NOT TO SCALE		DRAWN: FCP	REVISED: -			CONTRACT NO. 63525				
PLOT DATE: 11/3/2010		CHECKED: MJT	REVISED: -			ILLINOIS FED. AID PROJECT				
		DATE: AUGUST 31, 2010	REVISED: -							