

DATE: _____ BY: _____
 SURVEYED: _____ GRADES CHECKED: _____
 PLAN: _____ NOTE BOOK: _____
 NO. _____
CHRISTOPHER B. BURKE ENGINEERING LTD.
 3575 West Higgins Road, Suite 600
 Chicago, Illinois 60634
 (817) 823-0500

CONSTRUCTION NOTES:

- ① REPLACE EXISTING CONTROLLER AND CONFLICT MALFUNCTION MANAGEMENT UNIT.
- ② ALL EXISTING CONFIRMATION BEACONS SHALL BE RETROFITTED WITH L.E.D. INDICATIONS. THIS WORK SHALL BE INCLUDED IN THE COST FOR THE PAY ITEM: UNINTERRUPTIBLE POWER SUPPLY.
- ③ REPLACE EXISTING FIBER OPTIC INTERCONNECT CENTER.
- ④ REPLACE EXISTING UNINTERRUPTIBLE POWER SUPPLY AND CABINET ENCLOSURE.
- ⑤ UPGRADE EXISTING VIDEO DETECTION TO COMMUNICATE OVER ETHERNET.
- ⑥ INSTALL NEW 50"X67" PAD FOR EXISTING UNINTERRUPTIBLE POWER SUPPLY.

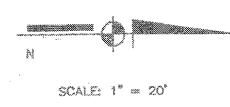
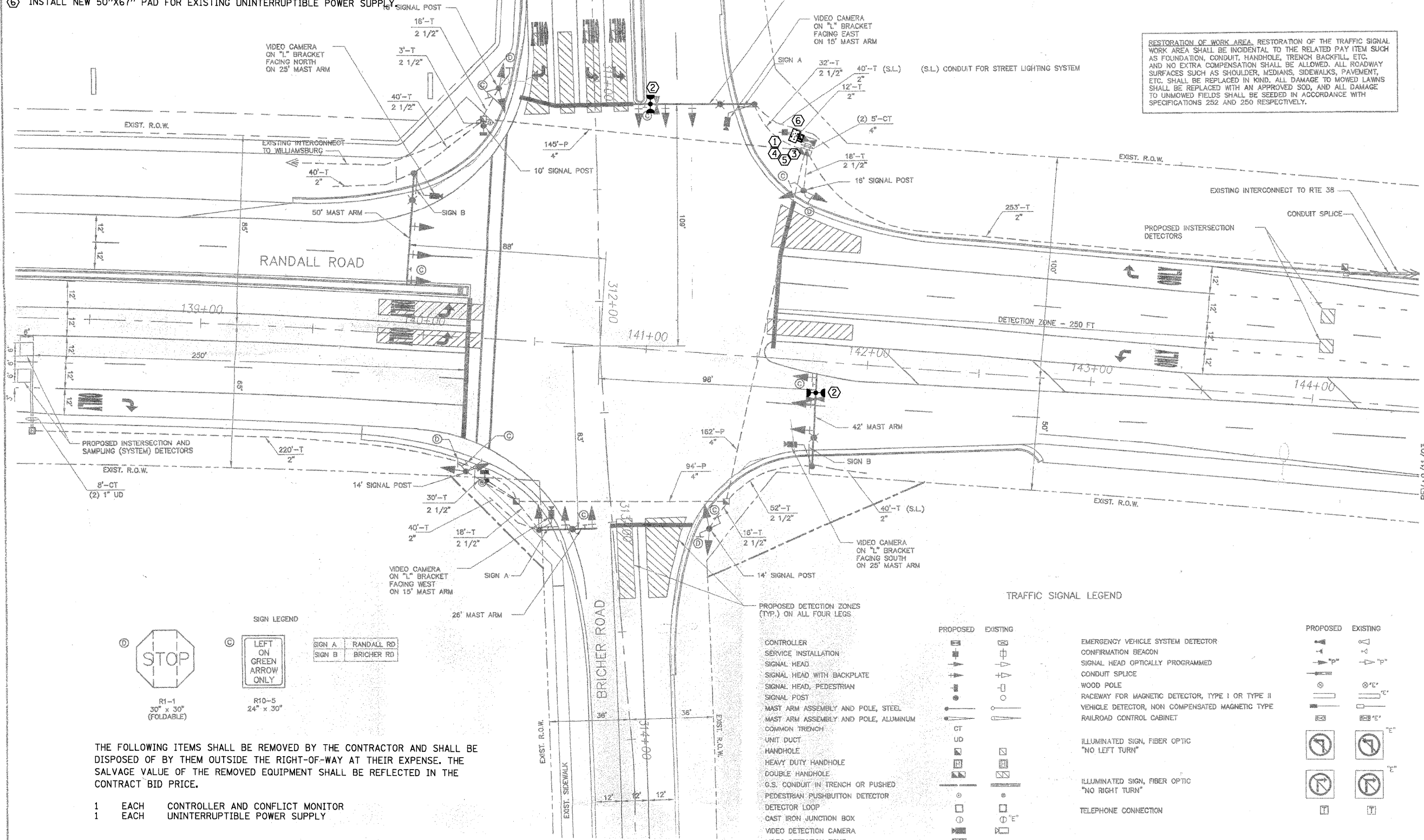

RESTORATION OF WORK AREA, RESTORATION OF THE TRAFFIC SIGNAL WORK AREA SHALL BE INCIDENTAL TO THE RELATED PAY ITEM SUCH AS FOUNDATION, CONDUIT, HANDHOLE, TRENCH BACKFILL, ETC. AND NO EXTRA COMPENSATION SHALL BE ALLOWED. ALL ROADWAY SURFACES SUCH AS SHOULDER, MEDIANS, SIDEWALKS, PAVEMENT, ETC. SHALL BE REPLACED IN KIND. ALL DAMAGE TO MOWED LAWNS SHALL BE REPLACED WITH AN APPROVED SOD, AND ALL DAMAGE TO UNMOWED FIELDS SHALL BE SEEDED IN ACCORDANCE WITH SPECIFICATIONS 252 AND 250 RESPECTIVELY.

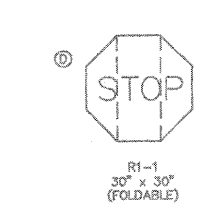

SIGN A RANDALL RD
 SIGN B BRICHER RD

THE FOLLOWING ITEMS SHALL BE REMOVED BY THE CONTRACTOR AND SHALL BE DISPOSED OF BY THEM OUTSIDE THE RIGHT-OF-WAY AT THEIR EXPENSE. THE SALVAGE VALUE OF THE REMOVED EQUIPMENT SHALL BE REFLECTED IN THE CONTRACT BID PRICE.

- 1 EACH CONTROLLER AND CONFLICT MONITOR
- 1 EACH UNINTERRUPTIBLE POWER SUPPLY

- TRAFFIC SIGNAL LEGEND**
- | | | | | |
|--------------------------------------|-----------------------------------|--|--|---|
| PROPOSED | EXISTING | EMERGENCY VEHICLE SYSTEM DETECTOR | PROPOSED | EXISTING |
| SERVICE INSTALLATION | SIGNAL HEAD | CONFIRMATION BEACON | ILLUMINATED SIGN, FIBER OPTIC "NO LEFT TURN" | ILLUMINATED SIGN, FIBER OPTIC "NO RIGHT TURN" |
| SIGNAL HEAD WITH BACKPLATE | SIGNAL HEAD, PEDESTRIAN | SIGNAL HEAD OPTICALLY PROGRAMMED | TELEPHONE CONNECTION | |
| SIGNAL POST | MAST ARM ASSEMBLY AND POLE, STEEL | CONDUIT SPLICE | | |
| MAST ARM ASSEMBLY AND POLE, ALUMINUM | COMMON TRENCH | WOOD POLE | | |
| UNIT DUCT | HANDHOLE | RACEWAY FOR MAGNETIC DETECTOR, TYPE I OR TYPE II | | |
| HANDHOLE | HEAVY DUTY HANDHOLE | VEHICLE DETECTOR, NON COMPENSATED MAGNETIC TYPE | | |
| DOUBLE HANDHOLE | G.S. CONDUIT IN TRENCH OR PUSHED | RAILROAD CONTROL CABINET | | |
| PEDESTRIAN PUSHBUTTON DETECTOR | DETECTOR LOOP | | | |
| DETECTOR LOOP | CAST IRON JUNCTION BOX | | | |
| VIDEO DETECTION CAMERA | VIDEO DETECTION ZONE | | | |

MJD ENGINEERING
 3709 NORTH OKETO
 CHICAGO, ILLINOIS 60634 (773) 625-6565
 6 OF 10
 TRAFFIC SIGNAL INSTALLATION PLAN
 RANDALL ROAD AND BRICHER ROAD
 GENEVA, ILLINOIS