

CONSTRUCTION NOTES:

- ① REPLACE EXISTING CONTROLLER AND MALFUNCTION MANAGEMENT UNIT.
- ② ALL EXISTING CONFIRMATION BEACONS SHALL BE RETROFITTED WITH L.E.D. INDICATIONS. THIS WORK SHALL BE INCLUDED IN THE COST FOR THE PAY ITEM: UNINTERRUPTIBLE POWER SUPPLY.
- ③ REPLACE EXISTING FIBER OPTIC INTERCONNECT CENTER.
- ④ REPLACE EXISTING UNINTERRUPTIBLE POWER SUPPLY AND CABINET ENCLOSURE.
- ⑤ INSTALL PTZ CAMERA ON THE COMBINATION MAST ARM AND POLE IN THE SOUTHWEST CORNER.
- ⑥ INSTALL NEW 50"X67" PAD FOR UNINTERRUPTIBLE POWER SUPPLY.
- ⑦ ADD NEW GROUNDING.

Randall Square Shopping Center access



SCALE: 1"=20'

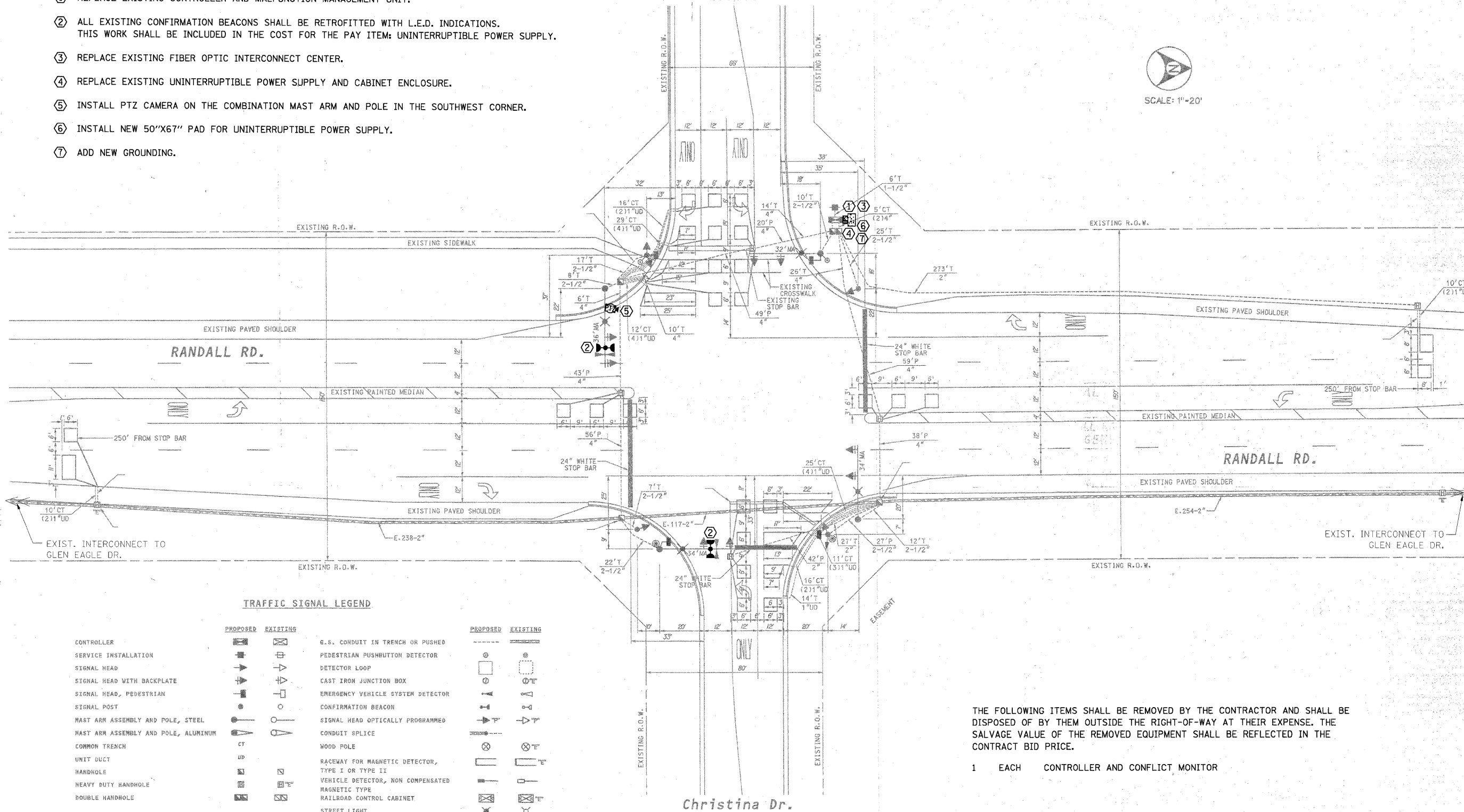

TRAFFIC SIGNAL LEGEND

	PROPOSED	EXISTING		PROPOSED	EXISTING
CONTROLLER	[Symbol]	[Symbol]	G.S. CONDUIT IN TRENCH OR PUSHED	[Symbol]	[Symbol]
SERVICE INSTALLATION	[Symbol]	[Symbol]	PEDESTRIAN PUSHBUTTON DETECTOR	[Symbol]	[Symbol]
SIGNAL HEAD	[Symbol]	[Symbol]	DETECTOR LOOP	[Symbol]	[Symbol]
SIGNAL HEAD WITH BACKPLATE	[Symbol]	[Symbol]	CAST IRON JUNCTION BOX	[Symbol]	[Symbol]
SIGNAL HEAD, PEDESTRIAN	[Symbol]	[Symbol]	EMERGENCY VEHICLE SYSTEM DETECTOR	[Symbol]	[Symbol]
SIGNAL POST	[Symbol]	[Symbol]	CONFIRMATION BEACON	[Symbol]	[Symbol]
MAST ARM ASSEMBLY AND POLE, STEEL	[Symbol]	[Symbol]	SIGNAL HEAD OPTICALLY PROGRAMMED	[Symbol]	[Symbol]
MAST ARM ASSEMBLY AND POLE, ALUMINUM	[Symbol]	[Symbol]	CONDUIT SPLICE	[Symbol]	[Symbol]
COMMON TRENCH	[Symbol]	[Symbol]	WOOD POLE	[Symbol]	[Symbol]
UNIT DUCT	[Symbol]	[Symbol]	RACEWAY FOR MAGNETIC DETECTOR, TYPE I OR TYPE II	[Symbol]	[Symbol]
HANDHOLE	[Symbol]	[Symbol]	VEHICLE DETECTOR, NON COMPENSATED	[Symbol]	[Symbol]
HEAVY DUTY HANDHOLE	[Symbol]	[Symbol]	MAGNETIC TYPE	[Symbol]	[Symbol]
DOUBLE HANDHOLE	[Symbol]	[Symbol]	RAILROAD CONTROL CABINET	[Symbol]	[Symbol]
			STREET LIGHT	[Symbol]	[Symbol]

THE FOLLOWING ITEMS SHALL BE REMOVED BY THE CONTRACTOR AND SHALL BE DISPOSED OF BY THEM OUTSIDE THE RIGHT-OF-WAY AT THEIR EXPENSE. THE SALVAGE VALUE OF THE REMOVED EQUIPMENT SHALL BE REFLECTED IN THE CONTRACT BID PRICE.

- 1 EACH CONTROLLER AND CONFLICT MONITOR



METRO TRANSPORTATION GROUP, INC.
 TRANSPORTATION PLANNING, ENGINEERING AND DESIGN
 1300 GREENBROOK, HANOVER PARK, IL 60103 PH# 630 213-1000

REVISIONS	
NO.	DESCRIPTION

SIGNAL INSTALLATION PLAN and GEOMETRIC PLAN
 RANDALL ROAD @ CHRISTINA DRIVE
 GENEVA, ILLINOIS

FILE NAME: 3517_ep.dgn	SHEET NO.: 4
DATE: MAY 22, 1998	01 08
PROJECT NO.: 3517-00	

FILE NAME = N:\kanecounty\880673\Traffic\026_TSD_Randall\christina.dgn	USER NAME = FPAICONE	DESIGNED - ABR	REVISED -	STATE OF ILLINOIS DEPARTMENT OF TRANSPORTATION	TRAFFIC SIGNAL MODERNIZATION PLAN RANDALL ROAD AND CHRISTINA LANE	F.A.P. R.T.E. 336	SECTION 09-00237-02-TL	COUNTY KANE	TOTAL SHEETS 100	SHEET NO. 26	
PLOT SCALE = NOT TO SCALE	CHECKED - MJT	REVISOR -				SCALE:	SHEET NO. OF SHEETS	STA. --	TO STA. --	CONTRACT NO. 63525	ILLINOIS FED. AID PROJECT
PLOT DATE = 11/3/2010	DATE - AUGUST 31, 2010	REVISOR -									

PROFILE SURVEYED: [] GRADES CHECKED: [] B.M. NOTED: [] STRUCTURE NOTATION: []
 PLAN SURVEYED: [] ALIGNMENT CHECKED: [] FIT. OF WAY CHECKED: []
 DATE: [] BY: []
CHRISTOPHER B. BURKE ENGINEERING LTD.
 3575 West Higgins Road, Suite 600
 Rosemont, Illinois 60018
 (847) 823-0500