

P.A. NO.	SECTION	COUNTY	FILE NO.	DATE
347	L-WB-1	KANE		
STA.	TO STA.			
P.L. ROAD DIST. NO.	ELMENTS	P.L. NO. PROJECT		

CONSTRUCTION NOTES:

- ① REMOVE EXISTING CONTROLLER AND CABINET. INSTALL NEW CONTROLLER AND TYPE IV CABINET ON EXISTING FOUNDATION.
- ② UPGRADE EXISTING UNINTERRUPTIBLE POWER SUPPLY TO ETHERNET AND RELOCATE EXISTING UNINTERRUPTIBLE POWER SUPPLY IN NEW CABINET ENCLOSURE.
- ③ LIGHTING CONTROLLER IS ATTACHED TO EXISTING TRAFFIC SIGNAL CABINET AND SHALL BE CONNECTED TO THE PROPOSED TRAFFIC SIGNAL CABINET. THIS WORK SHALL BE INCLUDED IN THE COST FOR THE PAY ITEM: FULL-ACTUATED CONTROLLER AND TYPE IV CABINET.

DATE	BY	SURVEYED	PLANNED
		PLOTTED	CHECKED
		FILED	RECORDED
		NO. _____	NO. _____
		NO. _____	NO. _____

CHRISTOPHER B. BURKE ENGINEERING LTD.
 9575 West Higgins Road, Suite 600
 Rosemont, Illinois 60018
 (847) 823-0500

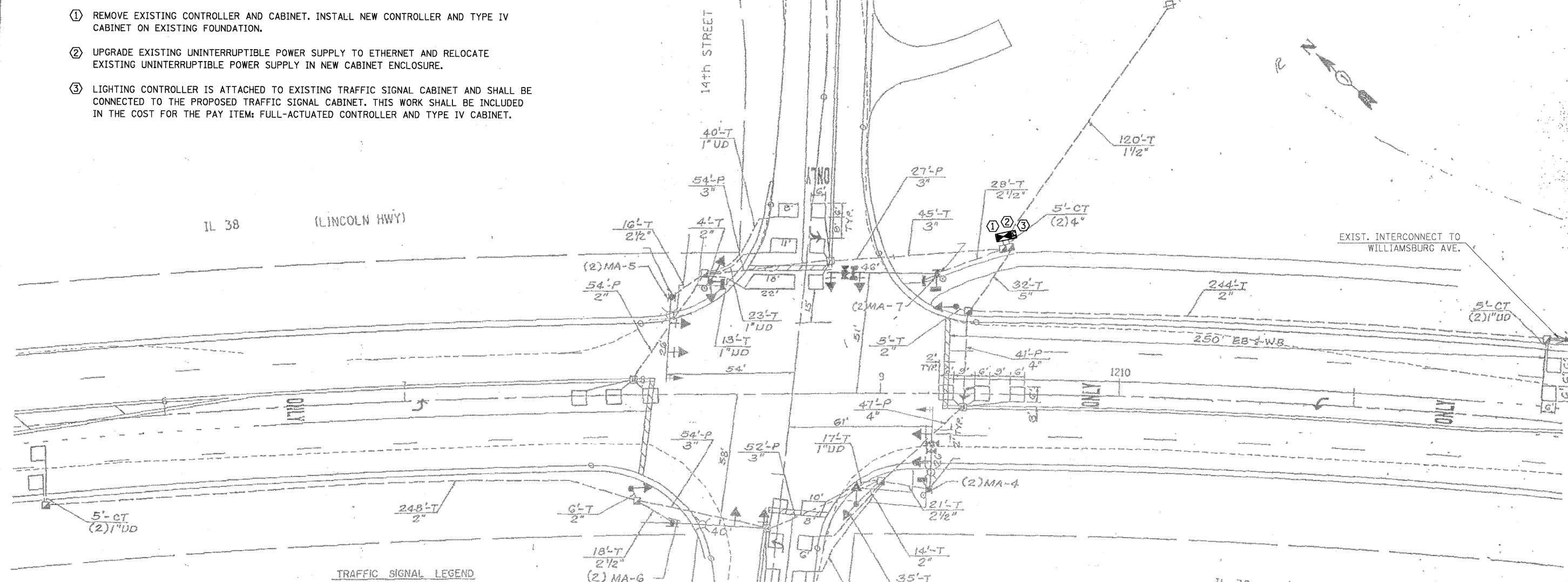

TRAFFIC SIGNAL LEGEND

	PROPOSED	EXISTING
CONTROLLER	[Symbol]	[Symbol]
SERVICE INSTALLATION	[Symbol]	[Symbol]
SIGNAL HEAD	[Symbol]	[Symbol]
SIGNAL HEAD WITH BACKPLATE	[Symbol]	[Symbol]
SIGNAL HEAD, PEDESTRIAN	[Symbol]	[Symbol]
SIGNAL POST	[Symbol]	[Symbol]
COMBINATION MAST ARM ASSEMBLY AND POLE, STEEL	[Symbol]	[Symbol]
HANDHOLE	[Symbol]	[Symbol]
HEAVY DUTY HANDHOLE	[Symbol]	[Symbol]
DOUBLE HANDHOLE	[Symbol]	[Symbol]
G.S. CONDUIT IN TRENCH OR PUSHED	[Symbol]	[Symbol]
PEDESTRIAN PUSHBUTTON DETECTOR	[Symbol]	[Symbol]
DETECTOR LOOP	[Symbol]	[Symbol]
CONCRETE JUNCTION BOX	[Symbol]	[Symbol]
CAST IRON JUNCTION BOX	[Symbol]	[Symbol]
CANYON TRENCH	[Symbol]	[Symbol]
MAST ARM ASSEMBLY AND POLE, ALUMINUM	[Symbol]	[Symbol]
EMERGENCY VEHICLE SYSTEM DETECTOR	[Symbol]	[Symbol]
SIGNAL HEAD OPTICALLY PROGRAMMED	[Symbol]	[Symbol]
CONDUIT SPLICE	[Symbol]	[Symbol]
CONFIRMATION BEACON	[Symbol]	[Symbol]
SIDEWALK TO BE REPAVED & REPLACED	[Symbol]	[Symbol]
COMB. CURB & GUTTER TO BE REMOVED & REPLACED	[Symbol]	[Symbol]

THE FOLLOWING ITEMS SHALL BE REMOVED BY THE CONTRACTOR AND SHALL BE DISPOSED OF BY THEM OUTSIDE THE RIGHT-OF-WAY AT THEIR EXPENSE. THE SALVAGE VALUE OF THE REMOVED EQUIPMENT SHALL BE REFLECTED IN THE CONTRACT BID PRICE.

- 1 EACH CONTROLLER AND CABINET (COMPLETE)

0 50' 100' 1" = 20'
 FULL SIZE PLANS HAVE BEEN PREPARED USING STANDARD ENGINEERING SCALES, BUT REDUCED SIZE PLANS WILL NOT CONFORM TO STANDARD SCALES. IF MAKING MEASUREMENTS ON REDUCED PLANS, THE ABOVE SCALE MAY BE USED.

REVISIONS	
NAME	DATE

ILLINOIS DEPARTMENT OF TRANSPORTATION
PROPOSED TRAFFIC SIGNAL PLAN
 IL 38 & 14th ST. / BRICHER RD.
 SCALE: VERT. 1"=20'
 HORIZ. DATE 3-2-94
 DRAWN BY RAC
 CHECKED BY SPV

FILE NAME = N:\kane\count\0806731\traffic\0508.TSD.IL38-Bricher.dgn	USER NAME = FPCIONE	DESIGNED - ABR	REVISED -	STATE OF ILLINOIS DEPARTMENT OF TRANSPORTATION	TRAFFIC SIGNAL MODERNIZATION PLAN IL ROUTE 38 AND BRICHER /14th STREET	F.A.P. RTE. 336	SECTION 09-00237-02-TL	COUNTY KANE	TOTAL SHEETS 100	SHEET NO. 50	CONTRACT NO. 63525 ILLINOIS/FED. AID PROJECT
PLOT SCALE = NOT TO SCALE	CHECKED - MUT	REVISED -	SCALE: SHEET NO. OF SHEETS STA. -- TO STA. --								
PLOT DATE = 11/3/2010	DATE - AUGUST 31, 2010	REVISED -									