

SURVEYED BY: DATE: _____
 PLOTTED BY: DATE: _____
 ALIGNED BY: DATE: _____
 CHECKED BY: DATE: _____
 CADD FILE NAME: _____
 NO. _____
 PLAN NO. _____
 NOTE BOOK NO. _____
CHRISTOPHER B. BURKE ENGINEERING LTD.
 9575 West Higgins Road, Suite 600
 Rosemont, Illinois 60018
 (847) 823-0500
 SURVEYED BY: DATE: _____
 PLOTTED BY: DATE: _____
 BLANK INDEXED BY: DATE: _____
 STRUCTURE NOTATIONS CHKD BY: DATE: _____
 NO. _____
 PROFILE NO. _____

TRAFFIC SIGNAL LEGEND

| PROPOSED | EXISTING | DESCRIPTION |
|----------|----------|---|
| [Symbol] | [Symbol] | CONTROLLER |
| [Symbol] | [Symbol] | SERVICE INSTALLATION |
| [Symbol] | [Symbol] | SIGNAL HEAD |
| [Symbol] | [Symbol] | SIGNAL HEAD WITH BACKPLATE |
| [Symbol] | [Symbol] | SIGNAL HEAD PEDESTRIAN |
| [Symbol] | [Symbol] | SIGNAL POST |
| [Symbol] | [Symbol] | MAST ARM ASSEMBLY AND POLE, STEEL |
| [Symbol] | [Symbol] | MAST ARM ASSEMBLY AND POLE, ALUMINUM |
| [Symbol] | [Symbol] | COMBINATION MAST ARM ASSEMBLY AND POLE STEEL WITH LUMINAIRE |
| [Symbol] | [Symbol] | UNIT DUCT |
| [Symbol] | [Symbol] | CONDUIT SPLICE |
| [Symbol] | [Symbol] | HANDHOLE |
| [Symbol] | [Symbol] | HEAVY DUTY HANDHOLE |
| [Symbol] | [Symbol] | DOUBLE HANDHOLE |
| [Symbol] | [Symbol] | G.S. CONDUIT IN GROUND (CIG) |
| [Symbol] | [Symbol] | PEDESTRIAN PUSHBUTTON DETECTOR |
| [Symbol] | [Symbol] | PEDESTRIAN PUSHBUTTON SIGN |
| [Symbol] | [Symbol] | TELEPHONE DROP |
| [Symbol] | [Symbol] | APPROXIMATE DETECTION ZONE |
| [Symbol] | [Symbol] | DETECTOR LOOP |
| [Symbol] | [Symbol] | EMERGENCY VEHICLE LIGHT DETECTOR |
| [Symbol] | [Symbol] | CONFIRMATION BEACON |
| [Symbol] | [Symbol] | SIGNAL HEAD OPTICALLY PROGRAMMED |
| [Symbol] | [Symbol] | RAILROAD CONTROL CABINET |
| [Symbol] | [Symbol] | VIDEO DETECTION CAMERA |
| [Symbol] | [Symbol] | PTZ CAMERA |
| [Symbol] | [Symbol] | STREET NAME SIGN |
| [Symbol] | [Symbol] | ABANDON |
| [Symbol] | [Symbol] | VIDEO COMMUNICATIONS CABINET |
| [Symbol] | [Symbol] | LANDING PAD |
| [Symbol] | [Symbol] | 6" BITUMINOUS CONCRETE SHOULDER |

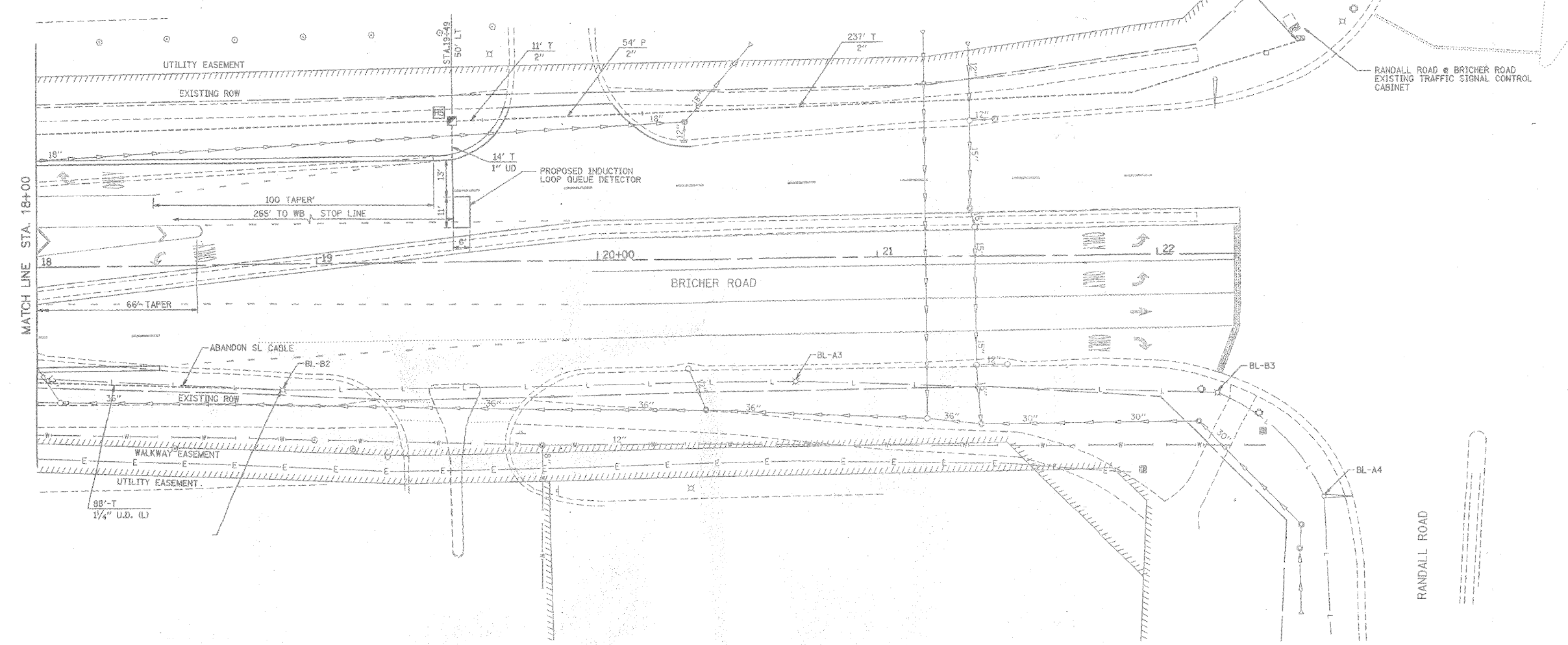

RESTORATION OF WORK AREA. RESTORATION OF THE TRAFFIC SIGNAL WORK AREA SHALL BE INCIDENTAL TO THE RELATED PAY ITEM SUCH AS FOUNDATION, CONDUIT, HANDHOLE, TRENCH AND BACKFILL, ETC., AND NO EXTRA COMPENSATION SHALL BE ALLOWED. ALL ROADWAY SURFACES SUCH AS SHOULDERS, MEDIANS, SIDEWALKS, PAVEMENT, ETC. SHALL BE REPLACED IN KIND. ALL DAMAGE TO MOWED LAWNS SHALL BE REPLACED WITH AN APPROVED SOG, AND ALL DAMAGE TO UNMOWED FIELDS SHALL BE SEEDED IN ACCORDANCE WITH STANDARD SPECIFICATIONS 252 AND 250 RESPECTIVELY.

THE TRAFFIC SIGNAL CONTROLLER SUPPLIED FOR THIS CONTRACT SHALL BE MANUFACTURED BY "EAGLE" AND BE COMPATIBLE WITH THE ADJACENT RANDALL ROAD CLOSED LOOP SIGNAL SYSTEM

REVISIONS

| NO. | DATE | DESCRIPTION | NO. | DATE | DESCRIPTION |
|-----|------|-------------|-----|------|-------------|
| | | | | | |

CITY OF GENEVA
 1800 SOUTH STREET
 GENEVA, ILLINOIS 60134
 (630)232-1501

HILR
HAMPTON, LENZINI & RENWICK, INC.
 380 SHEPARD DRIVE • ELGIN, ILLINOIS 60123
 (847)697-6700 • www.hlengineering.com
 CIVIL ENGINEERS • STRUCTURAL ENGINEERS • LAND SURVEYORS

| | |
|----------------|------------------------|
| DESIGNED - CJM | PROJECT NO. - 08.0039 |
| DRAWN - SMS | FILE - sst-ts-bricher1 |
| CHECKED - JAS | SCALE - 1"=20' |
| DATE - 5/1/09 | |

BRICHER ROAD AT COMMONS DRIVE
TRAFFIC SIGNAL INTERCONNECT AND QUEUE DETECTOR
 STA. 18+00 TO STA. 22+00

| | |
|--------------|--------------|
| 31 | 10 |
| TOTAL SHEETS | SHEET NUMBER |