

DATE: \_\_\_\_\_ BY: \_\_\_\_\_  
 SURVEYED: \_\_\_\_\_ PLOTTED: \_\_\_\_\_ CHECKED: \_\_\_\_\_  
 ALIGNMENT: \_\_\_\_\_ ROAD: \_\_\_\_\_  
 NOTE BOOK NO.: \_\_\_\_\_ CAD FILE NAME: \_\_\_\_\_  
 PLAN NO.: \_\_\_\_\_

DATE: \_\_\_\_\_ BY: \_\_\_\_\_  
 SURVEYED: \_\_\_\_\_ PLOTTED: \_\_\_\_\_ CHECKED: \_\_\_\_\_  
 STRUCTURE: \_\_\_\_\_ NOTATION: \_\_\_\_\_  
 PROFILE NO.: \_\_\_\_\_

**CHRISTOPHER B. BURKE ENGINEERING LTD.**  
 9575 West Higgins Road, Suite 600  
 Rosemont, Illinois 60018  
 (847) 823-0500

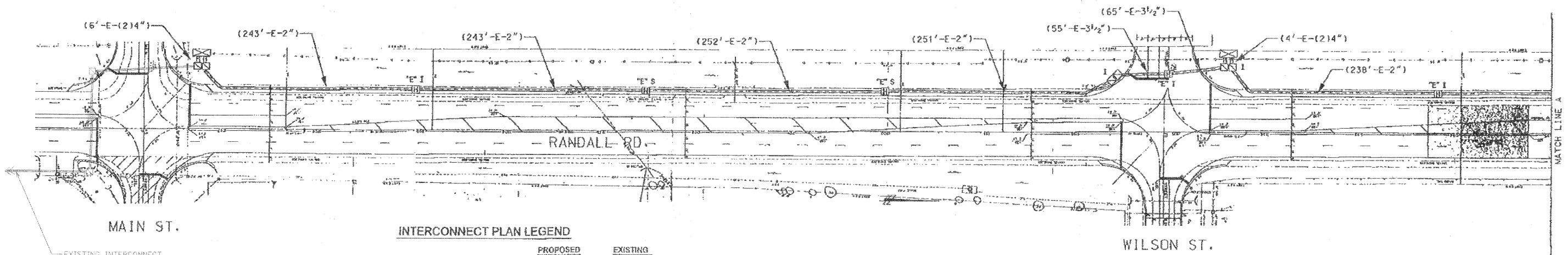

**INTERCONNECT PLAN LEGEND**

	PROPOSED	EXISTING
CONTROLLER		
HANDHOLE		
DOUBLE HANDHOLE		
HEAVY-DUTY HANDHOLE		
S.S. CONDUIT IN TRENCH OR PUSHED		
DETECTOR LOOP		
COMMON TRENCH	CT	
UNIT DUCT	UD	
SYSTEM	S	
INTERSECTION	IP	I



SCALE: 1"=50'

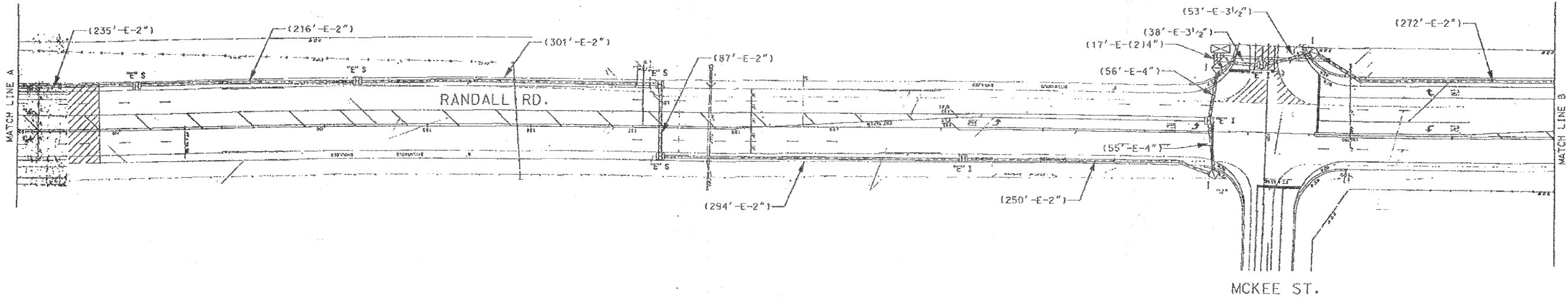

**FOR INFORMATION ONLY**



**METRO TRANSPORTATION GROUP, INC.**  
 TRANSPORTATION PLANNING, ENGINEERING AND DESIGN  
 1300 GREENBROOK, HANOVER PARK, IL 60103 PH# 630-213-1000

REVISIONS		
NO.	DATE	DESCRIPTION

**INTERCONNECT PLAN**  
 RANDALL RD. (MAIN ST. TO KESLINGER RD.)  
 GENEVA / BATAVIA, ILLINOIS

FILE NAME: fo_1.dgn	SHEET NO.: 15
DATE: Apr 11 15, 1999	OF 24
PROJECT NO.: 3857-00	

FILE NAME = N:\kane\county\888673\1\raff\c\059_INT-01_Randall.dgn	USER NAME = FPACIONE	DESIGNED - ABR	REVISED -
		DRAWN - FCP	REVISED -
		CHECKED - MJT	REVISED -
		DATE - AUGUST 31, 2010	REVISED -

**STATE OF ILLINOIS**  
**DEPARTMENT OF TRANSPORTATION**

SCALE:	SHEET NO. OF SHEETS	STA. -- TO STA. --
--------	---------------------	--------------------

F.A.P. RTE. 336	SECTION 09-00237-02-TL	COUNTY KANE	TOTAL SHEETS 100	SHEET NO. 59
CONTRACT NO. 63525				
ILLINOIS FED. AID PROJECT				