

SURVEYED _____
 PLOTTED _____
 CHECKED _____
 ALIGNED _____
 CAD FILE NAME _____
 NO. _____
 DATE _____
 BY _____
 PLAN _____
 NOTE BOOK _____
 NO. _____
 DATE _____
 BY _____
 SURVEYED _____
 PLOTTED _____
 CHECKED _____
 STRUCTURE NOTATIONS CIRCD
 NO. _____
 DATE _____
 BY _____

CHRISTOPHER B. BURKE ENGINEERING LTD.
 9575 West Higgins Road, Suite 600
 Rosemont, Illinois 60018
 (847) 823-0500
CB

Randall Square Shopping Center access

FARGO BLVD.

RANDALL RD.

CHRISTINA LN.

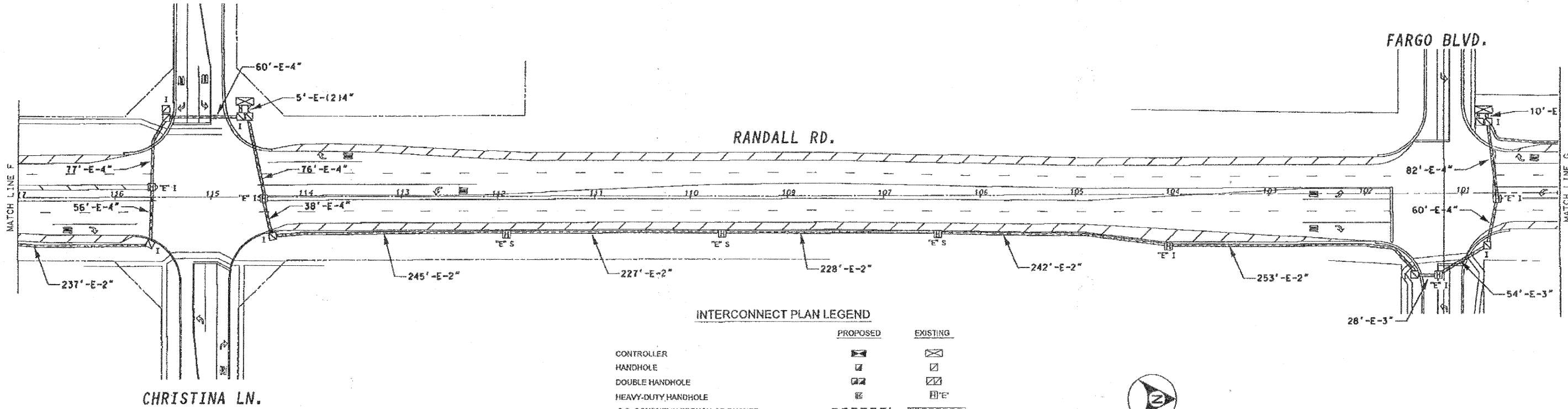

INTERCONNECT PLAN LEGEND

	PROPOSED	EXISTING
CONTROLLER		
HANDHOLE		
DOUBLE HANDHOLE		
HEAVY-DUTY HANDHOLE		
G.S. CONDUIT IN TRENCH OR PUSHED		
DETECTOR LOOP		
COMMON TRENCH	CT	
UNIT DUCT	UD	
SYSTEM	S	
INTERSECTION	IP	I



SCALE: 1"=50'

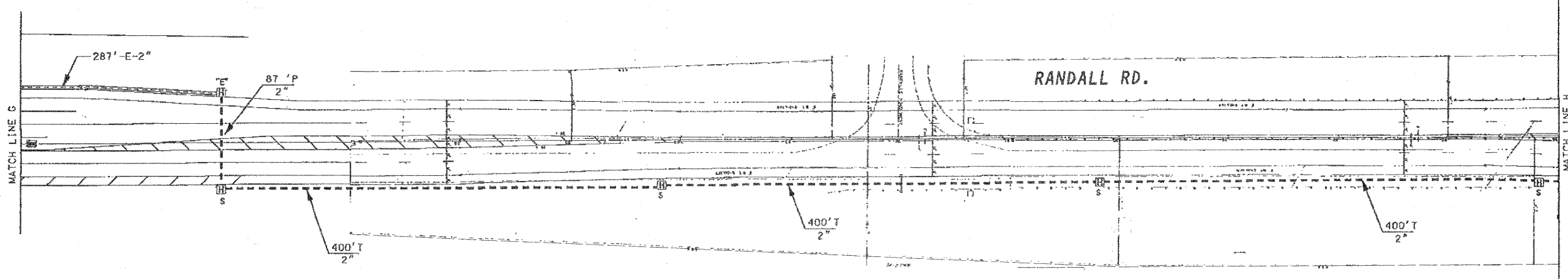

FOR INFORMATION ONLY



METRO TRANSPORTATION GROUP, INC.
 TRANSPORTATION PLANNING, ENGINEERING AND DESIGN
 1300 GREENBROOK, HANOVER PARK, IL 60103 PH# 630 213-1000

REVISIONS		
NO.	DATE	DESCRIPTION

INTERCONNECT PLAN
 RANDALL RD. (MAIN ST. TO KESLINGER RD.)
 GENEVA / BATAVIA, ILLINOIS

FILE NAME: 10_4.dgn	SHEET NO. 18
DATE: Apr 11 15 1999	OF 24
PROJECT NO.: 3857-00	

FILE NAME: N:\kanecounty\B0673\Treffic\062_INT-04_Randall	USER NAME: FPACIONE	DESIGNED: ABR	REVISED: -	STATE OF ILLINOIS DEPARTMENT OF TRANSPORTATION	INTERCONNECT PLAN RANDALL ROAD	F.A.P. RTE. 336	SECTION 09-00237-02-TL	COUNTY KANE	TOTAL SHEETS 100	SHEET NO. 62		
PLOT SCALE: NOT TO SCALE	CHECKED: MJT	REVISED: -	REVISED: -			SCALE:	SHEET NO. OF SHEETS	STA. -- TO STA. --	CONTRACT NO. 63525			
PLOT DATE: 11/3/2010	DATE: AUGUST 31, 2010	REVISED: -	REVISED: -			ILLINOIS FED. AID PROJECT						