

DATE	BY	DATE	BY
DATE	BY	DATE	BY
DATE	BY	DATE	BY

**CHRISTOPHER B. BURKE ENGINEERING LTD.**  
 9575 West Higgins Road, Suite 600  
 Rosemont, Illinois 60018  
 (847) 821-0500

DATE	BY	DATE	BY
DATE	BY	DATE	BY
DATE	BY	DATE	BY

**MATCHLINE A-A  
(SEE SHEET NO. 82)**

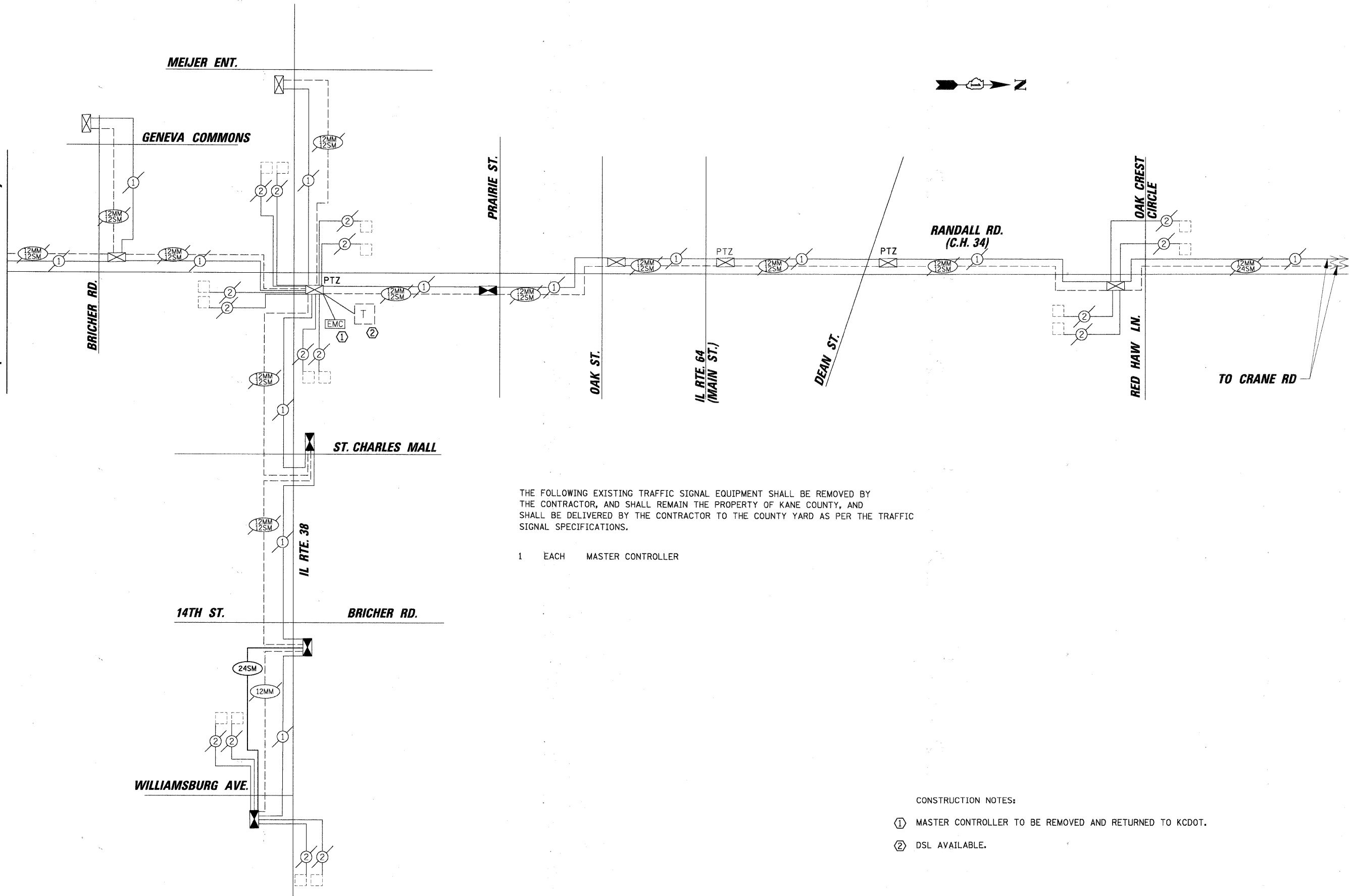

THE FOLLOWING EXISTING TRAFFIC SIGNAL EQUIPMENT SHALL BE REMOVED BY THE CONTRACTOR, AND SHALL REMAIN THE PROPERTY OF KANE COUNTY, AND SHALL BE DELIVERED BY THE CONTRACTOR TO THE COUNTY YARD AS PER THE TRAFFIC SIGNAL SPECIFICATIONS.

1 EACH MASTER CONTROLLER

- CONSTRUCTION NOTES:
- ① MASTER CONTROLLER TO BE REMOVED AND RETURNED TO KCDOT.
  - ② DSL AVAILABLE.

FILE NAME =	USER NAME = FPACIONE	DESIGNED - ABR	REVISED -	<b>STATE OF ILLINOIS DEPARTMENT OF TRANSPORTATION</b>	<b>INTERCONNECT SCHEMATIC</b> IL RTE. 38 AT RANDALL ROAD SYSTEM	F.A.P. RTE.	SECTION	COUNTY	TOTAL SHEETS	SHEET NO.	
N:\kenecounty\880673\Traffic\078_SCH-02_200673.dgn		DRAWN - FCP	REVISED -			336	09-00237-02-TL	KANE	100	78	
PLOT SCALE = NOT TO SCALE		CHECKED - MJT	REVISED -			CONTRACT NO. 63525					
PLOT DATE = 11/3/2010		DATE - AUGUST 31, 2010	REVISED -			ILLINOIS FED. AID PROJECT					