

**CONCRETE MEDIAN, TYPE SB-9.12**

AT MEDIAN NOSES

NOTE: CONCRETE MEDIAN, TYPE SB-9.12 SHALL BE CONSTRUCTED IN ACCORDANCE WITH APPLICABLE PORTIONS OF STANDARD 606301

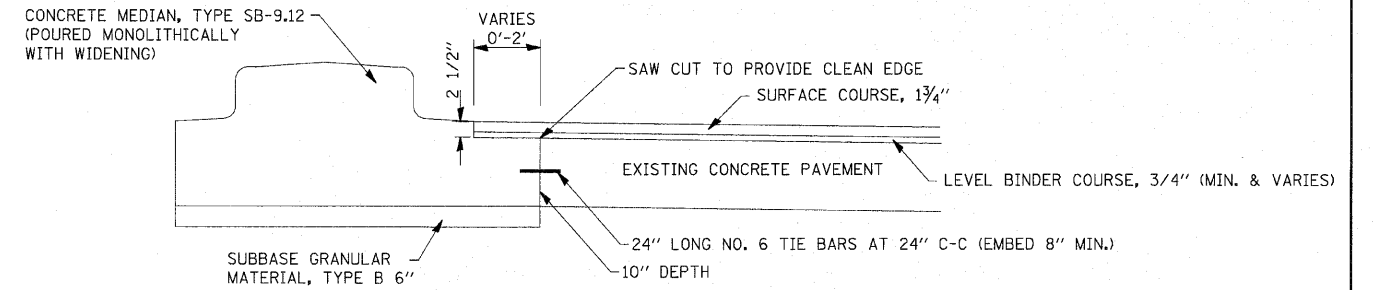
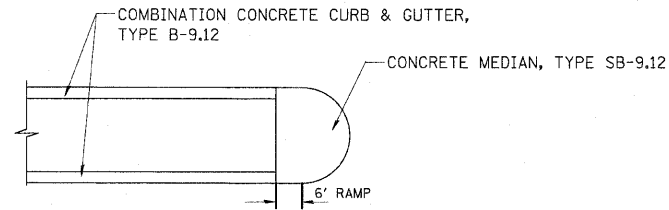

**CONCRETE MEDIAN, TYPE SB-9.12**

AT LOCATIONS WHERE WIDENING IS 2' OR LESS

**CONCRETE MEDIAN, TYPE SB-6.12 (SPECIAL)**

AT MEDIAN NOSES

NOTE: CONCRETE MEDIAN, TYPE SB-6.12 SHALL BE CONSTRUCTED IN ACCORDANCE WITH APPLICABLE PORTIONS OF STANDARD 606301

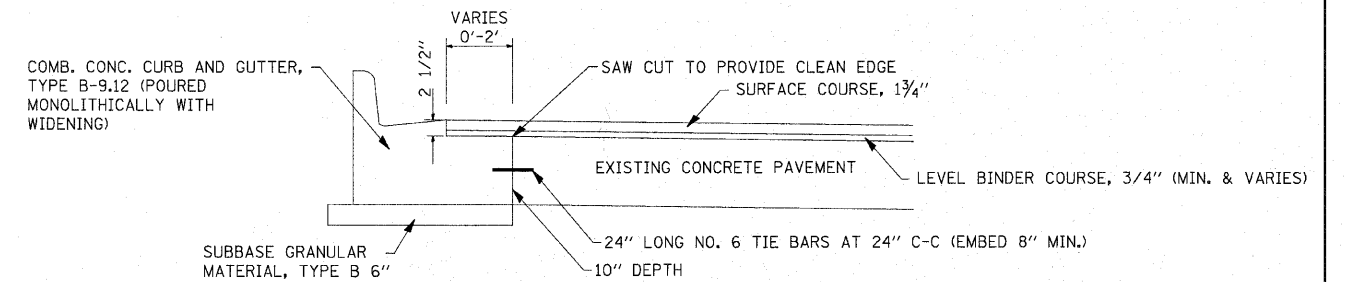
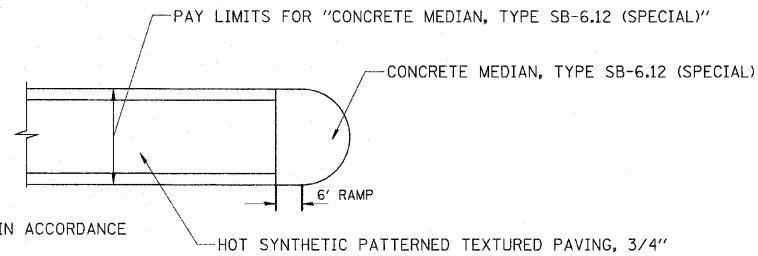

**COMBINATION CONCRETE CURB AND GUTTER, TYPE B-9.12**

AT LOCATIONS WHERE WIDENING IS 2' OR LESS

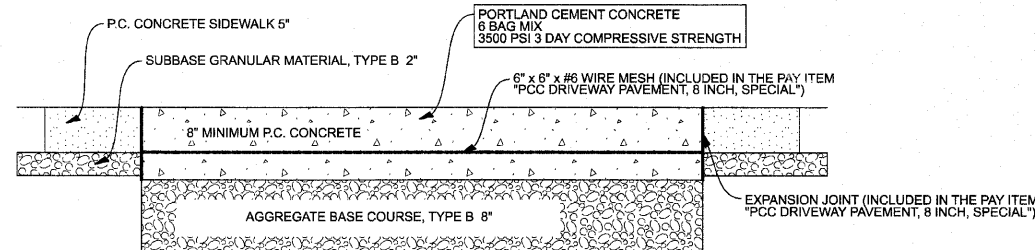
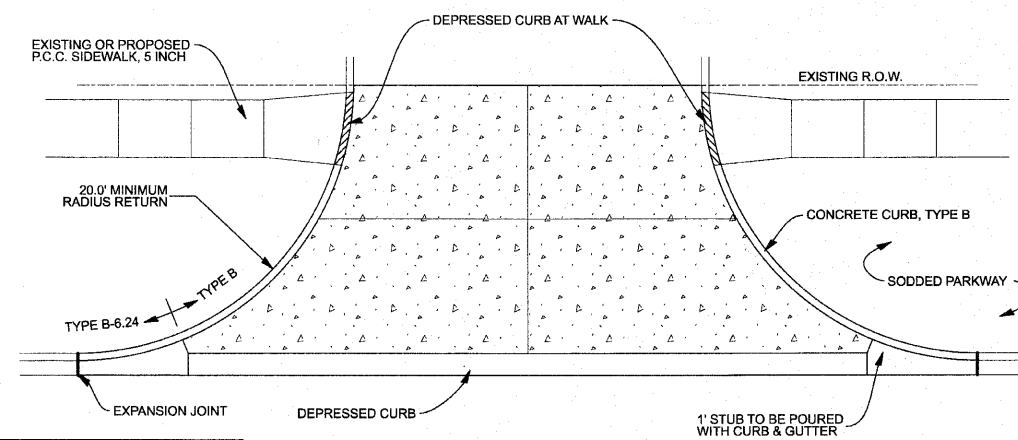
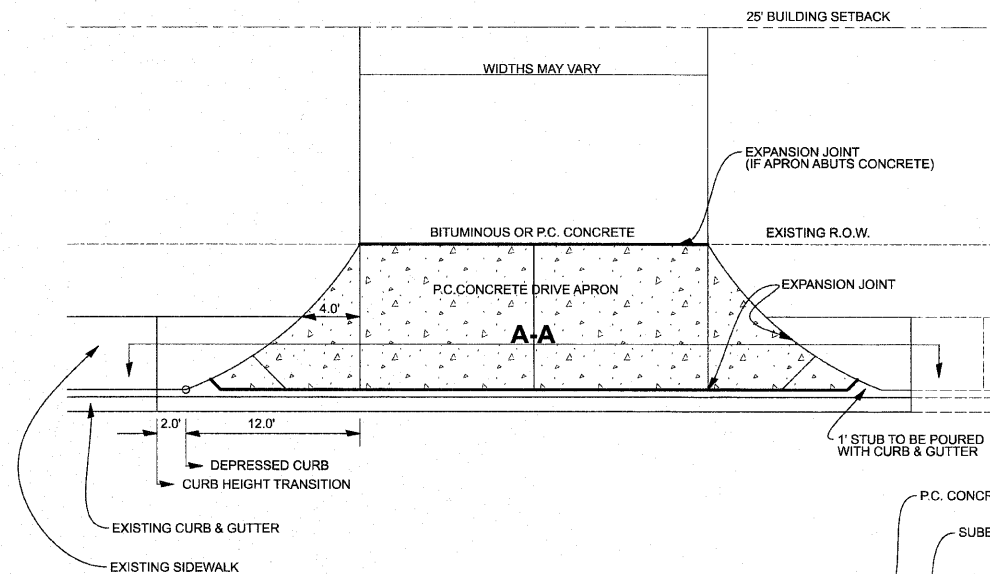

**SECTION A-A**

**DRIVEWAY DETAIL**

NOT TO SCALE

|                                   |                 |
|-----------------------------------|-----------------|
| FILE NAME =                       | USER NAME = kpk |
| ...\\oad\sheet\2362_detail_01.dgn |                 |
| PLOT SCALE = 50.0000' / IN.       |                 |
| PLOT DATE = 10/22/2010            |                 |

|                 |           |
|-----------------|-----------|
| DESIGNED - BLG  | REVISIONS |
| DRAWN - BLG     | REVISIONS |
| CHECKED - DJK   | REVISIONS |
| DATE - 10-22-10 | REVISIONS |

**STATE OF ILLINOIS  
DEPARTMENT OF TRANSPORTATION**

**ROADWAY DETAILS**

SHEET NO. 1 OF 5 SHEETS

| F.A.P. RTE.   | SECTION        | COUNTY | TOTAL SHEETS | SHEET NO. |
|---|----------------|--------|--------------|-----------|
| 334   | 09-00056-00-CH | COOK   | 111          | 72        |
| CONTRACT NO. 63527  |                |        |              |           |
| FED. ROAD DIST. NO. 1 ILLINOIS FED. AID PROJECT M-9003(659) |                |        |              |           |