

PLAN  
 SURVEYED  
 PLOTTED  
 CHECKED  
 DATE  
 BY  
 NO.

PROFILE  
 SURVEYED  
 PLOTTED  
 CHECKED  
 DATE  
 BY  
 NO.

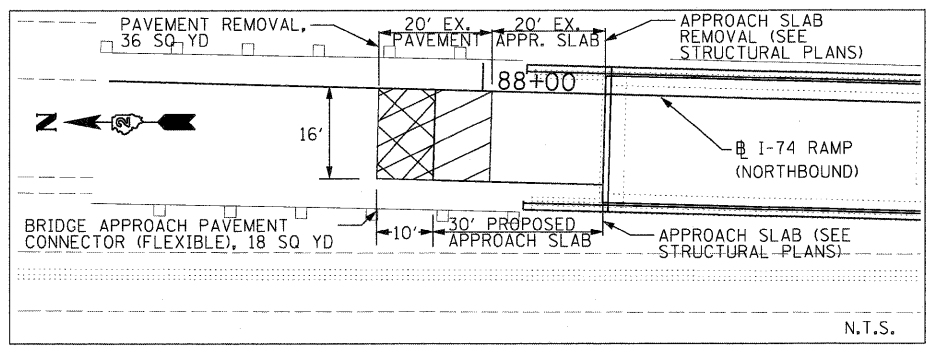
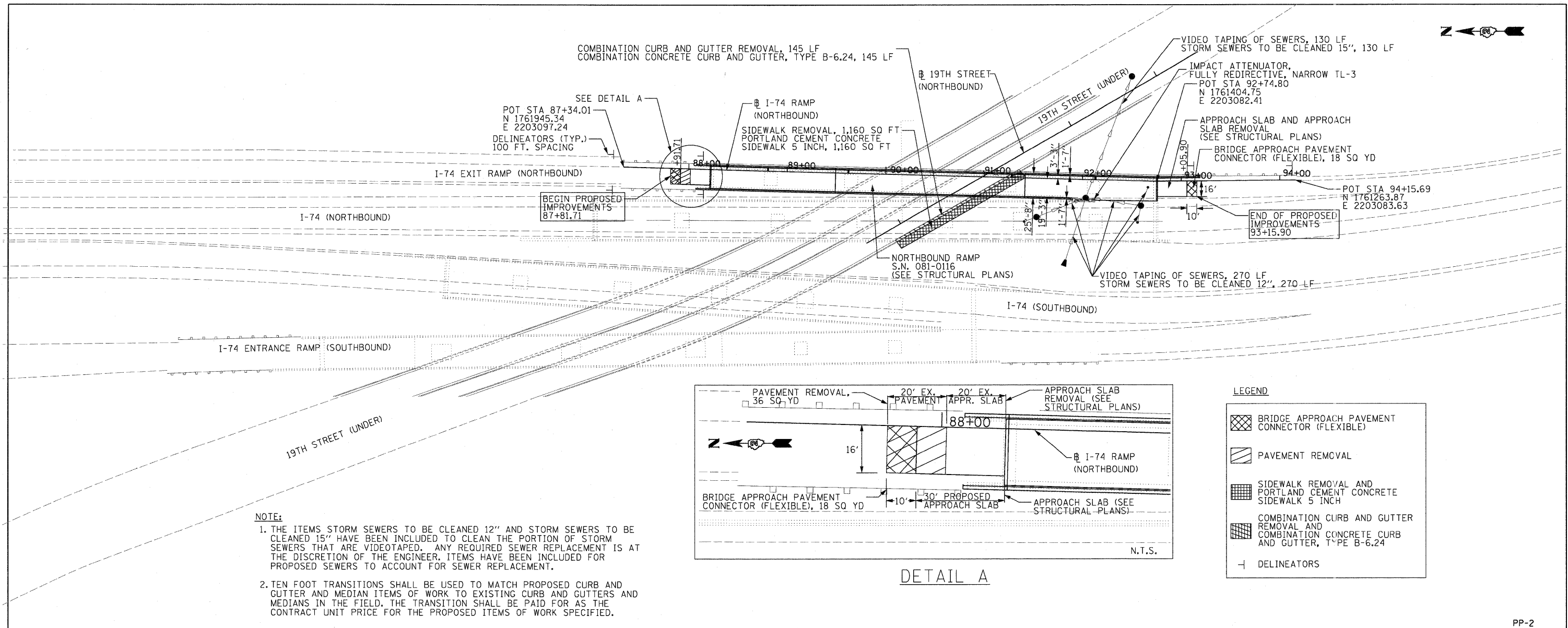

LEGEND

- BRIDGE APPROACH PAVEMENT CONNECTOR (FLEXIBLE)
- PAVEMENT REMOVAL
- SIDEWALK REMOVAL AND PORTLAND CEMENT CONCRETE SIDEWALK 5 INCH
- COMBINATION CURB AND GUTTER REMOVAL AND COMBINATION CONCRETE CURB AND GUTTER, TYPE B-6.24
- DILINEATORS

- NOTE:
1. THE ITEMS STORM SEWERS TO BE CLEANED 12" AND STORM SEWERS TO BE CLEANED 15" HAVE BEEN INCLUDED TO CLEAN THE PORTION OF STORM SEWERS THAT ARE VIDEOTAPED. ANY REQUIRED SEWER REPLACEMENT IS AT THE DISCRETION OF THE ENGINEER. ITEMS HAVE BEEN INCLUDED FOR PROPOSED SEWERS TO ACCOUNT FOR SEWER REPLACEMENT.
  2. TEN FOOT TRANSITIONS SHALL BE USED TO MATCH PROPOSED CURB AND GUTTER AND MEDIAN ITEMS OF WORK TO EXISTING CURB AND GUTTERS AND MEDIANS IN THE FIELD. THE TRANSITION SHALL BE PAID FOR AS THE CONTRACT UNIT PRICE FOR THE PROPOSED ITEMS OF WORK SPECIFIED.

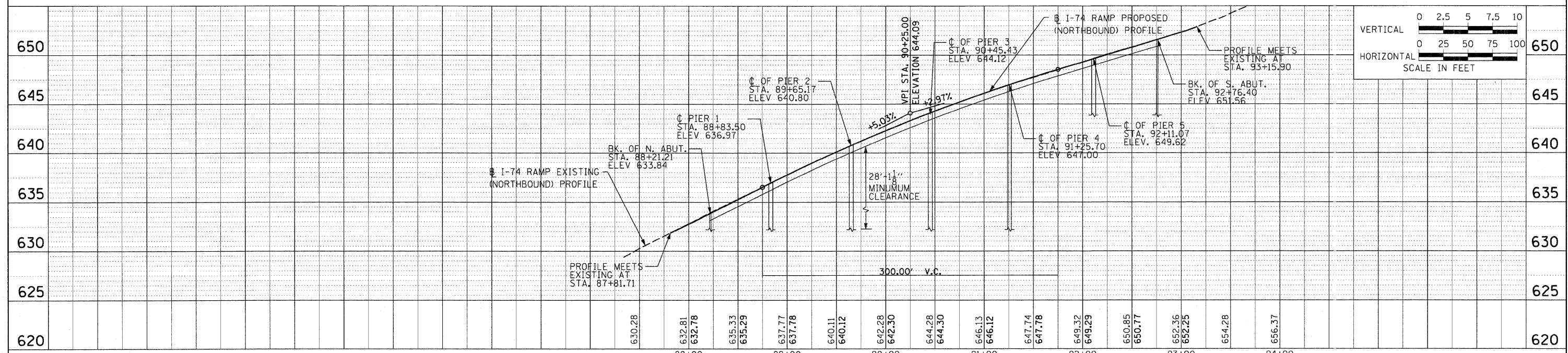

FILE NAME =	USER NAME = agensch	DESIGNED - AEG	REVISED -	<b>STATE OF ILLINOIS DEPARTMENT OF TRANSPORTATION</b>	<b>PROPOSED PLAN AND PROFILE - NB RAMP (SN081-0116)</b>	F.A.I. RTE.	SECTION	COUNTY	TOTAL SHEETS	SHEET NO.	
PA\2009\09\94100\Cadd\Task\Civil\Sheet	files\Plan_Prof_2NB.dgn	DRAWN - AEG	REVISED -			74	(81-1HB)D	ROCK ISLAND	78	10	
JACOBS	PLOT SCALE = @IMS.PLT_SCALE	CHECKED - TAI	REVISED -			CONTRACT NO. 64D95					
	PLOT DATE = 10/28/2010	DATE - 10/29/10	REVISED -			FED. ROAD DIST. NO. ILLINOIS FED. AID PROJECT					