

EAST EDGE OF SHOULDER

Location	Station	Offset	Theoretical Grade Elevations
N. End N. Appr. Pav't.	87+91.71	-3.25	632.30
A1	88+01.71	-3.25	632.81
A2	88+11.71	-3.25	633.31
S. End N. Appr. Pav't.	88+21.71	-3.25	633.81

PROFILE GRADE & EAST EDGE OF PAVEMENT

Location	Station	Offset	Theoretical Grade Elevations
N. End N. Appr. Pav't.	87+91.71	0.00	632.36
A1	88+01.71	0.00	632.86
A2	88+11.71	0.00	633.36
S. End N. Appr. Pav't.	88+21.71	0.00	633.86

☉ ROADWAY

Location	Station	Offset	Theoretical Grade Elevations
N. End N. Appr. Pav't.	87+91.71	8.00	632.48
A1	88+01.71	8.00	632.98
A2	88+11.71	8.00	633.49
S. End N. Appr. Pav't.	88+21.71	8.00	633.99

WEST EDGE OF PAVEMENT

Location	Station	Offset	Theoretical Grade Elevations
N. End N. Appr. Pav't.	87+91.71	16.00	632.61
A1	88+01.71	16.00	633.11
A2	88+11.71	16.00	633.61
S. End N. Appr. Pav't.	88+21.71	16.00	634.11

WEST EDGE OF SHOULDER

Location	Station	Offset	Theoretical Grade Elevations
N. End N. Appr. Pav't.	87+91.71	19.25	632.66
A1	88+01.71	19.25	633.16
A2	88+11.71	19.25	633.66
S. End N. Appr. Pav't.	88+21.71	19.25	634.16

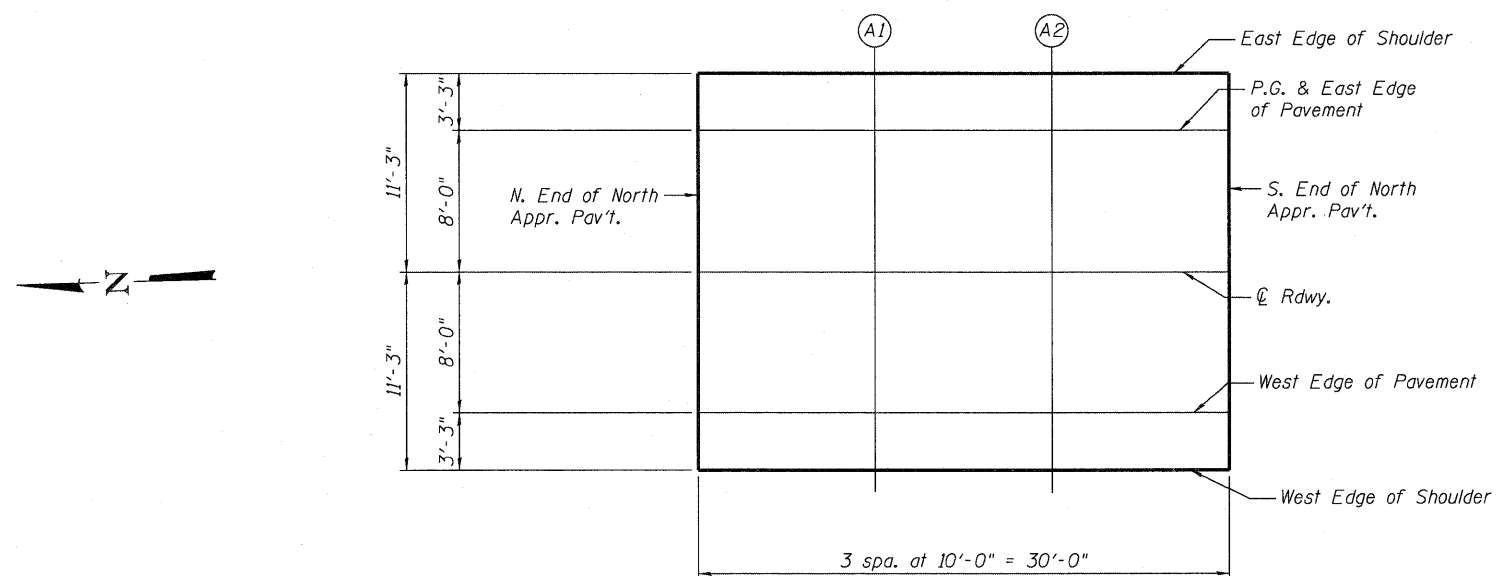

PLAN
North Approach

E-AS 11-1-06

FILE NAME = 0810116-64095-SB06-NTDAS.dgn	USER NAME = JACOBS	DESIGNED - LJH	REVISED -	STATE OF ILLINOIS DEPARTMENT OF TRANSPORTATION	TOP OF NORTH APPROACH SLAB ELEVATIONS STRUCTURE NO. 081-0116	F.A.I. RTE. = 74	SECTION = (81-1HB)D	COUNTY = ROCK ISLAND	TOTAL SHEETS = 78	SHEET NO. = 52
JACOBS	PLOT SCALE =	DRAWN - LJH	REVISED -			CONTRACT NO. 64095				
	PLOT DATE = 10/26/2010	CHECKED - KEB	REVISED -			ILLINOIS FED. AID PROJECT				
SHEET NO. SB6 OF SB30 SHEETS										