

EAST EDGE OF SHOULDER

| Location | Station | Offset | Theoretical Grade Elevations |
|------------------------|----------|--------|------------------------------|
| N. End S. Appr. Pav't. | 92+75.83 | -3.27 | 651.39 |
| A1 | 92+85.84 | -3.57 | 651.67 |
| A2 | 92+95.85 | -3.82 | 651.96 |
| S. End S. Appr. Pav't. | 93+05.86 | -4.04 | 652.24 |

PROFILE GRADE & EAST EDGE OF PAVEMENT

| Location | Station | Offset | Theoretical Grade Elevations |
|------------------------|----------|--------|------------------------------|
| N. End S. Appr. Pav't. | 92+75.90 | 0.00 | 651.54 |
| A1 | 92+85.90 | 0.00 | 651.84 |
| A2 | 92+95.90 | 0.00 | 652.14 |
| S. End S. Appr. Pav't. | 93+05.90 | 0.00 | 652.43 |

☉ ROADWAY

| Location | Station | Offset | Theoretical Grade Elevations |
|------------------------|----------|--------|------------------------------|
| N. End S. Appr. Pav't. | 92+76.07 | 8.00 | 651.90 |
| A1 | 92+86.03 | 8.00 | 652.21 |
| A2 | 92+96.00 | 8.00 | 652.51 |
| S. End S. Appr. Pav't. | 93+05.98 | 8.00 | 652.81 |

WEST EDGE OF PAVEMENT

| Location | Station | Offset | Theoretical Grade Elevations |
|------------------------|----------|--------|------------------------------|
| N. End N. Appr. Pav't. | 92+76.23 | 16.00 | 652.26 |
| A1 | 92+86.16 | 16.00 | 652.58 |
| A2 | 92+96.09 | 16.00 | 652.89 |
| S. End N. Appr. Pav't. | 93+06.07 | 16.00 | 653.19 |

WEST EDGE OF SHOULDER

| Location | Station | Offset | Theoretical Grade Elevations |
|------------------------|----------|--------|------------------------------|
| N. End S. Appr. Pav't. | 92+76.30 | 19.33 | 652.42* |
| A1 | 92+86.22 | 19.14 | 652.72* |
| A2 | 92+96.13 | 19.00 | 653.03* |
| S. End S. Appr. Pav't. | 93+06.10 | 18.89 | 653.33* |

*NOTE - Match West Edge of Shoulder elevations to existing adjacent pavement elevations.

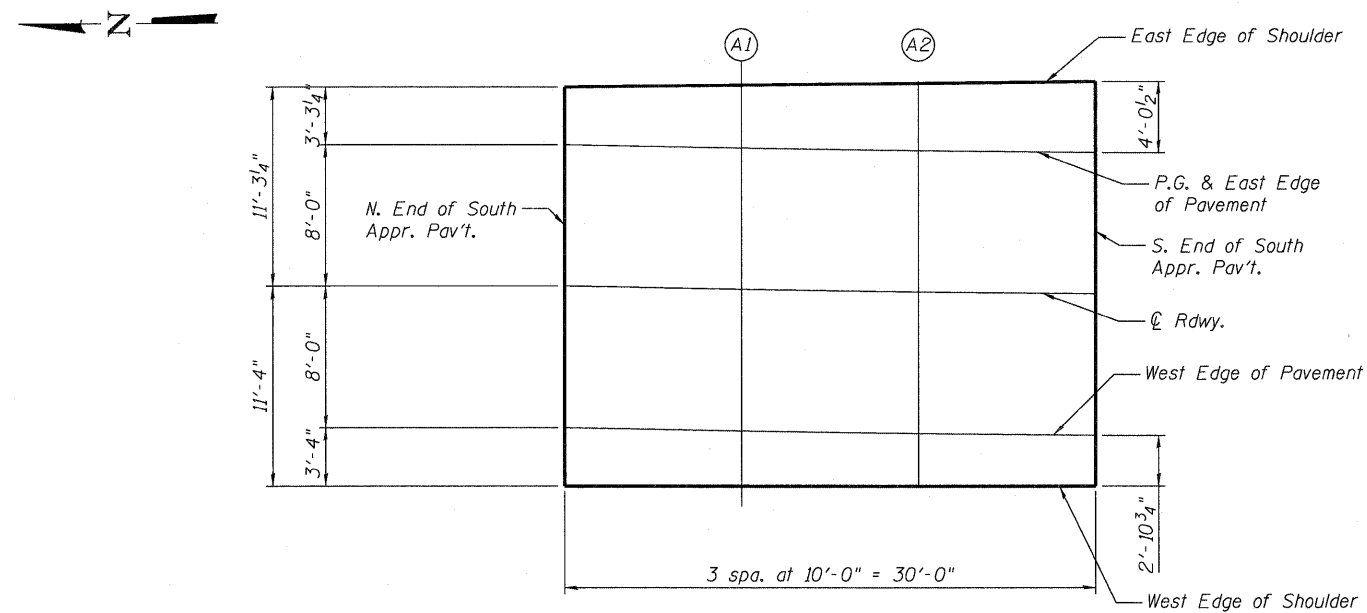

PLAN
South Approach

E-AS 11-1-06

| | | | | | | | | | | | |
|--|------------------------|----------------|-------------|---|---|------------------------------|---------------------|----------------------|-------------------|----------------|--|
| FILE NAME = 0810116-64095-SB07-STOAS.dgn | USER NAME = JACOBS | DESIGNED - LJH | REVISIONS - | STATE OF ILLINOIS DEPARTMENT OF TRANSPORTATION | TOP OF SOUTH APPROACH SLAB ELEVATIONS STRUCTURE NO. 081-0116 | F.A.I. RTE. = 74 | SECTION = (81-1HB)D | COUNTY = ROCK ISLAND | TOTAL SHEETS = 78 | SHEET NO. = 53 | |
| JACOBS | PLOT SCALE = | CHECKED - KEB | REVISIONS - | | | CONTRACT NO. 64095 | | | | | |
| | PLOT DATE = 10/28/2010 | DRAWN - LJH | REVISIONS - | | | ILLINOIS FED. AID PROJECT | | | | | |
| | | CHECKED - KEB | REVISIONS - | | | SHEET NO. SB7 OF SB30 SHEETS | | | | | |