

**SECTION A-A**

**NOTES:**

See sheet SB17 of SB30 for Plan View.  
 Approach slab and parapet concrete shall be paid for as Concrete Superstructure.  
 Approach footing concrete shall be paid for as Concrete Structures.  
 Reinforcement shall be paid for as Reinforcement Bars, Epoxy Coated.  
 For v(E) bar details, see sheet SB28 of SB30.  
 The approach footing maximum applied service bearing pressure (Qmax) = 2.0 ksf.  
 For bar splicer details, see sheet SB30 of SB30.  
 Cost of closed cell joint filler, excavation for approach footing included with Concrete Structures.  
 For additional parapet details, see sheet SB28 of SB30.  
 Contractor shall carefully remove existing approach slab and protect all existing v bars for connecting new approach slab to existing abutment.  
 Any damaged v bars shall be replaced at the Contractor's expense and as the Engineer directs.

**SOUTH APPROACH BILL OF MATERIAL**

Bar	No.	Size	Length	Shape	
a9(E)	25	#4	22'-2"	—	
a10(E)	46	#5	22'-2"	—	
b14(E)	23	#4	29'-8"	—	
b15(E)	54	#9	29'-9"	—	
t(E)	46	#4	9'-8"	—	
w1(E)	40	#5	22'-2"	—	
Concrete Superstructure				Cu. Yd.	32
Concrete Structures				Cu. Yd.	8
Reinforcement Bars, Epoxy Coated				Pound	8600

\* Tilt #9 b15(E) bars as required to maintain clearance.  
 \*\*\* Cost included with Concrete Superstructure.

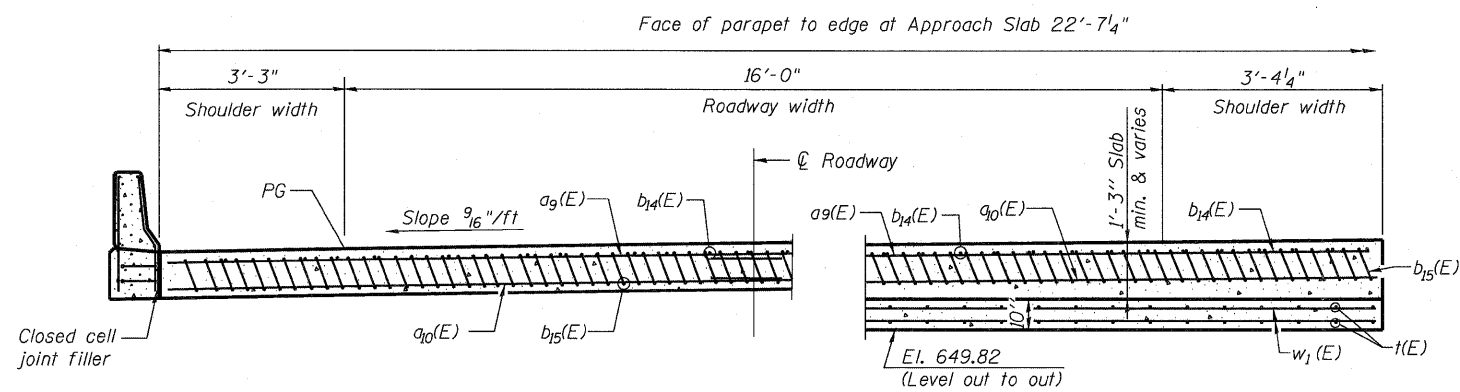

**NEAR ABUTMENT**

**AT APPROACH FOOTING**

**SECTION B-B**

(See Plan for dimensions not shown)  
 Note: The deck cross slope is in transition from Sta. 91+95 to Sta. 93+00. See sheet SB6 for grade elevations. The cross slope shown above is only accurate at Sta. 93+00 and higher stations.

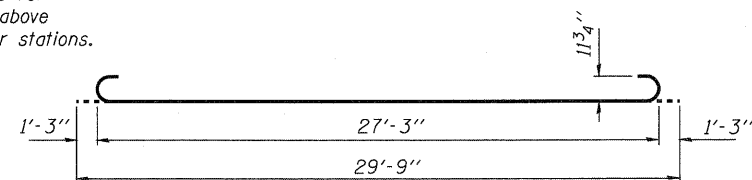

**BAR b15(E)**

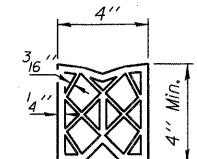

**PREFORMED JOINT SEAL**

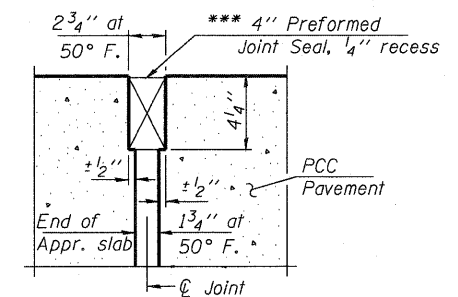

**DETAIL A**