

F.A.P. RTE.	SECTION	COUNTY	TOTAL SHEETS	SHEET NO.
619	70 RS-5 & I	LASALLE	214	1

STATE OF ILLINOIS
DEPARTMENT OF TRANSPORTATION
DIVISION OF HIGHWAYS

PLANS FOR PROPOSED HIGHWAY IMPROVEMENT

FAP ROUTE 619 (IL 71 /IL 351)
SECTION 70 RS-5 & I
PROJECT NO. F-0619 (020)
LASALLE COUNTY

INTERSECTION RECONSTRUCTION, RESURFACING,
CULVERT REPLACEMENT, & SHOULDER RECONSTRUCTION

C-93-044-04

FOR INDEX OF SHEETS, SEE SHEET NO. 2

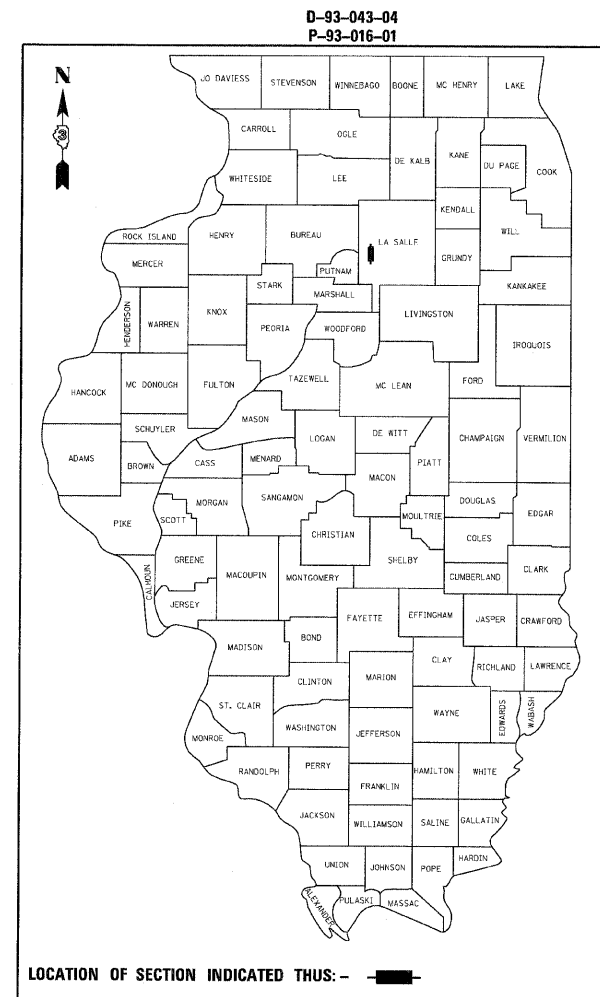

ENGLISH RATIOS

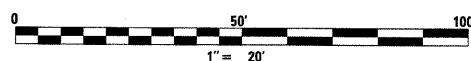
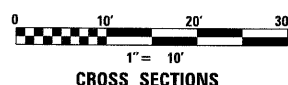

FULL SIZE PLANS HAVE BEEN PREPARED USING STANDARD ENGINEERING SCALES. REDUCED SIZED PLANS WILL NOT CONFORM TO STANDARD SCALES. IN MAKING MEASUREMENTS ON REDUCED PLANS, THE ABOVE SCALES MAY BE USED.

DISTRICT 3 NO (815) 434-6131
PROJECT ENGINEER: JOSEPH KANNEL
UNIT CHIEF: PATRICK C. BRABOY

DESIGN DESIGNATION

FAP ROUTE 619 (IL 71/351)	URBAN PRINCIPAL ARTERIAL
FAU ROUTE (WALNUT STREET)	MINOR ARTERIAL
ADT 5400 (2007)	IL 71/351 4.4% TRUCKS
ADT 7400 (2007)	WALNUT STREET 7.8% TRUCKS

CONTRACT NO. 66442

J.U.L.I.E.
JOINT UTILITY LOCATION INFORMATION FOR EXCAVATION
1-800-892-0123
FORREST TOWNSHIPS

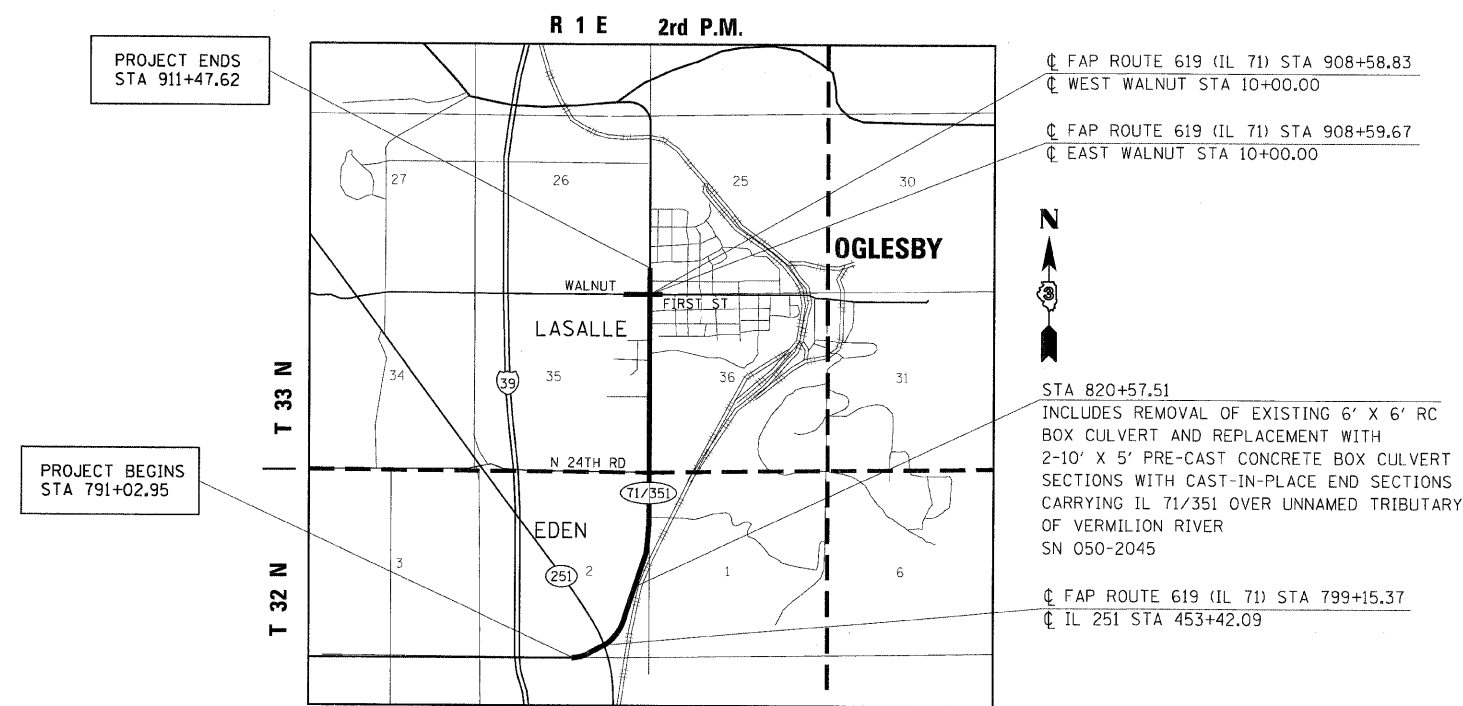

LOCATION MAP

EDEN & LASALLE TOWNSHIP



TOTAL LENGTH PROJECT = 12,044.67 FEET = 2.281 MILES

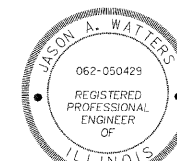

ILLINOIS PROFESSIONAL ENGINEER NO. 062-050429 DATE 06/08/2007
EXP. 11-30-2007

STATE OF ILLINOIS
DEPARTMENT OF TRANSPORTATION
DIVISION OF HIGHWAYS

SUBMITTED October 26 2010
Joseph F. Kannel
DEPUTY DIRECTOR OF HIGHWAYS, REGION ENGINEER

December 10 2010
Scott E. Stitt, P.E.
acting ENGINEER OF DESIGN AND ENVIRONMENT

December 10 2010
Christine M. Road
DIRECTOR OF HIGHWAYS, CHIEF ENGINEER



BERNARDIN * LOCHMUELLER & ASSOCIATES, INC.
3 OAK DRIVE
MARYVILLE, ILLINOIS 62062
PHONE (618) 288-4665
FAX (618) 288-4666

PRINTED BY THE AUTHORITY
OF THE STATE OF ILLINOIS