

F.A.P. RTE.	SECTION	COUNTY	TOTAL SHEETS	SHEET NO.
619	70 RS-5 & I	LASALLE	2-14	29
STA. 795+00.00		TO STA. 800+50.00		
FED. ROAD DIST. NO. 3 ILLINOIS FED. AID PROJECT				

PLAN	DATE
BY	
DATE	
REVISIONS	
NO.	
DESCRIPTION	
DATE	
BY	
DATE	

PROFILE	DATE
BY	
DATE	
REVISIONS	
NO.	
DESCRIPTION	
DATE	
BY	
DATE	

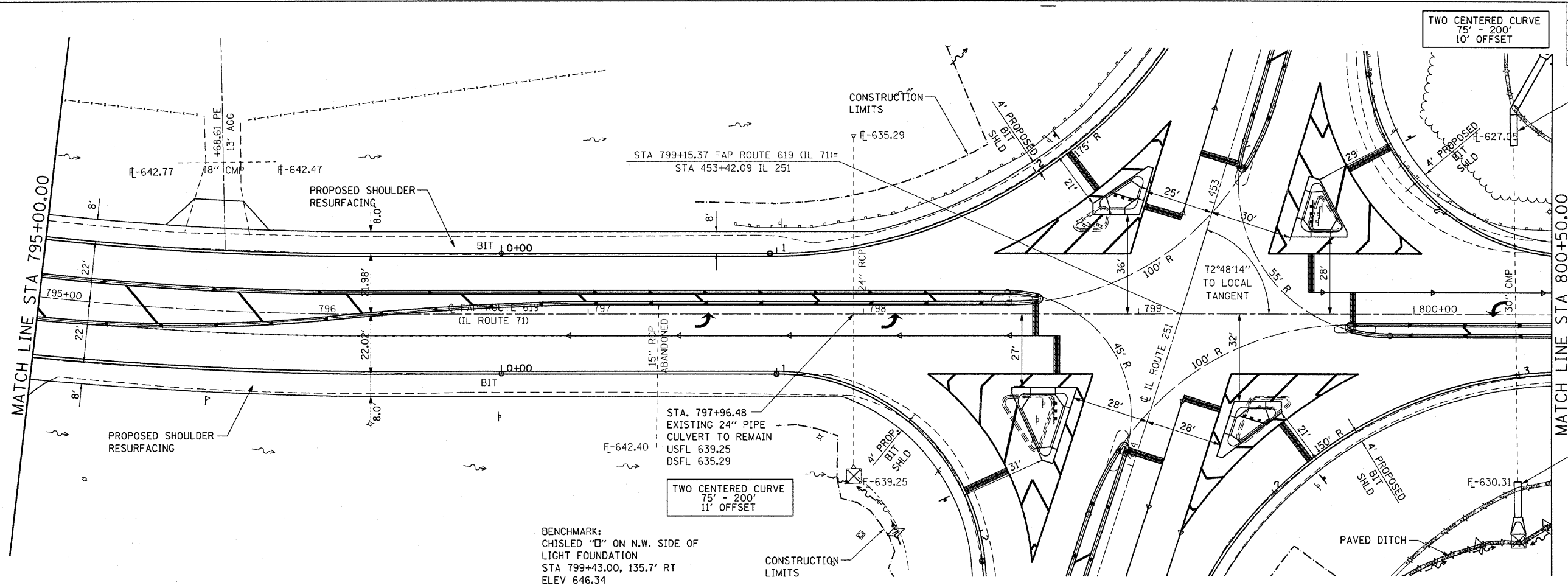

STA 800+36.95, LT  
EXISTING 30" PIPE CULVERT  
TO BE EXTENDED WITH  
PROPOSED PIPE CULVERT,  
CLASS A, TYPE 2, 30" W/  
30° ELBOW  
PRECAST REINFORCED CONCRETE  
FLARED END SECTIONS, 30"  
DSFL 626.46

STA 800+36.95, RT  
EXISTING 30" PIPE CULVERT  
TO BE EXTENDED WITH  
PROPOSED PIPE CULVERT,  
CLASS A, TYPE 2, 30"  
PRECAST REINFORCED CONCRETE  
FLARED END SECTIONS, 30"  
USFL 630.65

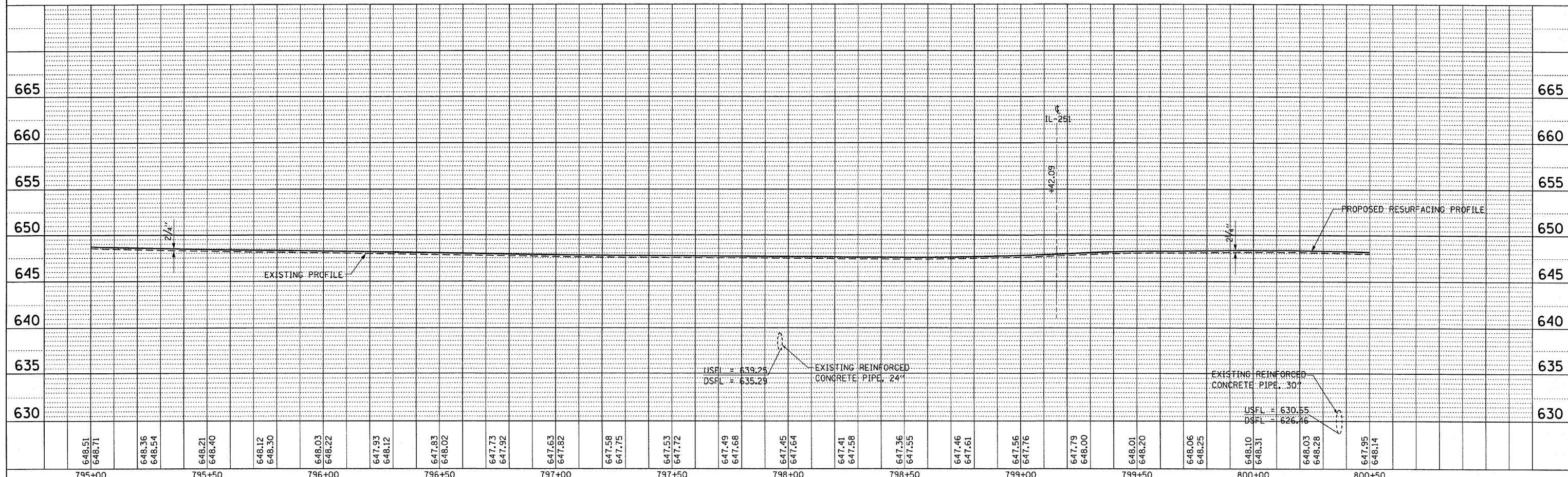
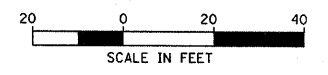

PLAN & PROFILE, FAP ROUTE 619 (IL 71) STA. 795+00.00 TO STA. 800+50.00