

F.A.P. RTE.	SECTION	COUNTY	TOTAL SHEETS	SHEET NO.
619	70 RS-5 & I	LASALLE	214	40
STA. 905+00.00 TO STA. 910+50.00				
FED. ROAD DIST. NO. 3 ILLINOIS FED. AID PROJECT				

FOR DRAINAGE DETAILS
SEE DRAINAGE PLAN AND
DRAINAGE PROFILE SHEETS

FOR INTERSECTION DETAILS
SEE INTERSECTION GEOMETRIC SHEETS

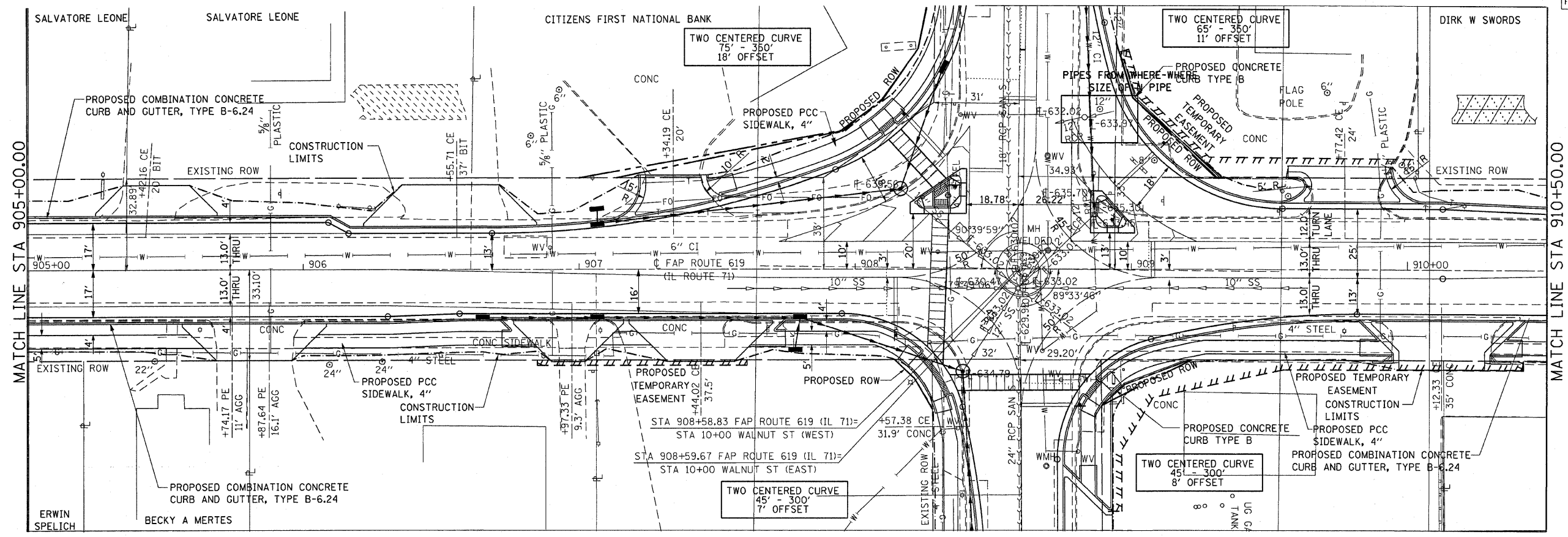

LEGEND

- CONTAMINATED REMOVAL AREA, GREATER THAN 6' DEPTH
 - CONTAMINATED REMOVAL AREA, GREATER THAN 2' DEPTH
 - DETECTABLE WARNINGS
- BENCHMARK:
CHISLED "X" ON S.W. BOLT
CASEY'S SIGN FOUNDATION
STA 908+83.00, 38.1' RT
ELEV 639.34

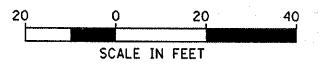

DATE	
BY	
REVISIONS	
NO.	
DESCRIPTION	
DATE	
BY	
NO.	
DESCRIPTION	
DATE	
BY	
NO.	
DESCRIPTION	

DATE	
BY	
REVISIONS	
NO.	
DESCRIPTION	
DATE	
BY	
NO.	
DESCRIPTION	
DATE	
BY	
NO.	
DESCRIPTION	

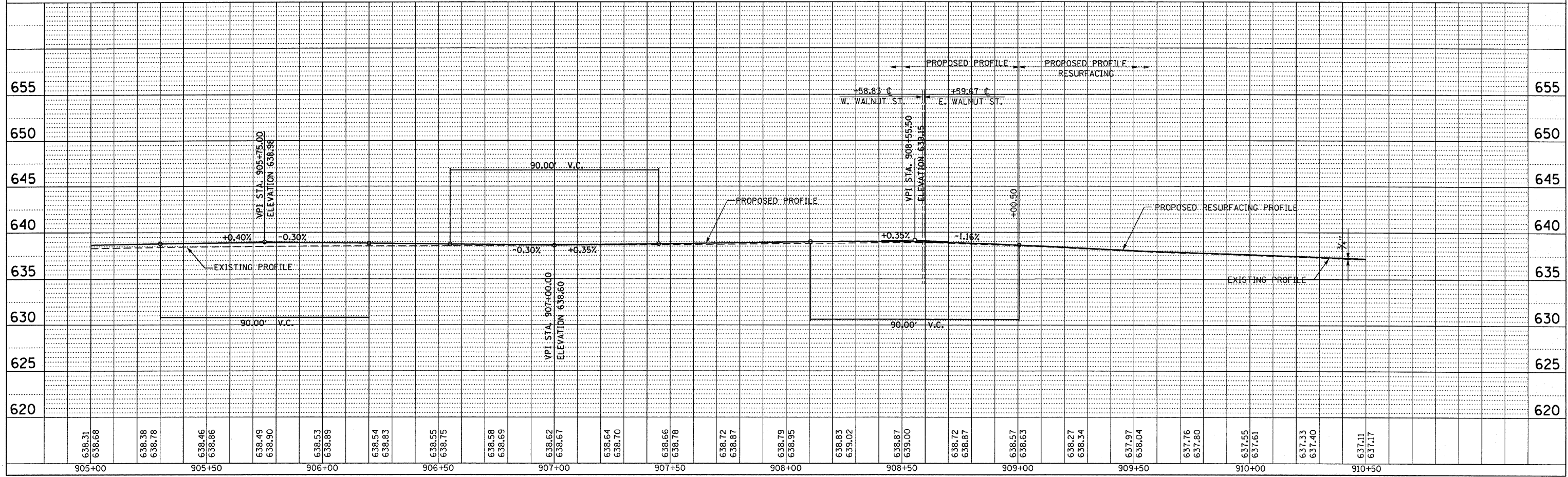

PLAN & PROFILE, FAP ROUTE 619 (IL 71) STA. 905+00.00 TO STA. 910+50.00