

| F.A.P. RTE. | SECTION | COUNTY | TOTAL SHEETS | SHEET NO. |
|---|-------------|-------------------|--------------|-----------|
| 619 | 70 RS-5 & I | LASALLE | 24 | 64 |
| STA. 806+00 | | TO STA. 817+00.00 | | |
| FED. ROAD DIST. NO. 3 ILLINOIS FED. AID PROJECT | | | | |

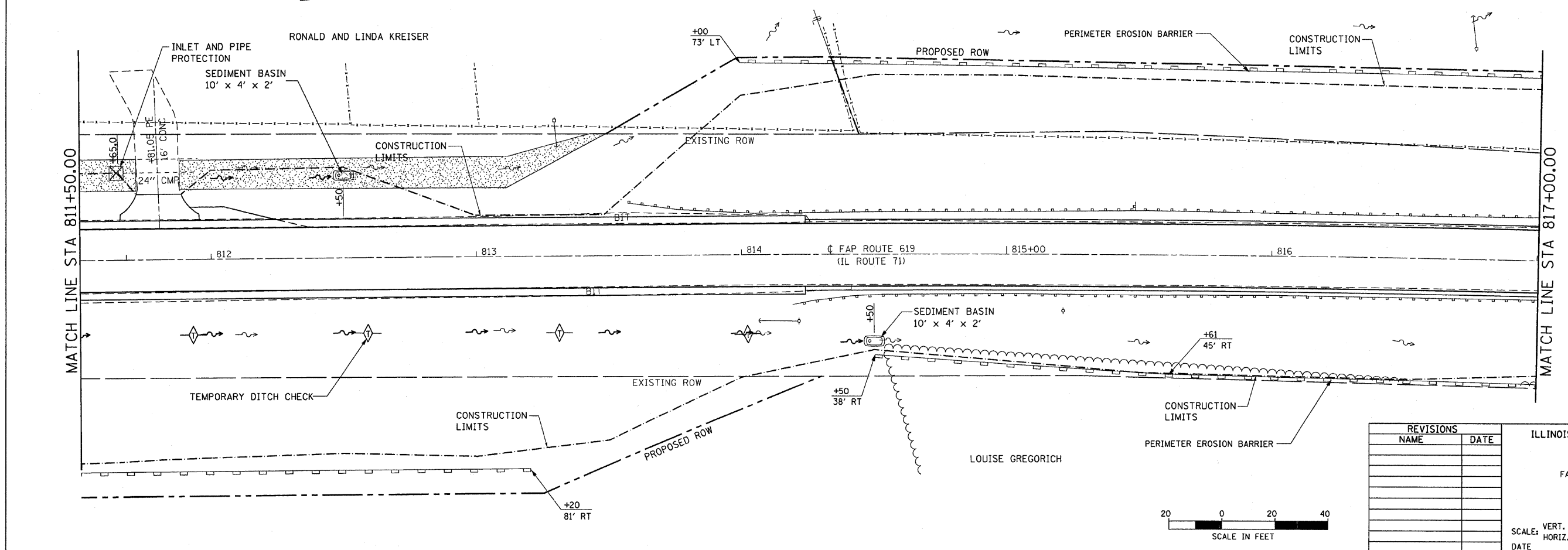
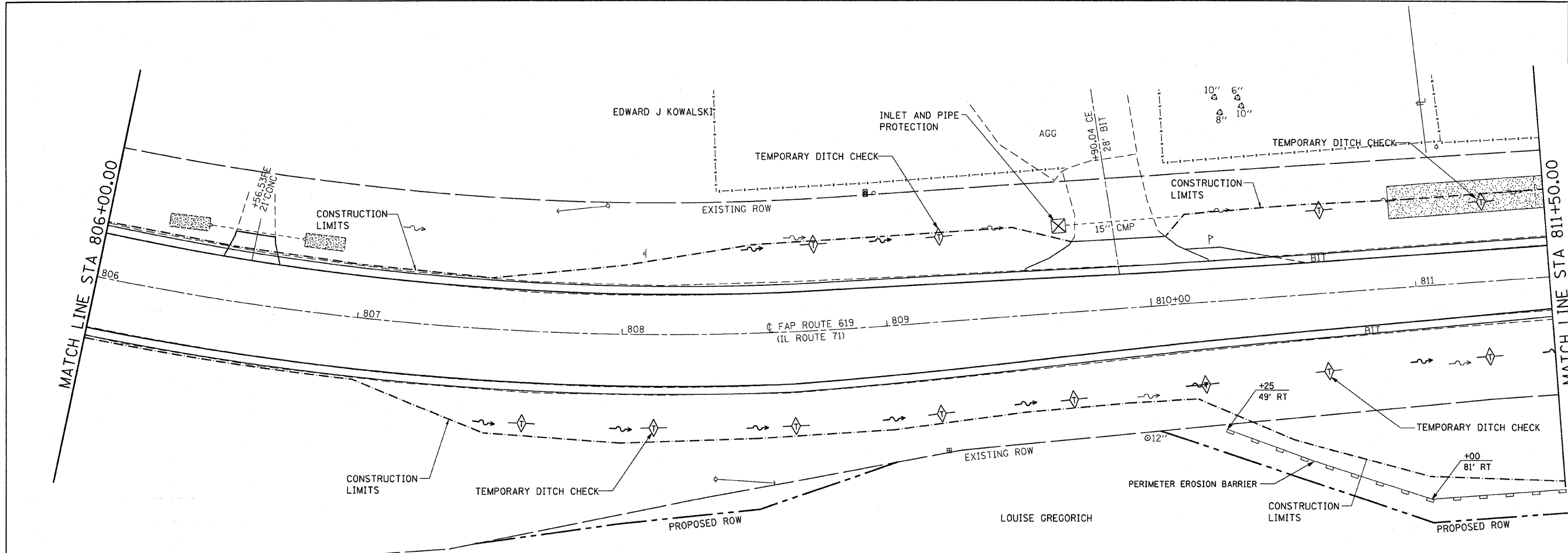

| REVISIONS | |
|-----------|------|
| NAME | DATE |
| | |
| | |
| | |
| | |
| | |
| | |
| | |
| | |
| | |
| | |

ILLINOIS DEPARTMENT OF TRANSPORTATION
EROSION CONTROL
 FAP ROUTE 619 (IL ROUTE 71 / 351)
 SECTION NO. 70 RS-5 & I
 LASALLE COUNTY

SCALE: VERT. _____
 HORIZ. _____
 DATE _____

DRAWN BY BANDY
 CHECKED BY STEUART