

F.A.P. RTE.	SECTION	COUNTY	TOTAL SHEETS	SHEET NO.
619	70 RS-5 & I	LASALLE	214	65
STA. 817+00.00		TO STA. 828+00.00		
FED. ROAD DIST. NO. 3   ILLINOIS   FED. AID PROJECT				

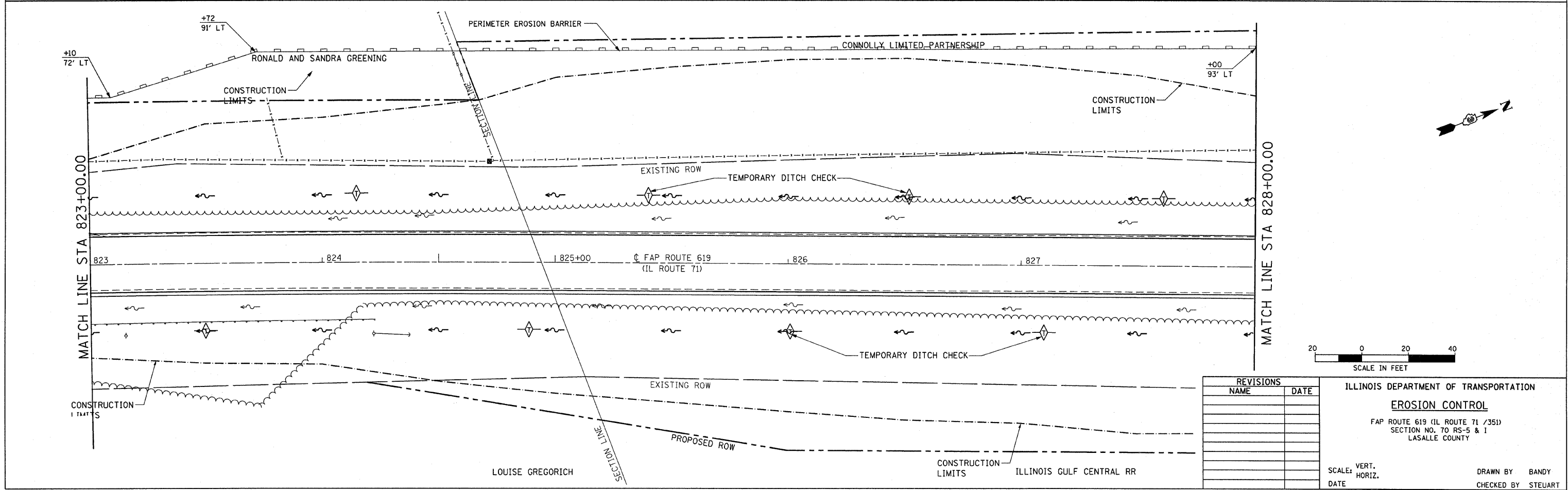
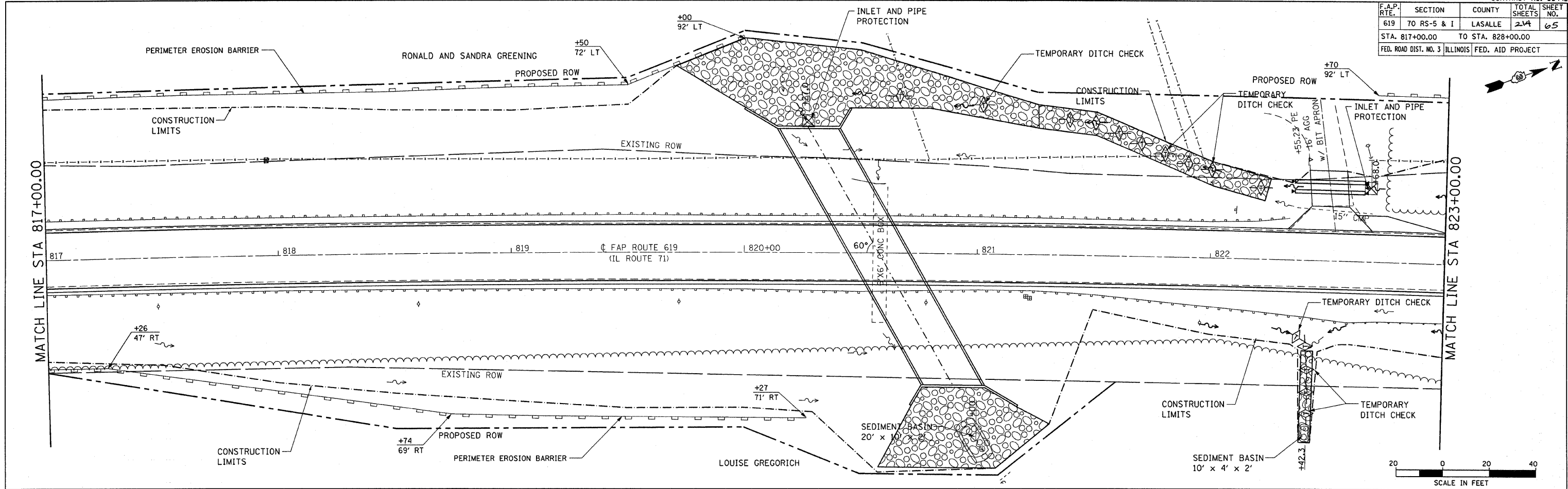

REVISIONS	
NAME	DATE

ILLINOIS DEPARTMENT OF TRANSPORTATION  
**EROSION CONTROL**  
 FAP ROUTE 619 (IL ROUTE 71 / 351)  
 SECTION NO. 70 RS-5 & I  
 LASALLE COUNTY

SCALE: VERT. \_\_\_\_\_  
 HORIZ. \_\_\_\_\_  
 DATE \_\_\_\_\_

DRAWN BY BANDY  
 CHECKED BY STEUART