

F.A.P. RTE.	SECTION	COUNTY	TOTAL SHEETS	SHEET NO.
619	70 RS-5 & I	LASALLE	214	71
STA. 451+59.26		TO STA. 455+51.71		
FED. ROAD DIST. NO. 3 ILLINOIS FED. AID PROJECT				

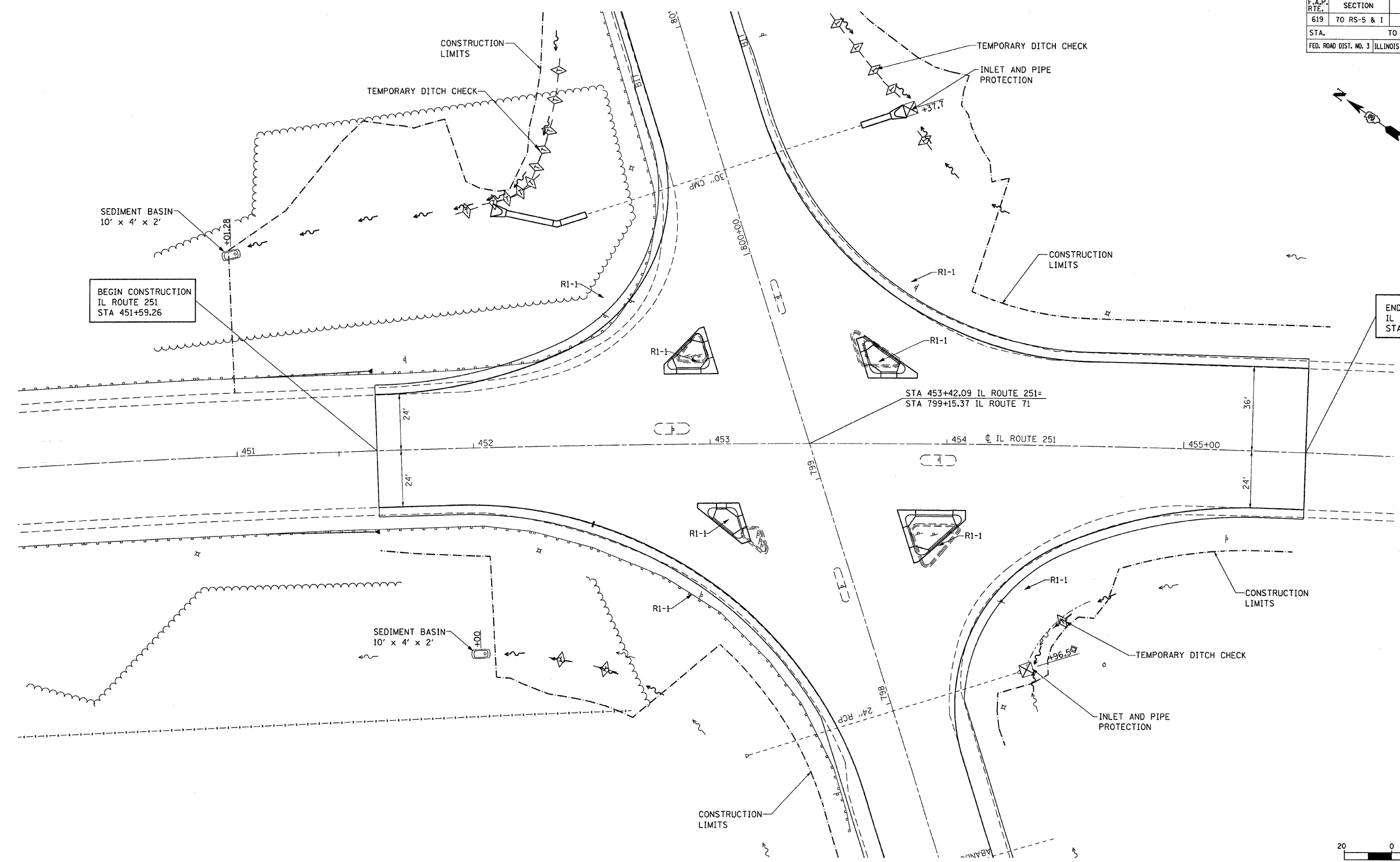

BEGIN CONSTRUCTION
IL ROUTE 251
STA 451+59.26

END CONSTRUCTION
IL ROUTE 251
STA 455+51.71

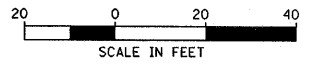

REVISIONS	
NAME	DATE

ILLINOIS DEPARTMENT OF TRANSPORTATION
EROSION CONTROL
FAP ROUTE 619 (IL ROUTE 71 /351)
SECTION NO. 70 RS-5 & I
LASALLE COUNTY

SCALE: VERT. _____
HORIZ. _____
DATE _____
DRAWN BY BANDY
CHECKED BY STEUART