

F.A.P. RTE.	SECTION	COUNTY	TOTAL SHEETS	SHEET NO.
619	70 RS-5 & I	LASALLE	214	15
STA. 7+50.00		TO STA. 13+00.00		
FED. ROAD DIST. NO.	ILLINOIS	FED. AID PROJECT		

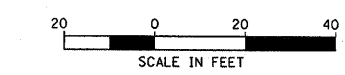
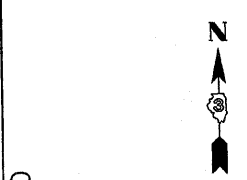
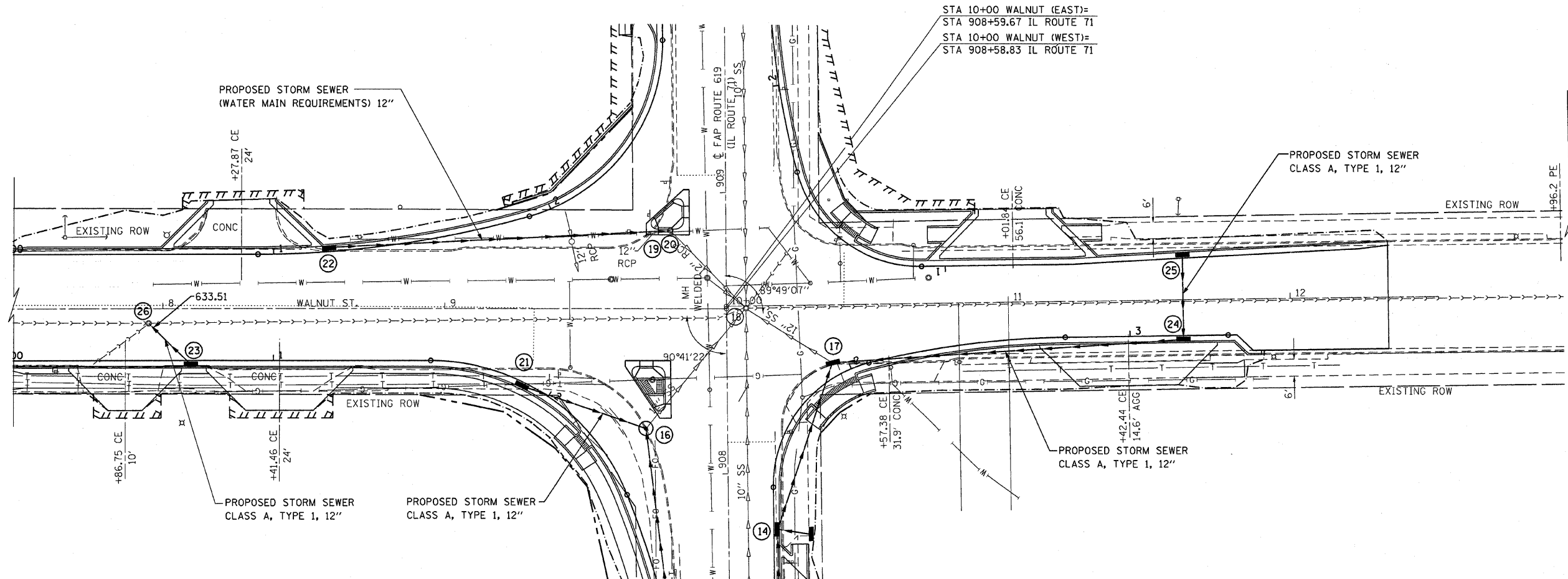

LEGEND

	CONTAMINATED REMOVAL AREA, GREATER THAN 6' DEPTH
	CONTAMINATED REMOVAL AREA, GREATER THAN 2' DEPTH

- | | |
|---|--|
| <p>(21) STA 9+28.00, 27.64' RT
PROPOSED INLET, TYPE A,
WITH TYPE 15 FRAME AND LID
GR. 637.88
FL. 635.90</p> <p>(22) STA 8+59.00, 21.59' LT
PROPOSED INLET, TYPE A,
WITH TYPE 3 FRAME AND GRATE
GR. 637.80
FL. 635.82</p> <p>(23) STA 8+10.00, 20.15' RT
PROPOSED INLET, TYPE A,
WITH TYPE 3 FRAME AND GRATE
GR. 637.60
FL. 635.62</p> | <p>(24) STA 11+62.00, 14.25' RT
PROPOSED INLET, TYPE B,
WITH TYPE 23 FRAME AND GRATE
WITH FLAT TOP SLAB
GR. 637.58
FL. 635.10</p> <p>(25) STA 11+62.00, 16.41' LT
PROPOSED INLET, TYPE A,
WITH TYPE 3 FRAME AND GRATE
GR. 637.54
FL. 635.56</p> <p>(26) STA 7+95.01, 5.28' RT
EXISTING FRAMES AND GRATES
TO BE ADJUSTED
GR. 637.95</p> |
|---|--|

REVISIONS	
NAME	DATE

ILLINOIS DEPARTMENT OF TRANSPORTATION

DRAINAGE PLAN

FAP ROUTE 619 (IL ROUTE 71 /351)
SECTION NO. 70 RS-5 & I
LASALLE COUNTY

SCALE: VERT. _____
HORIZ. _____
DATE _____

DRAWN BY _____
CHECKED BY _____

PLOT DATE = Aug 21, 2010 - 11:25:40 AM
 PLOT SCALE = 20.00000 / IN.
 USER NAME = bergantini,jp