

F.A. RTE.	SECTION	COUNTY	TOTAL SHEETS	SHEET NO.
619	TO RS-5 & I	LASALLE	214	136
STA. 822+42.00		TO STA. 822+70.00		
FED. ROAD DIST. NO.	ILLINOIS	FED. AID PROJECT		

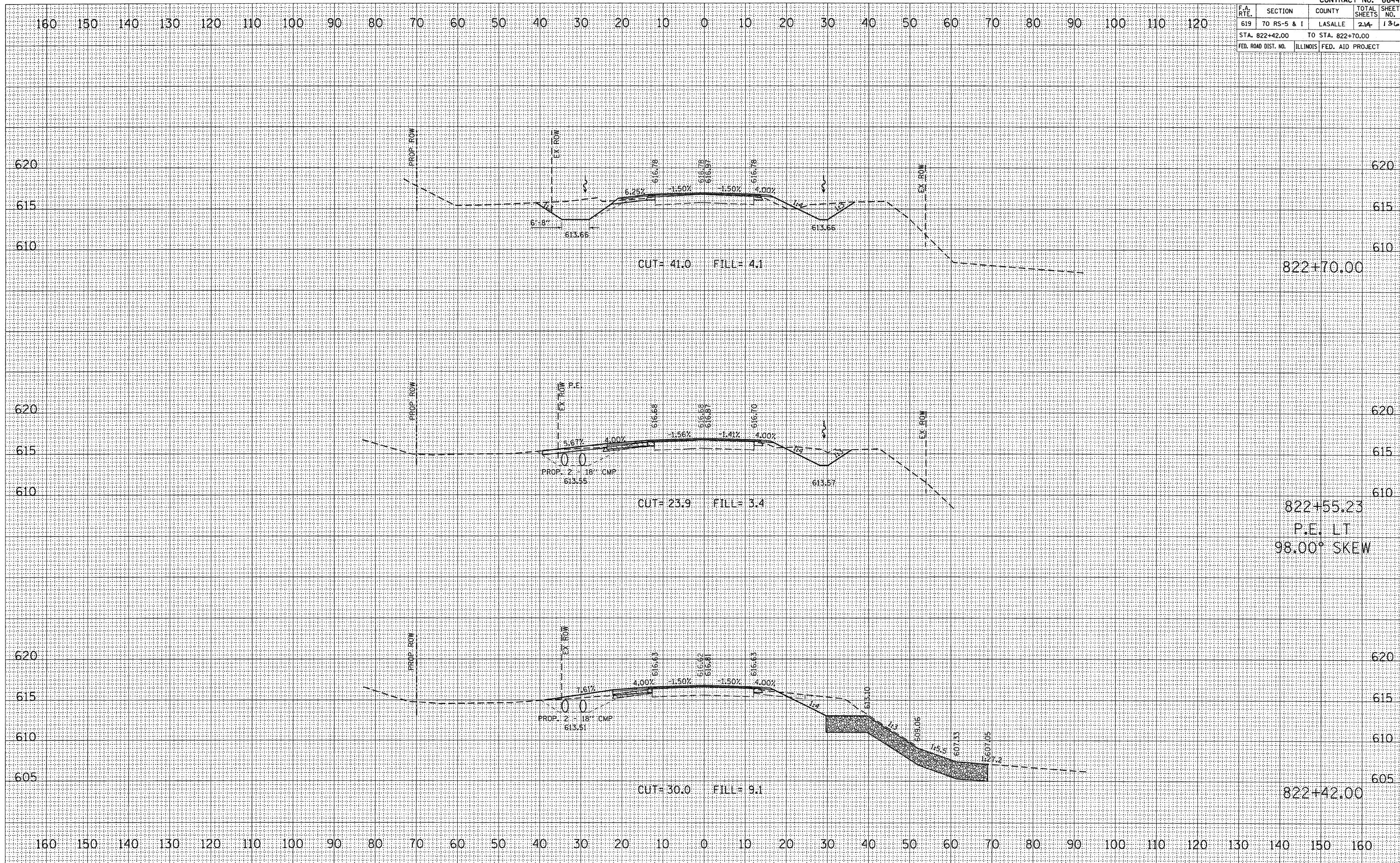

FINAL SURVEY	SUBMITTED	DATE
NO.	NO.	NO.

ORIGINAL SURVEY	SUBMITTED	DATE
NO.	NO.	NO.

PLOT DATE = Aug 24, 2010 - 07:56:28 AM
 FILE NAME = c:\pwork\pudot\bergantino\pudot\822+42.00-70.00.dwg
 USER NAME = bergantino

CROSS SECTION, STA 822+42.00 TO 822+70.00, FAP ROUTE 619 (IL 71)