

F.A. RTE.	SECTION	COUNTY	TOTAL SHEETS	SHEET NO.
619	70 RS-5 & I	LASALLE	24	13
STA. 838+50.00		TO STA. 840+00.00		
FED. ROAD DIST. NO.		ILLINOIS FED. AID PROJECT		

DATE	
BY	
SURVEYED	
PLOTTED	
NOTE BOOK	
AREAS	
AREAS CHECKED	
NO.	

DATE	
BY	
SURVEYED	
PLOTTED	
NOTE BOOK	
AREAS	
AREAS CHECKED	
NO.	

PLOT DATE = Aug 24, 2010 - 07:46:08 AM
 FILE NAME = c:\pva\work\varides\berngantunje\berngantunje.dwg
 PLOT SCALE = 1/8" = 1' IN.
 USER NAME = berngantunje

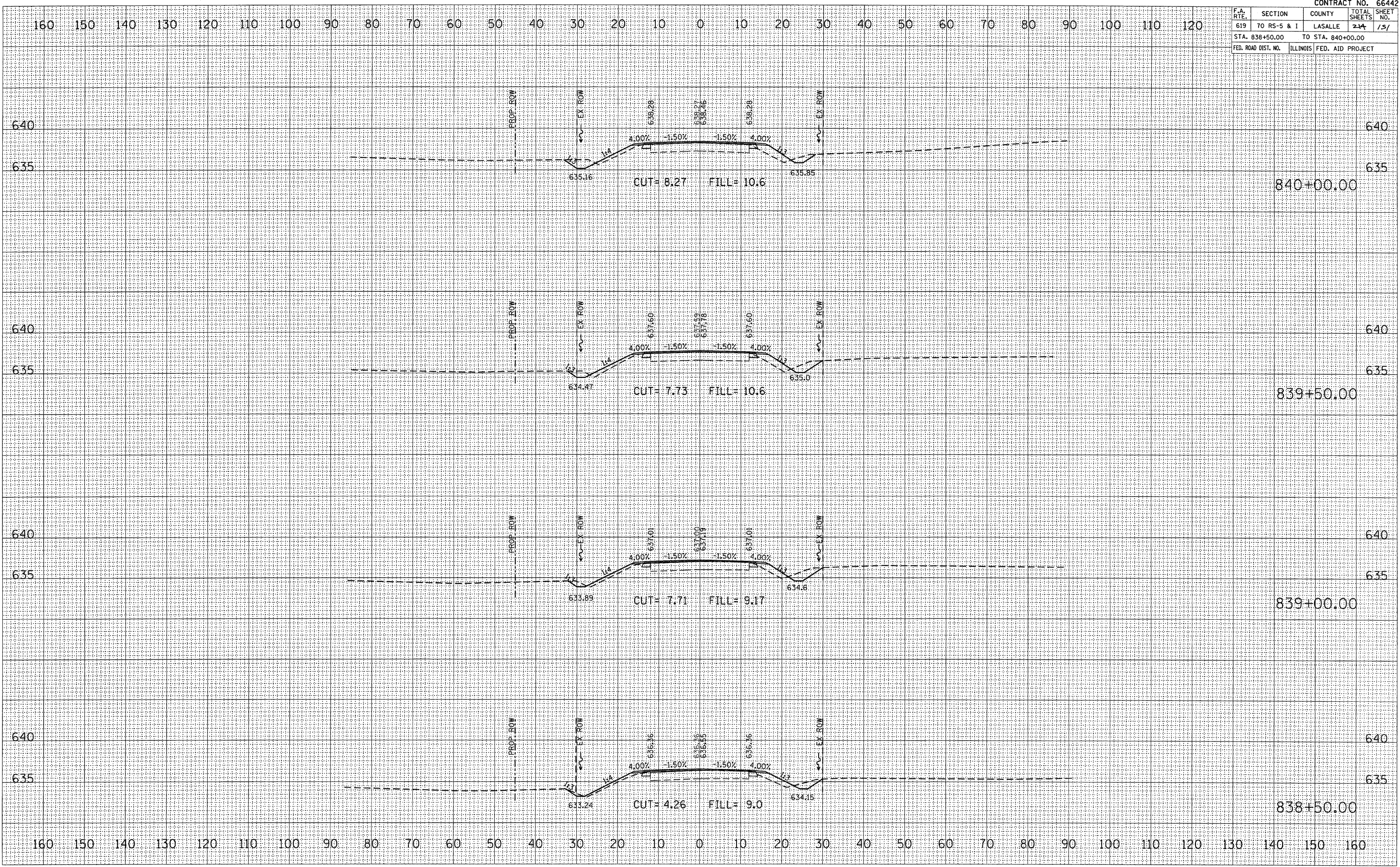

CROSS SECTION, STA 838+50.00 TO 840+00.00, FAP ROUTE 619 (IL 71)