

F.A. RTE.	SECTION	COUNTY	TOTAL SHEETS	SHEET NO.
619	TO RS-5 & I	LASALLE	215	156
STA. 874+00.00		TO STA. 874+65.00		
FED. ROAD DIST. NO.	ILLINOIS	FED. AID PROJECT		

FINAL SURVEY	DATE
SURVEYED	
PLOTTED	
NOTE BOOK	
AREAS CHECKED	
NO.	

ORIGINAL SURVEY	DATE
SURVEYED	
PLOTTED	
NOTE BOOK	
AREAS CHECKED	
NO.	

PLOT DATE = Aug 23, 2016 - 8:42:28 PM  
 FILE NAME = c:\pwworkspace\lberington\pwworkspace\874+00-874+65.dwg  
 USER NAME = lberington

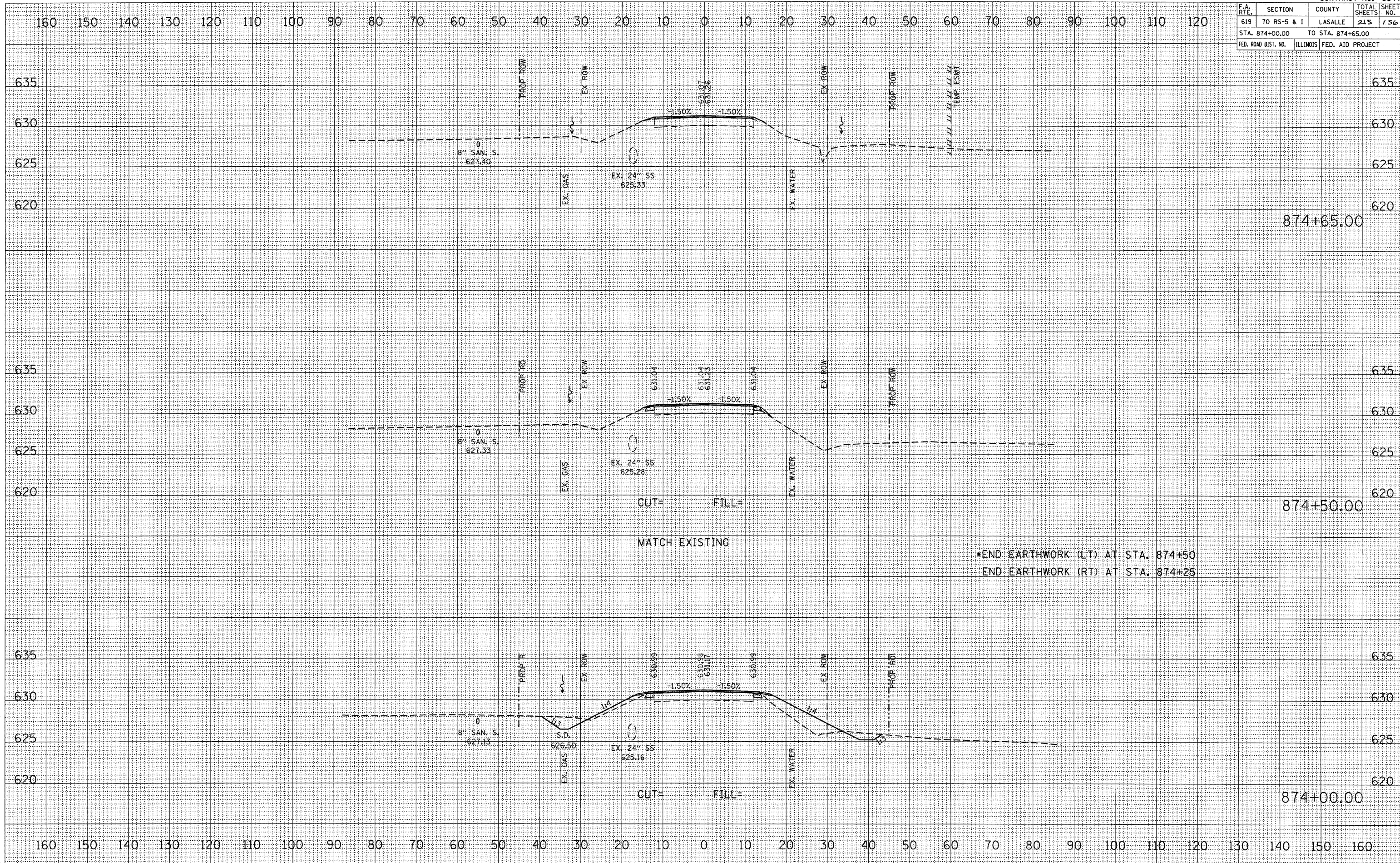

CROSS SECTION, STA 874+00.00 TO 874+65.00, FAP ROUTE 619 (IL 71)