

F.A. RTE.	SECTION	COUNTY	TOTAL SHEETS	SHEET NO.
619	70 RS-5 & I	LASALLE	214	159
STA. 900+72.63		TO STA. 901+00.00		
FED. ROAD DIST. NO.	ILLINOIS	FED. AID PROJECT		

FINAL SURVEY NO.	SUBMITTED DATE	BY	DATE

ORIGINAL SURVEY NO.	SUBMITTED DATE	BY	DATE

PLOT DATE = Aug 23, 2018 - 04:24:24 PM  
 FILE NAME = c:\pwork\pudot\bergantunup\img\9007263.dwg  
 USER NAME = bergantunup

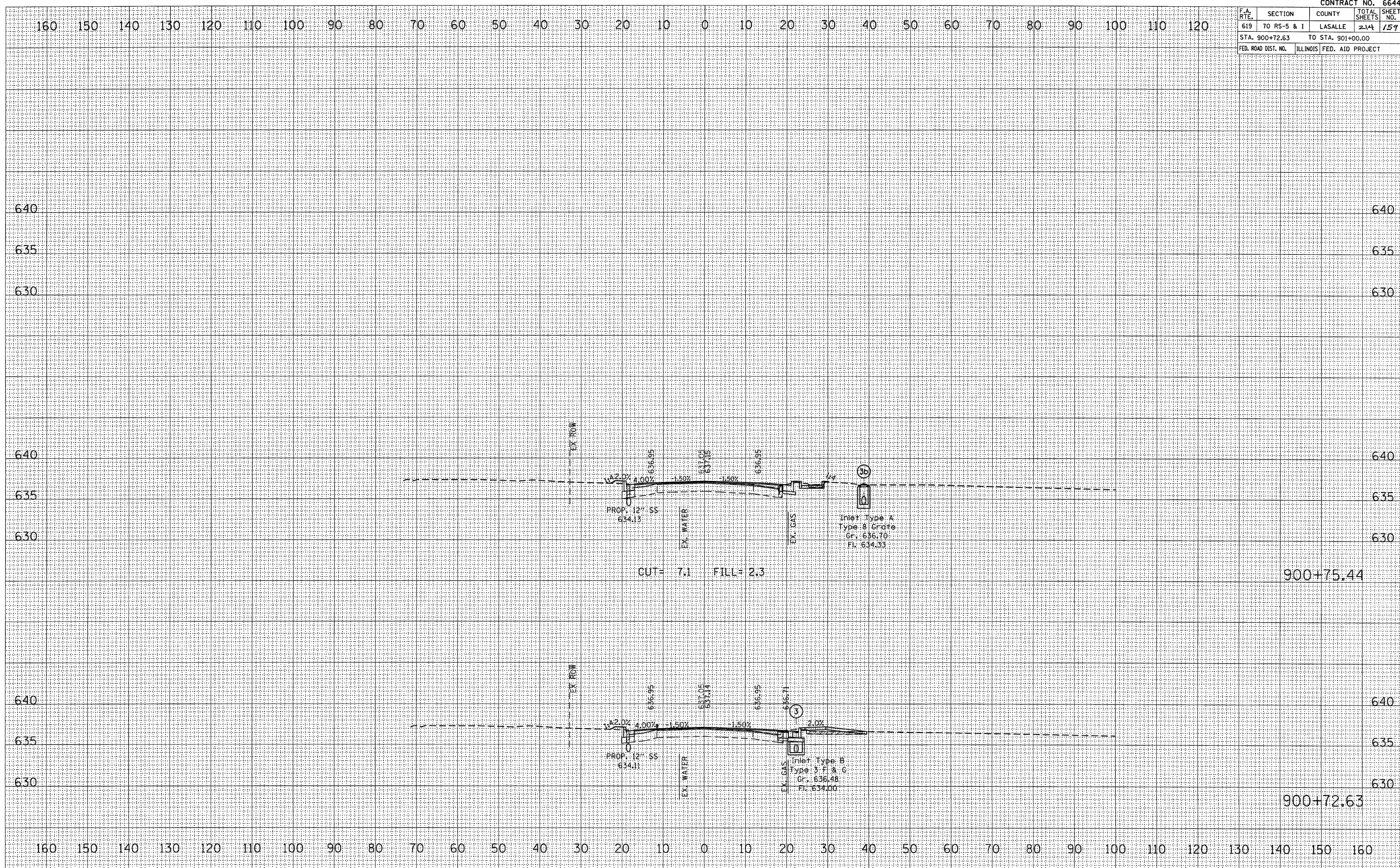

CROSS SECTION, STA 900+72.63 TO 901+00.00, FAP ROUTE 619 (IL 71)