

F.A. RTE.	SECTION	COUNTY	TOTAL SHEETS	SHEET NO.
619	70 RS-5 & I	LASALLE	214	164
STA. 903+27.98		TO STA. 903+68.46		
FED. ROAD DIST. NO.	ILLINOIS	FED. AID PROJECT		

DATE	BY

NO.	AREAS CHECKED

NO.	AREAS CHECKED

DATE	BY

NO.	AREAS CHECKED

NO.	AREAS CHECKED

PLOT DATE = Aug 23, 2010 - 04:18:04 PM
FILE NAME = c:\pva\work\pva\rd\66442\pva\pva\903+27.98.dwg
USER = berganturco, jr
USER NAME = berganturco, jr

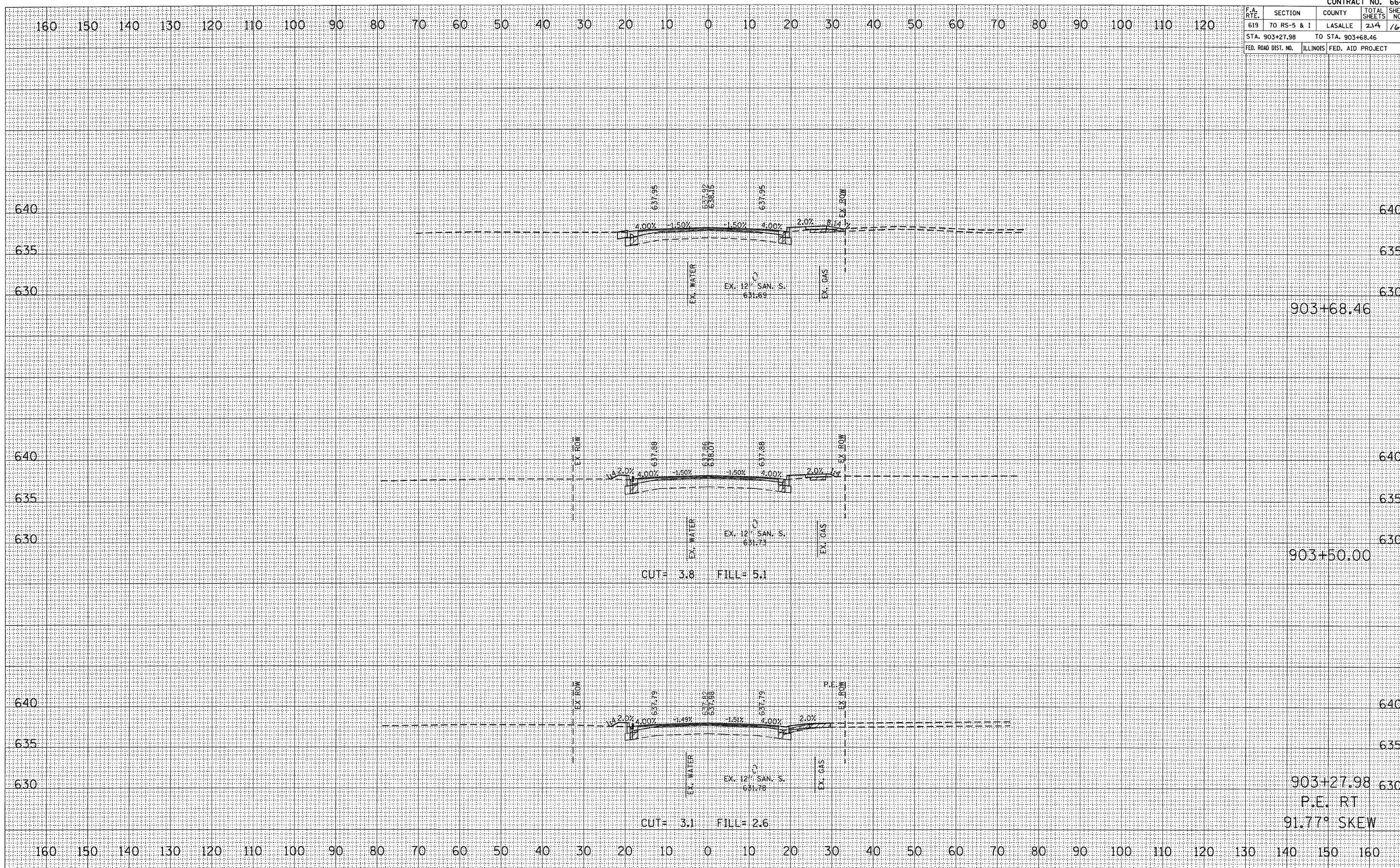

CROSS SECTION, STA 903+27.98 TO 903+68.46, FAP ROUTE 619 (IL 71)