

| F.A. RTE. | SECTION | COUNTY | TOTAL SHEETS | SHEET NO. |
|---------------------|-------------|-------------------|--------------|-----------|
| 619 | 70 RS-5 & I | LASALLE | 214 | 165 |
| STA. 903+88.36 | | TO STA. 904+35.47 | | |
| FED. ROAD DIST. NO. | ILLINOIS | FED. AID PROJECT | | |

| | | | |
|--------------|---------------|----|------|
| FINAL SURVEY | SURVEYED | BY | DATE |
| NOTE BOOK | PLOTTED | | |
| NO. | TEMPLATE | | |
| | AREAS CHECKED | | |

| | | | |
|-----------------|---------------|----|------|
| ORIGINAL SURVEY | SURVEYED | BY | DATE |
| FILE NAME | PLOTTED | | |
| USER NAME | AREAS CHECKED | | |
| | | | |

PLOT DATE = Aug 23, 2018 - 04:17:53 PM
 FILE NAME = c:\p-work\panda\lber-gentrino\panda\903+88.36-904+35.47.dwg
 USER NAME = bergentrino

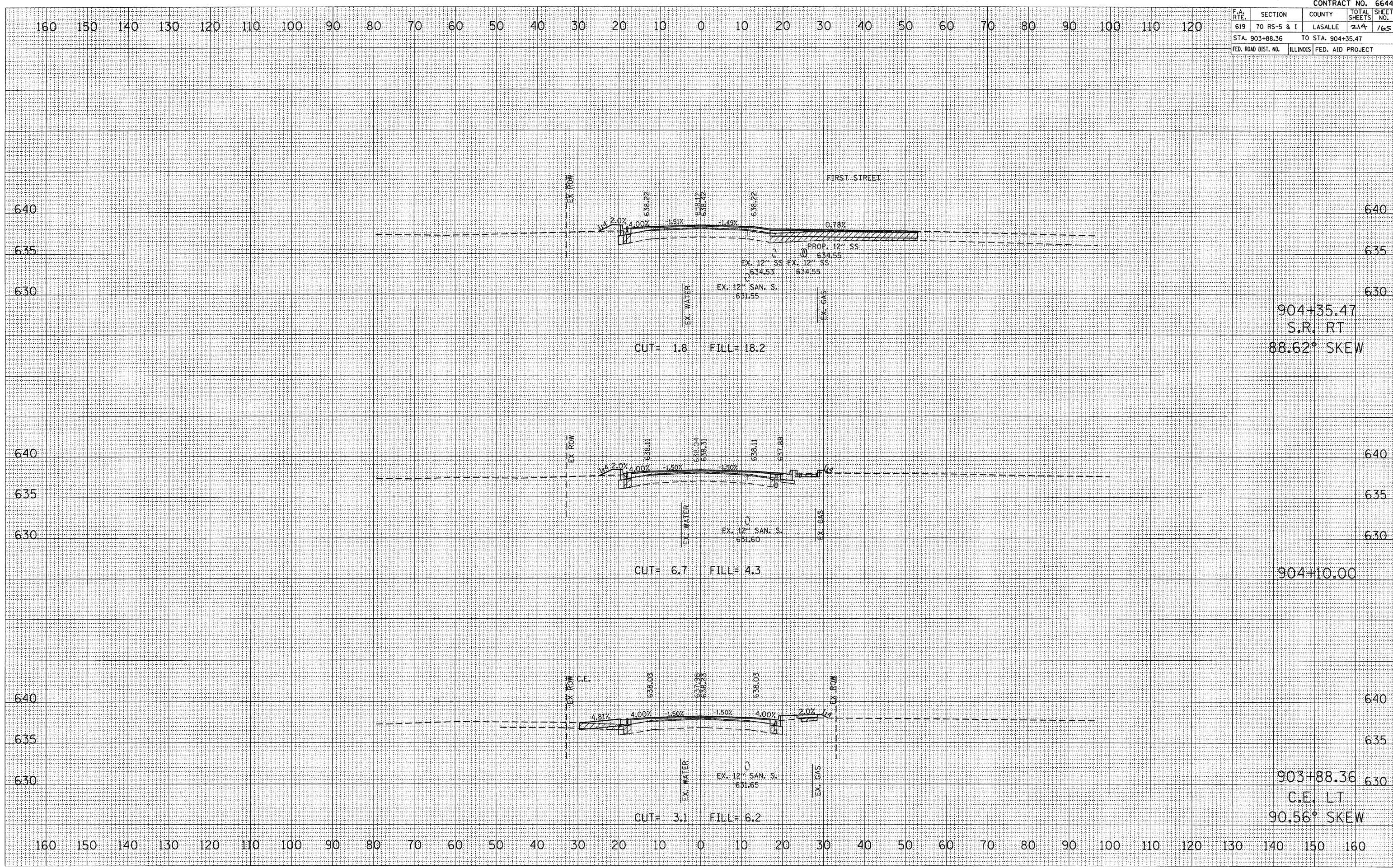

CROSS SECTION, STA 903+88.36 TO 904+35.47, FAP ROUTE 619 (IL 71)