

F.A. RTE.	SECTION	COUNTY	TOTAL SHEETS	SHEET NO.
619	70 RS-5 & I	LASALLE	214	172
STA. 907+70.00		TO STA. 908+16.51		
FED. ROAD DIST. NO.	ILLINOIS	FED. AID PROJECT		

DATE	
BY	
FINAL SURVEY	SURVEYED
NOTE BOOK	PLOTTED
NO.	TEMPLATE
	AREAS
	CHECKED

DATE	
BY	
ORIGINAL SURVEY	SURVEYED
FILE NAME	PLOTTED
NO.	TEMPLATE
	AREAS
	CHECKED

PLOT DATE = Aug 23, 2016 - 04:05:37 PM
 FILE NAME = c:\work\proj\dot\lbr\gentino\je\66442\172.dwg
 USER NAME = bergantino,je

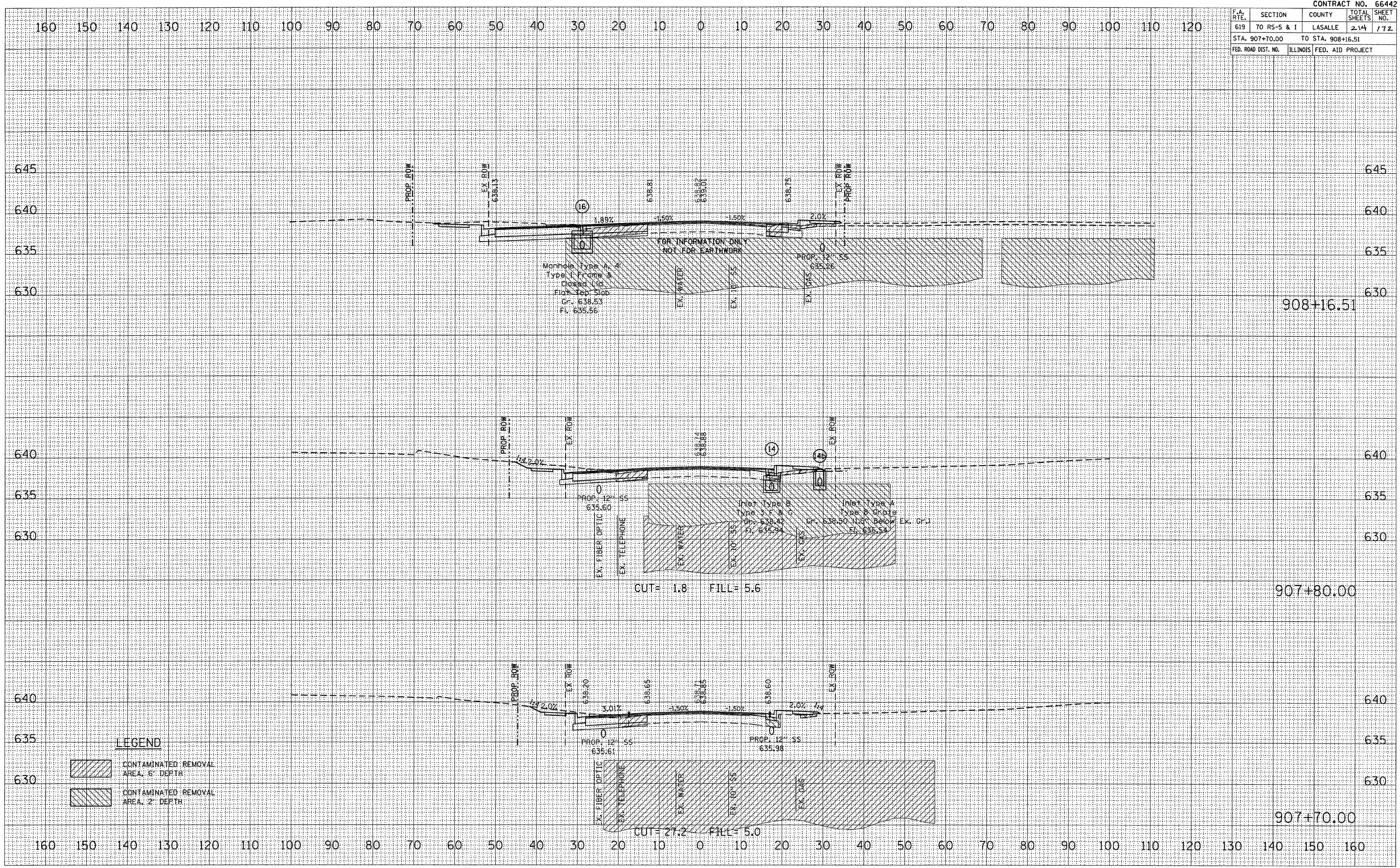

CROSS SECTION, STA 907+70.00 TO 908+16.51, FAP ROUTE 619 (IL 71)